

FINAL SURVEY	DATE
NO. _____	BY _____
NO. _____	DATE _____
NO. _____	BY _____
NO. _____	DATE _____
NO. _____	BY _____
NO. _____	DATE _____
NO. _____	BY _____
NO. _____	DATE _____
NO. _____	BY _____
NO. _____	DATE _____

ORIGINAL SURVEY	DATE
NO. _____	BY _____
NO. _____	DATE _____
NO. _____	BY _____
NO. _____	DATE _____
NO. _____	BY _____
NO. _____	DATE _____
NO. _____	BY _____
NO. _____	DATE _____
NO. _____	BY _____
NO. _____	DATE _____

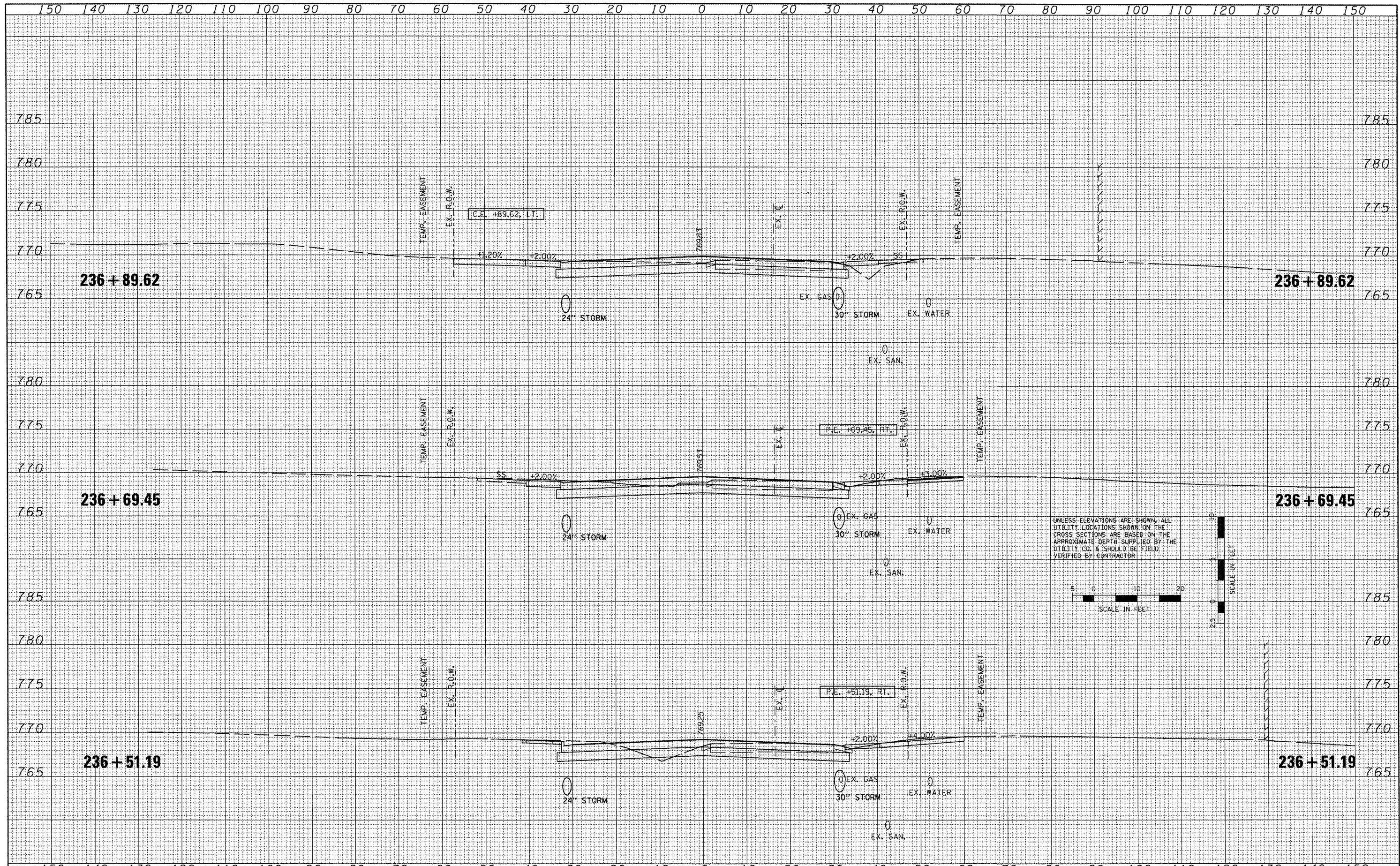

UNLESS ELEVATIONS ARE SHOWN, ALL UTILITY LOCATIONS SHOWN ON THE CROSS SECTIONS ARE BASED ON THE APPROXIMATE DEPTH SUPPLIED BY THE UTILITY CO. & SHOULD BE FIELD VERIFIED BY CONTRACTOR



FILE NAME: x:\projects\200803566\dgn\gk\X5-IL-RT8-sheets.dgn

USER NAME = IDOT	DESIGNED -	REVISED -
	DRAWN -	REVISED -
PLOT SCALE = 20.7420' / IN.	CHECKED -	REVISED -
PLOT DATE = 10/21/2011	DATE = 10-21-11	REVISED -

STATE OF ILLINOIS
DEPARTMENT OF TRANSPORTATION

FAP 399 (IL RTE. 8)
CROSS SECTIONS

SCALE: SHEET NO. OF SHEETS STA. 236+51.19 TO STA. 236+89.62

F.A.P. RTE. 399	SECTION 36 R-7	COUNTY TAZEWELL	TOTAL SHEETS 390	SHEET NO. 343
			CONTRACT NO. 68370	
ILLINOIS FED. AID PROJECT				