

DATE	
BY	
FINISHED	
DATE	
NO.	

DATE	
BY	
FINISHED	
DATE	
NO.	

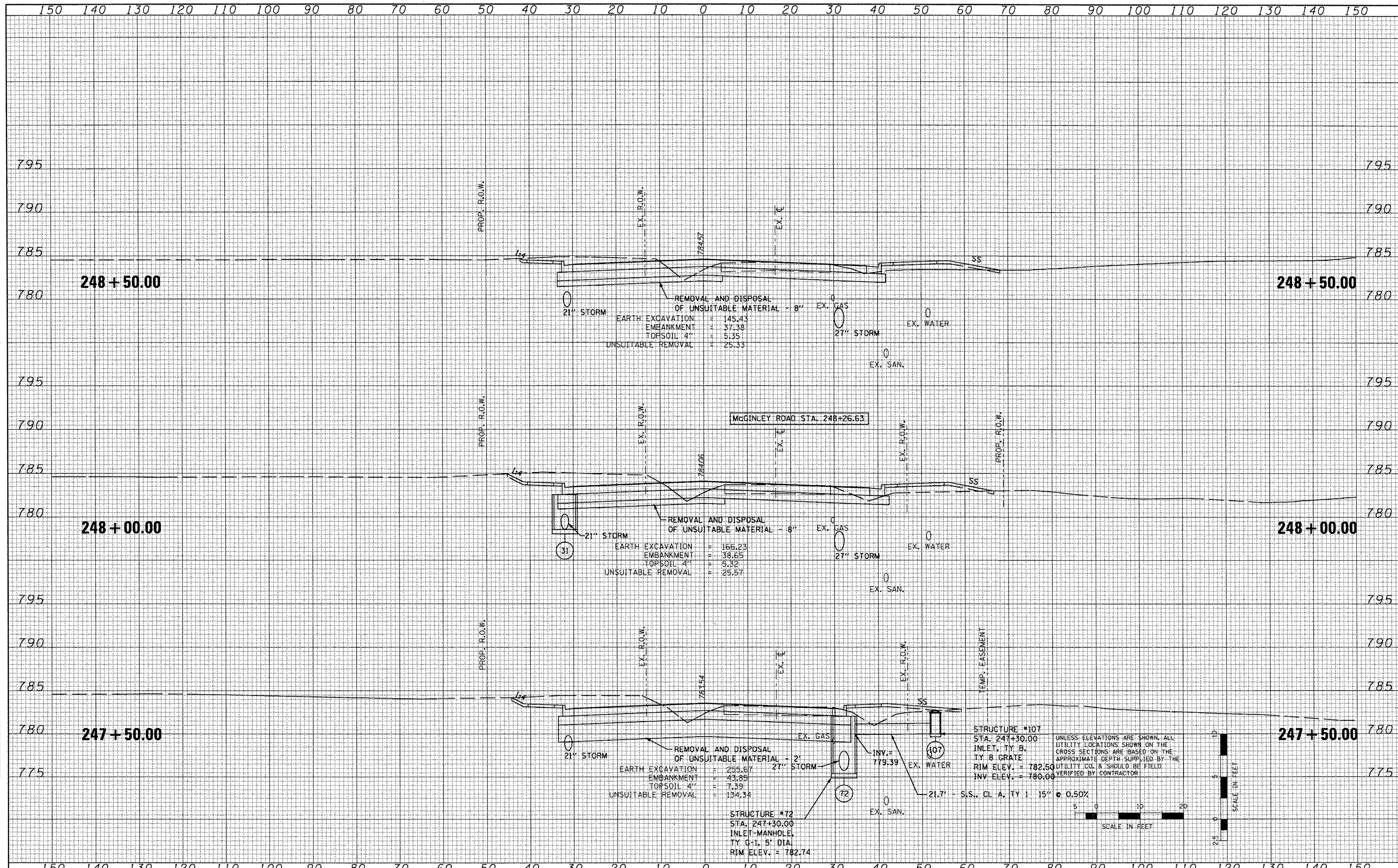

FILE NAME =	USER NAME = 1001	DESIGNED -	REVISED -	<b>STATE OF ILLINOIS DEPARTMENT OF TRANSPORTATION</b>	<b>FAP 399 (IL RTE. 8) CROSS SECTIONS</b>	F.A.P. RTE. 399	SECTION 36 R-7	COUNTY TAZEWELL	TOTAL SHEETS 390	SHEET NO. 357	
x:\projects\200803566\dgn\gpk\XS-IL-R78-sheets.dgn	PLOT SCALE = 20.7420 / IN.	DRAWN -	REVISED -			SCALE:	SHEET NO. OF SHEETS	STA. 247+50.00 TO STA. 248+50.00	CONTRACT NO. 68370		ILLINOIS FED. AID PROJECT
	PLOT DATE = 10/21/2011	CHECKED -	REVISED -								
		DATE = 10-21-11	REVISED -								