

| | |
|----------------|--|
| DATE | |
| BY | |
| FINAL SURVEY | |
| SURVEY PLOTTED | |
| NOTE BOOK | |
| AREAS CHECKED | |

| | |
|-----------------|--|
| DATE | |
| BY | |
| ORIGINAL SURVEY | |
| SURVEY PLOTTED | |
| NOTE BOOK | |
| AREAS CHECKED | |

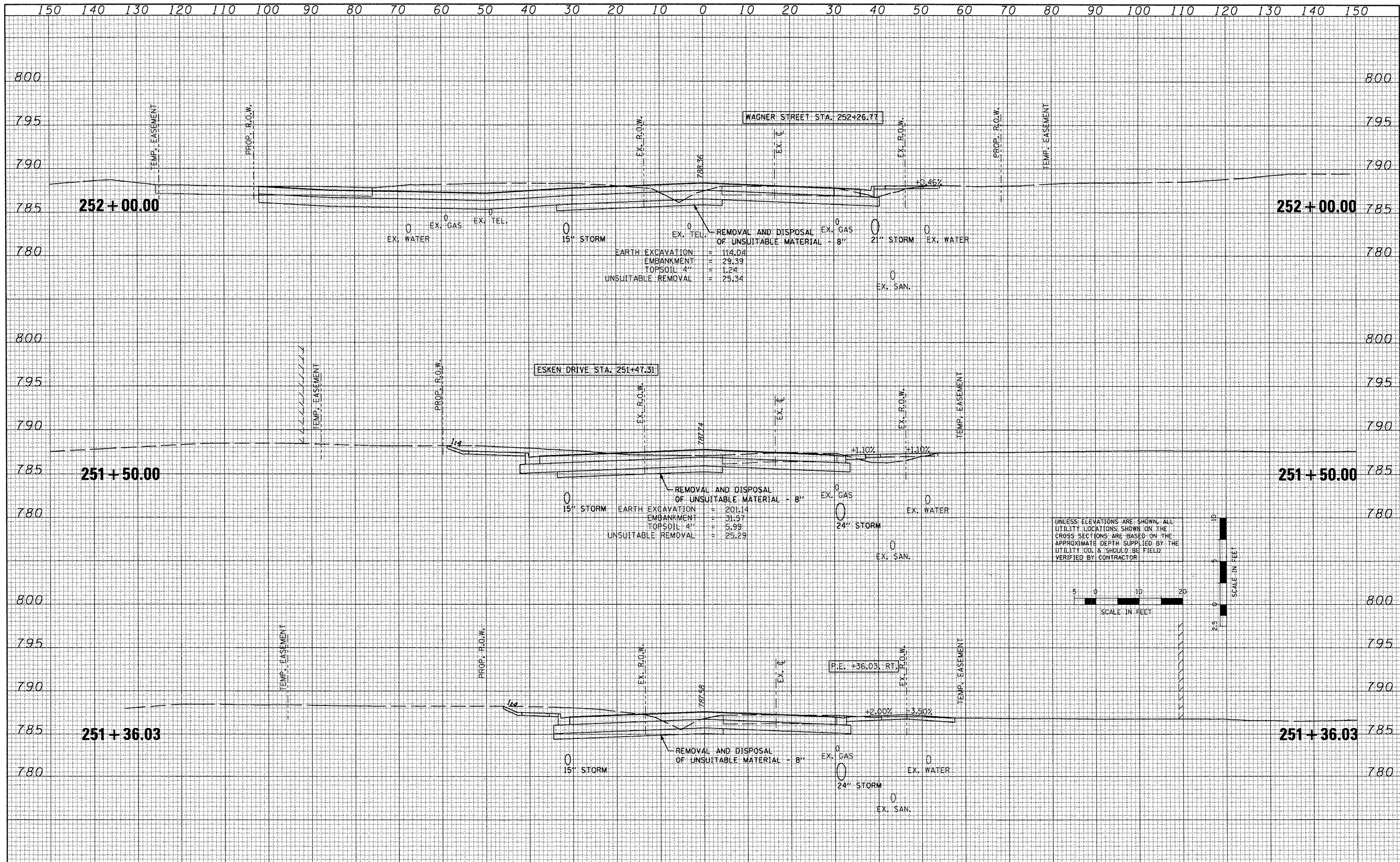

| | | | | | | | | | | |
|--|------------------|-----------------|-----------|---|---|-----------------|---------------------------|----------|--------------|-----------|
| FILE NAME = | USER NAME = IDOT | DESIGNED - | REVISED - | STATE OF ILLINOIS DEPARTMENT OF TRANSPORTATION | FAP 399 (IL RTE. 8) CROSS SECTIONS | F.A.P. RTE. 399 | SECTION | COUNTY | TOTAL SHEETS | SHEET NO. |
| W:\projects\200803566\dgn\gpk\X5-IL-R18-sheets.dgn | | DRAWN - | REVISED - | | | | 36 R-7 | TAZEWELL | 390 | 361 |
| PLOT SCALE = 20.7420" / IN. | | CHECKED - | REVISED - | | | | CONTRACT NO. 68370 | | | |
| PLOT DATE = 10/21/2011 | | DATE = 10-21-11 | REVISED - | | | | ILLINOIS FED. AID PROJECT | | | |