

FINAL SURVEY	BY	DATE
NO. _____		
PLANNED		
REVISION		
NOTE BOOK		
NO. _____		
PLANNED		
REVISION		
NOTE BOOK		
NO. _____		
PLANNED		
REVISION		
NOTE BOOK		
NO. _____		

ORIGINAL SURVEY	BY	DATE
NO. _____		
PLANNED		
REVISION		
NOTE BOOK		
NO. _____		
PLANNED		
REVISION		
NOTE BOOK		
NO. _____		

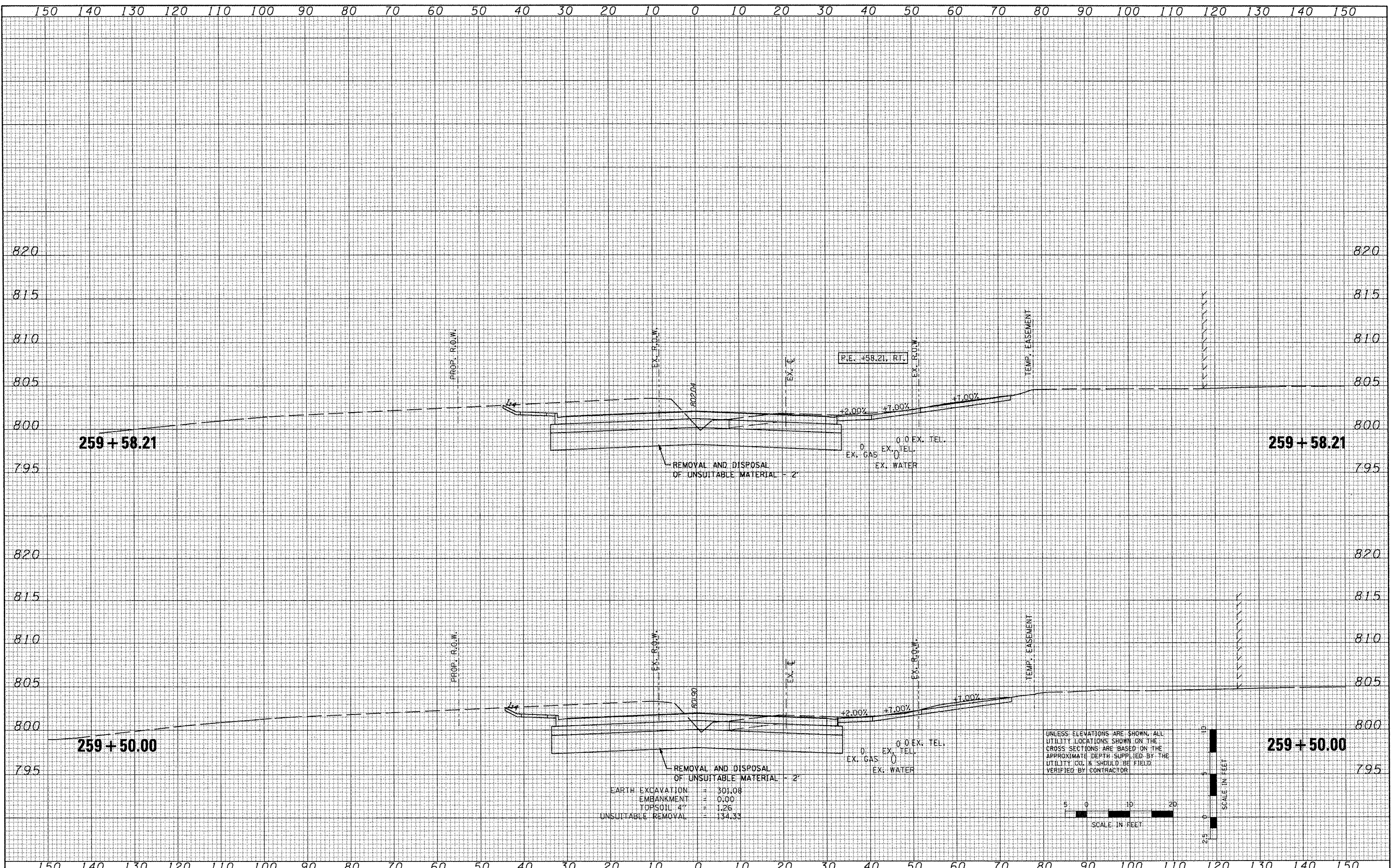

EARTH EXCAVATION	=	301.08
EMBANKMENT	=	0.00
TOPSOIL 4"	=	1.26
UNSUITABLE REMOVAL	=	134.33

UNLESS ELEVATIONS ARE SHOWN, ALL UTILITY LOCATIONS SHOWN ON THE CROSS SECTIONS ARE BASED ON THE APPROXIMATE DEPTH SUPPLIED BY THE UTILITY CO. & SHOULD BE FIELD VERIFIED BY CONTRACTOR



SCALE IN FEET

FILE NAME =	USER NAME = IDOT	DESIGNED -	REVISED -	<b>STATE OF ILLINOIS DEPARTMENT OF TRANSPORTATION</b>	<b>FAP 399 (IL RTE. 8) CROSS SECTIONS</b>	F.A.P. RTE.	SECTION	COUNTY	TOTAL SHEETS	SHEET NO.	
\\projects\200803566\dgn\gpk\XS-IL-RT8-sheets.dgn		DRAWN -	REVISED -			399	36 R-7	TAZEWELL	390	369	
PLOT SCALE = 20.7420" / IN.		CHECKED -	REVISED -			SCALE: SHEET NO. OF SHEETS STA. 259+50.00 TO STA. 259+58.21					
PLOT DATE = 10/21/2011		DATE = 10-21-11	REVISED -			CONTRACT NO. 68370					
ILLINOIS FED. AID PROJECT											