

DATE	
BY	
DESIGNED	
DRAWN	
CHECKED	
DATE	

DATE	
BY	
DESIGNED	
DRAWN	
CHECKED	
DATE	

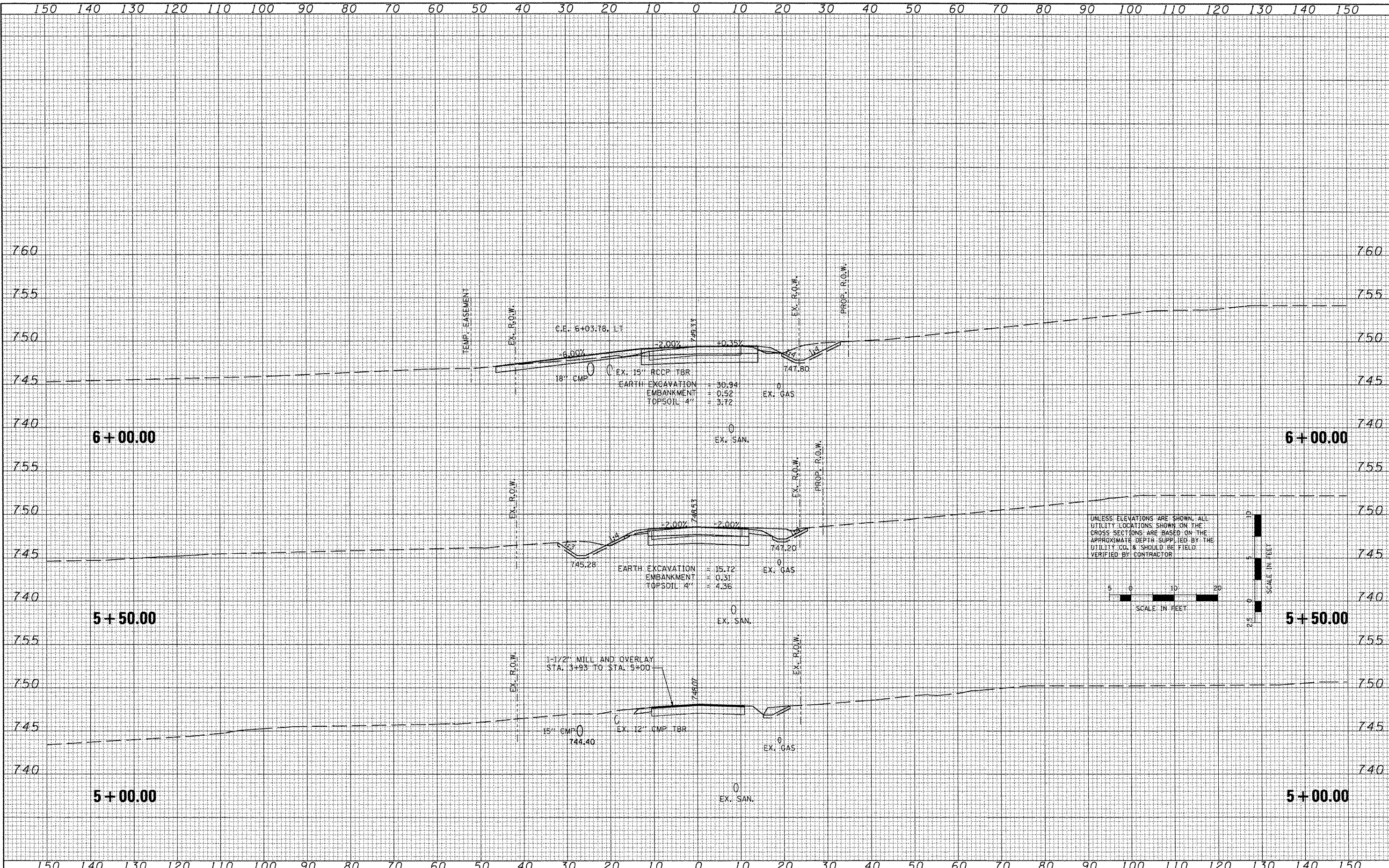

UNLESS ELEVATIONS ARE SHOWN, ALL UTILITY LOCATIONS SHOWN ON THE CROSS SECTIONS ARE BASED ON THE APPROXIMATE DEPTHS SUPPLIED BY THE UTILITY CO. & SHOULD BE FIELD VERIFIED BY CONTRACTOR

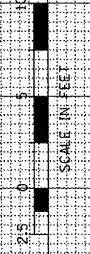
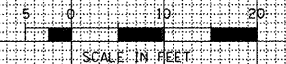

FILE NAME = \\proj\proj\200803566\dgn\gpk\X5-School2-SHEE  
 USER NAME = IOOT  
 S.dgn  
 PLOT SCALE = 20.7420' / IN.  
 PLOT DATE = 10/21/2011

DESIGNED -	REVISED -
DRAWN -	REVISED -
CHECKED -	REVISED -
DATE -	REVISED -

STATE OF ILLINOIS  
 DEPARTMENT OF TRANSPORTATION

SCHOOL STREET  
 CROSS SECTIONS

SCALE: SHEET NO. OF SHEETS STA. 5+00.00 TO STA. 6+00.00

F.A.P. RTE. 399	SECTION 36 R-7	COUNTY TAZEWELL	TOTAL SHEETS 390	SHEET NO. 379
CONTRACT NO. 68370			ILLINOIS FED. AID PROJECT	