

**TEMPORARY TRAFFIC SIGNAL NOTES:**

1. AT THE CONTRACTOR'S OPTION, TEMPORARY PORTABLE BRIDGE TRAFFIC SIGNALS MAY BE USED IN PLACE OF TEMPORARY BRIDGE TRAFFIC SIGNALS.
2. TRAFFIC CONTROL SHALL BE IN ACCORDANCE WITH STANDARD 701316 OR 701321 AS APPLICABLE EXCEPT WHERE MODIFIED ON THIS PLAN SHEET.
3. THREE-PHASE SIGNAL OPERATION IS REQUIRED, THE ENGINEER OF TRAFFIC SHALL APPROVE ALL TIMING PARAMETERS.
4. STOP BAR PLACEMENT, DRUMS WITH STEADY BURNING LIGHTS, TEMPORARY CONCRETE BARRIER WALL AND SIGNAL PLACEMENT/DETAILS INCLUDING ENTRANCE SIGNALS SHALL BE AS SHOWN OR AS DIRECTED BY THE ENGINEER.
5. ALL TRAFFIC SIGNAL AND ADVANCE WARNING FLASHER SECTIONS SHALL HAVE 12" DIAMETER LENSES.
6. THE TEMPORARY TRAFFIC SIGNAL HEADS SHALL BE PLACED AS INDICATED ON THE PLANS OR AS DIRECTED BY THE ENGINEER.
7. THE TEMPORARY TRAFFIC SIGNAL INSTALLATION SHALL CONFORM TO ALL M.U.T.C.D. REQUIREMENTS.
8. THE CONTRACTOR, AT HIS OPTION, MAY ELECT TO UTILIZE MICROWAVE DETECTORS FOR BOTH MAINLINE APPROACHES.
9. ALL LABOR, EQUIPMENT AND MATERIALS REQUIRED TO COMPLY WITH THESE REQUIREMENTS AND PLAN SHEET DETAILS SHALL BE INCLUDED IN THE PRICE FOR THE TEMPORARY BRIDGE SIGNAL INSTALLATION. THERE WILL BE NO ADDITIONAL COMPENSATION.

- (SEE STRUCTURE PLANS)
- PROPOSED HMA SURFACE REMOVAL (DECK) (5'±) AND PROPOSED REINFORCED CONCRETE SLAB 12"
  - PROPOSED HMA SURFACE REMOVAL - BUTT JOINT

MACHINE SHED  
CONC PAD

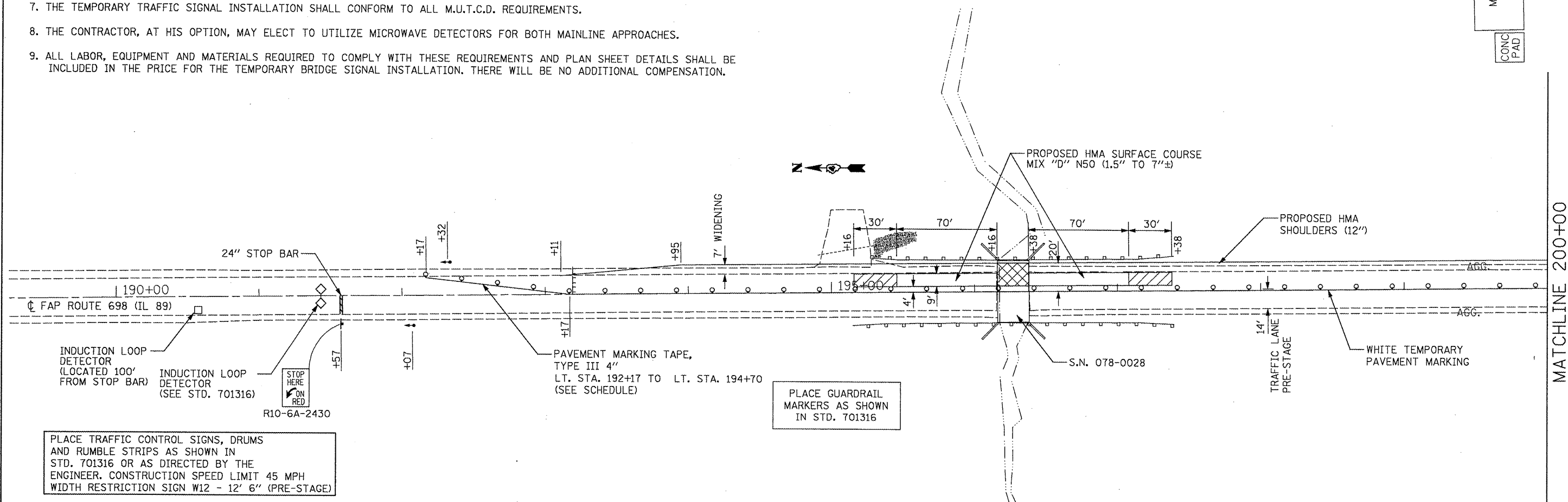

PLACE TRAFFIC CONTROL SIGNS, DRUMS AND RUMBLE STRIPS AS SHOWN IN STD. 701316 OR AS DIRECTED BY THE ENGINEER. CONSTRUCTION SPEED LIMIT 45 MPH WIDTH RESTRICTION SIGN W12 - 12' 6" (PRE-STAGE)

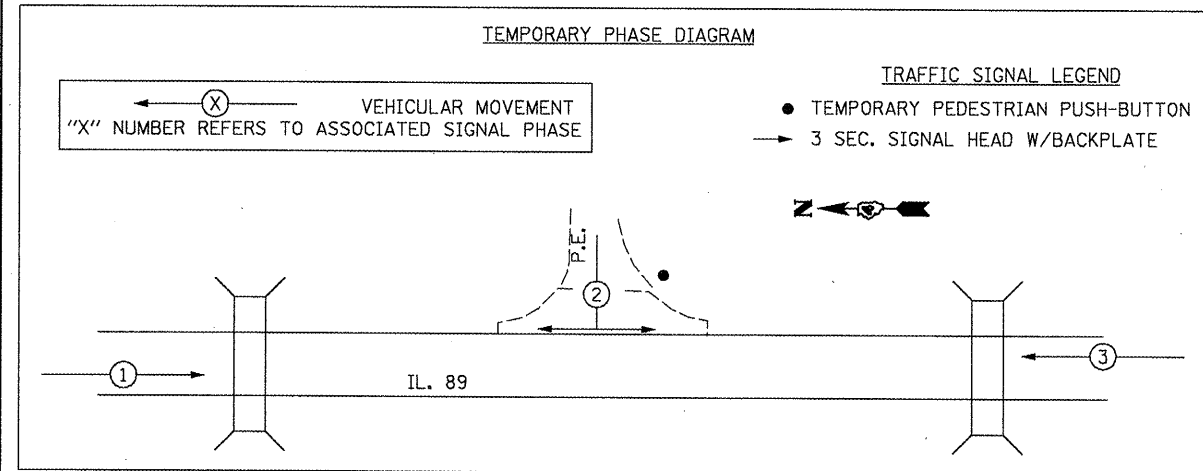

- SEQUENCE OF CONSTRUCTION**
1. SETUP TRAFFIC SIGNALS, SIGNS, RUMBLE STRIPS, DRUMS, ETC. ACCORDING TO THESE DETAILS AND TRAFFIC CONTROL STANDARD 701316, MAINTAINING ALL TRAFFIC ON THE SOUTHBOUND LANE.
  2. REMOVE THE HMA SURFACE OVER STRUCTURE 078-0028 (5'±) AND SHOULDER MATERIAL OVER STRUCTURE 078-0029 (0 - 6.25')
  3. CONSTRUCT THE REINFORCED CONCRETE SLABS OVER THE STRUCTURES AS SHOWN. (SEE STRUCTURE PLANS)
  4. CONSTRUCT HMA SHOULDERS (12") FROM LT. STA. 193+11 TO LT. STA. 196+16; LT. STA. 196+38 TO LT. STA. 202+95; AND LT. STA. 203+13 TO LT. STA. 206+24.

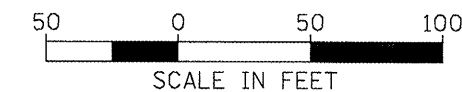

FILE NAME = ... \P1ens\468751-eh-t-staging\1.dgn	USER NAME = #USER	DESIGNED -	REVISED -
Johnson, Depp & O'Leary CONSULTING ENGINEERS Springfield, Illinois	PLOT SCALE = 70.0000' / IN.	DRAWN -	REVISED -
	PLOT DATE = 12/13/2011 18:36:02	CHECKED -	REVISED -
		DATE -	REVISED -

**STATE OF ILLINOIS  
DEPARTMENT OF TRANSPORTATION**

PRE-STAGE CONSTRUCTION AND TRAFFIC CONTROL IN PREPARATION FOR STAGE I TRAFFIC			
SCALE:	SHEET NO. OF SHEETS	STA. TO STA.	

F.A.P. RTE. 698	SECTION (2) BR-1 & BR-2	COUNTY PUTNAM	TOTAL SHEETS 71	SHEET NO. 22
CONTRACT NO. 68571				
ILLINOIS FED. AID PROJECT				

MATCHLINE 200+00