

• WIDTH RESTRICTION 10'-6"

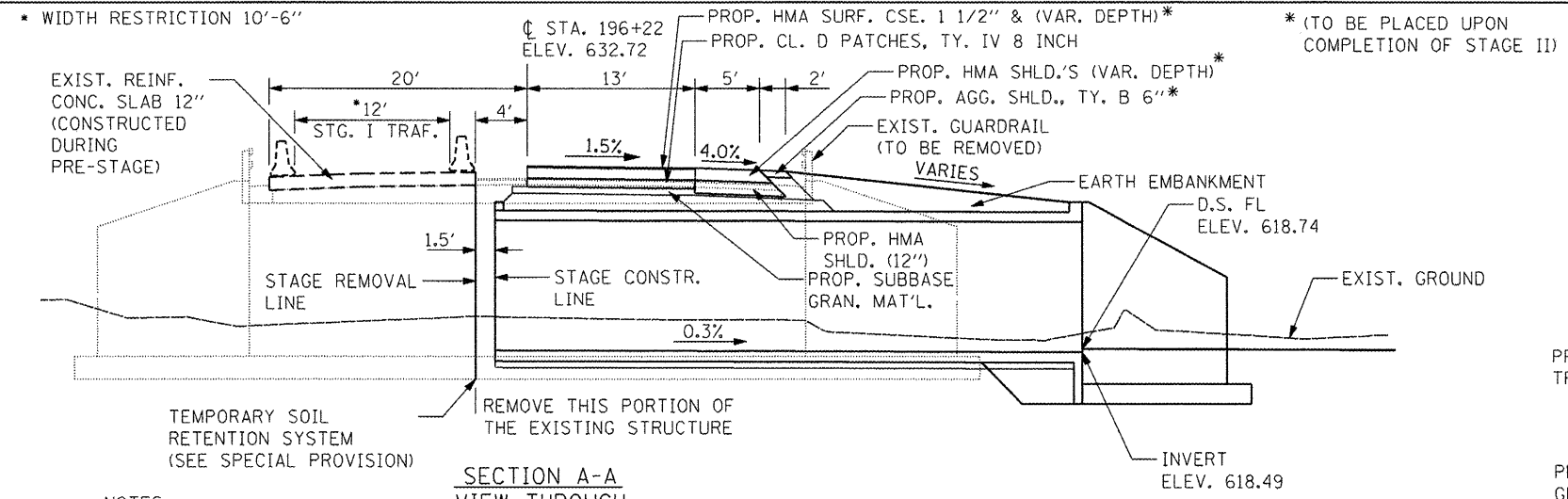

NOTES:
SEE STRUCTURE PLANS FOR ADDITIONAL DETAILS

SEE DETAIL OF EXCAVATION AND BACKFILL FOR BOX CULVERTS FOR ADDITIONAL DETAILS.

SECTION A-A
VIEW THROUGH
11' X 10' DOUBLE RCBC
@ STA. 196+22
(NO SCALE)

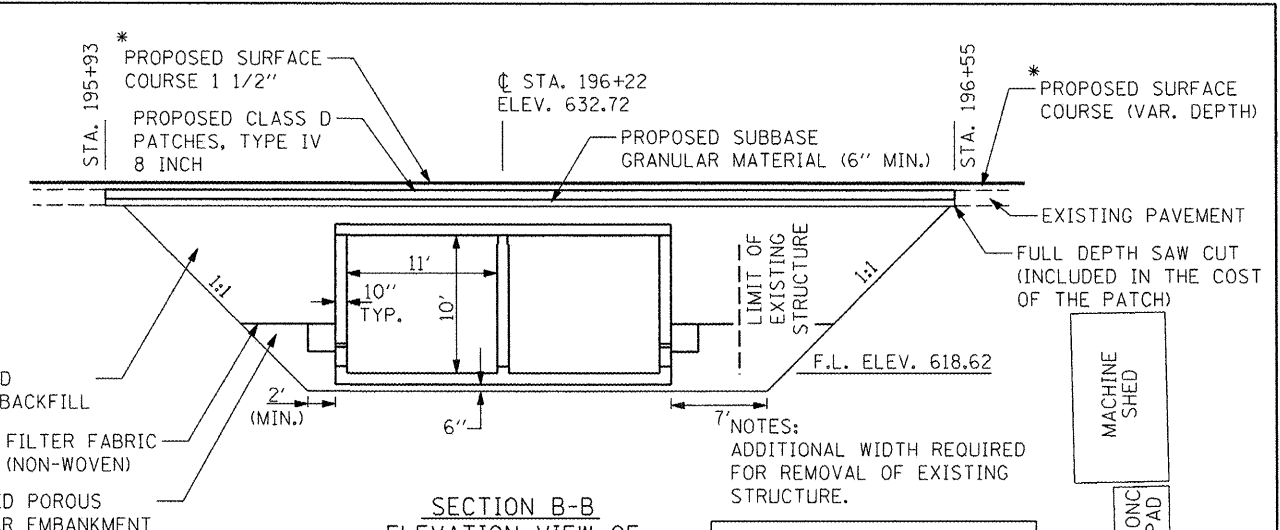

NOTES:
ADDITIONAL WIDTH REQUIRED FOR REMOVAL OF EXISTING STRUCTURE.
SEE DETAIL OF EXCAVATION AND BACKFILL FOR BOX CULVERTS FOR ADDITIONAL DETAILS.

SECTION B-B
ELEVATION VIEW OF
11' X 10' DOUBLE RCBC
@ STA. 196+22
(NO SCALE)

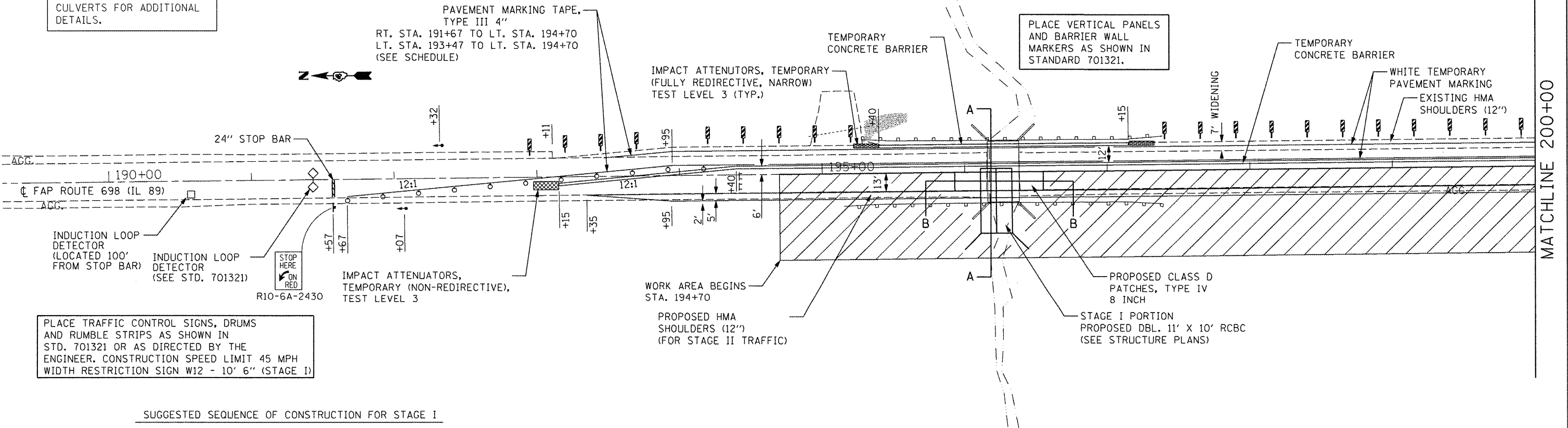

PLACE TRAFFIC CONTROL SIGNS, DRUMS AND RUMBLE STRIPS AS SHOWN IN STD. 701321 OR AS DIRECTED BY THE ENGINEER. CONSTRUCTION SPEED LIMIT 45 MPH WIDTH RESTRICTION SIGN W12 - 10' 6" (STAGE I)

SUGGESTED SEQUENCE OF CONSTRUCTION FOR STAGE I

1. SETUP STAGE I TRAFFIC CONTROL AS PER STANDARD 701321 AND THESE DETAILS. MAINTAINING ALL TRAFFIC ON THE NORTHBOUND LANE. (NOTE: STOP BAR AND TEMPORARY SIGNAL LOCATIONS ESTABLISHED DURING THE PRE-STAGE WORK.)
2. REMOVE THE STAGE I PORTIONS OF THE EXISTING PAVEMENT, STRUCTURES AND GUARDRAIL.
3. CONST THE STAGE I PORTION OF THE PROPOSED CULVERTS.
4. CONST THE STAGE I PORTION OF THE PATCHES OVER THE CULVERTS.
5. CONST THE HMA SHOULDER (12"), EXCEPT FOR TOP LIFT ALONG THE SOUTHBOUND LANE.
6. CHANGE TRAFFIC CONTROL TO STAGE II.

SEQUENCE OF OPERATIONS									
PHASE	A	B	C						
INTERVAL	1	2	3	4	5	6	7	8	9
SOUTHBOUND	G	Y	R	R	R	R	R	R	R
ENTRANCE	R	R	R	G	Y	R	R	R	R
NORTHBOUND	R	R	R	R	R	R	G	Y	R

- TYPE III BARRICADE WITH FLASHING LIGHTS
- SIGN
- DRUM WITH STEADY BURNING LIGHTS
- TRAFFIC SIGNAL
- DOUBLE VERTICAL PANEL

