

150 140 130 120 110 100 90 80 70 60 50 40 30 20 10 0 10 20 30 40 50 60 70 80 90 100 110 120 130 140 150

DATE	
BY	
FINISHED SURVEY	
PLOTTED	
NOTE BOOK	
AREAS CHECKED	
NO.	

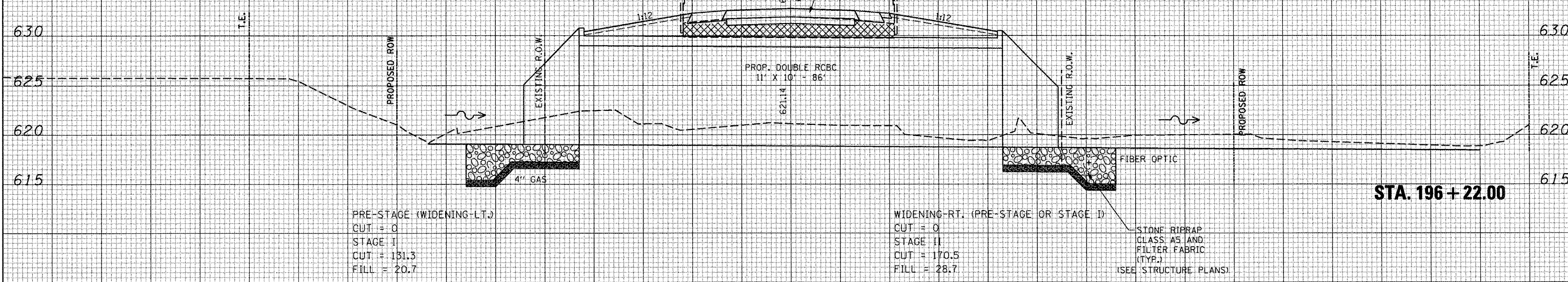

PRE-STAGE (WIDENING-LT.)  
 CUT = 0  
 STAGE I  
 CUT = 181.3  
 FILL = 20.7

WIDENING-RT. (PRE-STAGE OR STAGE I)  
 CUT = 0  
 STAGE II  
 CUT = 170.5  
 FILL = 28.7

STA. 196+22.00

DATE	
BY	
ORIGINAL SURVEY	
PLOTTED	
NOTE BOOK	
AREAS CHECKED	
NO.	

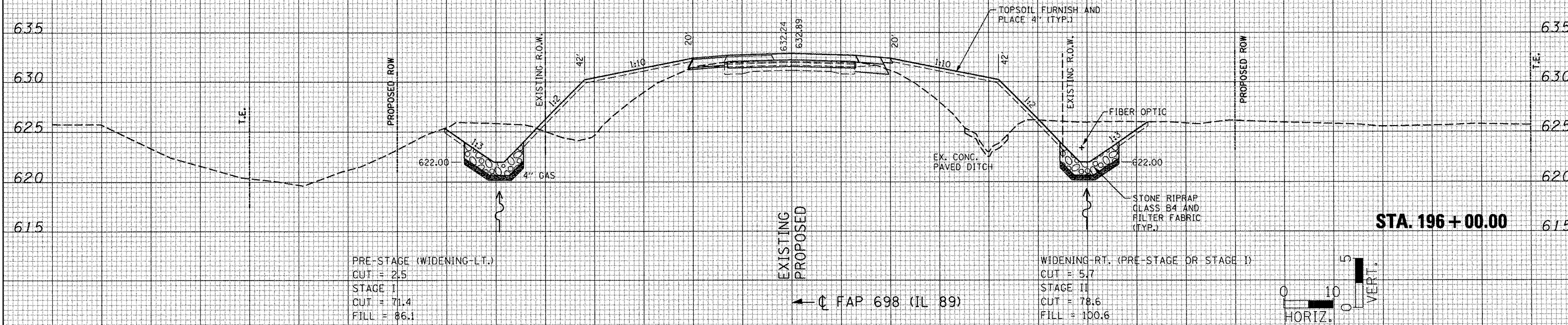

PRE-STAGE (WIDENING-LT.)  
 CUT = 2.5  
 STAGE I  
 CUT = 71.4  
 FILL = 86.1

WIDENING-RT. (PRE-STAGE OR STAGE I)  
 CUT = 5.7  
 STAGE II  
 CUT = 78.6  
 FILL = 100.6

STA. 196+00.00

EXISTING PROPOSED  
 ← FAP 698 (IL 89)

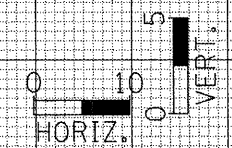

150 140 130 120 110 100 90 80 70 60 50 40 30 20 10 0 10 20 30 40 50 60 70 80 90 100 110 120 130 140 150

FILE NAME \*  
 ...:\plens\0468571-sht-xsht.dgn  
 Johnson, Depp & Oulsenberry  
 CONSULTING ENGINEERS  
 Springfield, Illinois

USER NAME = #USER#  
 DESIGNED -  
 DRAWN -  
 CHECKED -  
 DATE -  
 PLOT SCALE = 20.0000" / IN.  
 PLOT DATE = 12/12/2011 08:15:05

DESIGNED -  
 DRAWN -  
 CHECKED -  
 DATE -  
 REVISED -  
 REVISED -  
 REVISED -  
 REVISED -

STATE OF ILLINOIS  
 DEPARTMENT OF TRANSPORTATION

FAP 698 (IL 89)

SCALE: SHEET NO. OF SHEETS STA. 196+00.00 TO STA. 196+27.00

F.A.P. RTE.	SECTION	COUNTY	TOTAL SHEETS	SHEET NO.
698	(2) BR-1 & BR-2	PUTNAM	71	65
FED. ROAD DIST. NO. ILLINOIS FED. AID PROJECT			CONTRACT NO. 68751	