

BENCHMARK: TBM #10 NORTHWEST  
ABUTMENT OF BRIDGE. ELEV. 681.18

EXISTING STRUCTURE: #055-0003 IS  
22'-6" LONG BY 45'-6" WIDE. BUILT AS S.B.I.  
RTE. 2, SECTION 138 BY STA. 152+95.70  
IN 1964. TRAFFIC SHALL BE MAINTAINED  
ON THE NEW SOUTH B.D. STRUCTURE DURING  
THE REHABILITATION OF THE EXISTING  
NORTH B.D. STRUCTURE.  
NO SALVAGE.

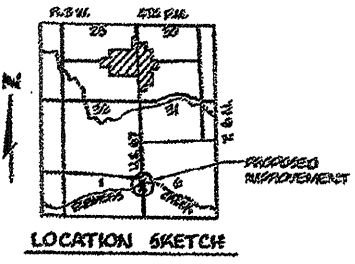
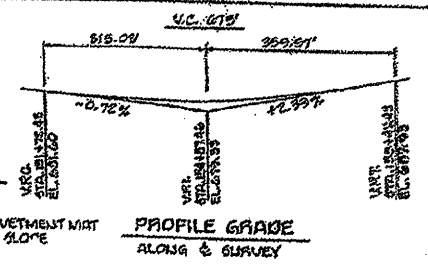
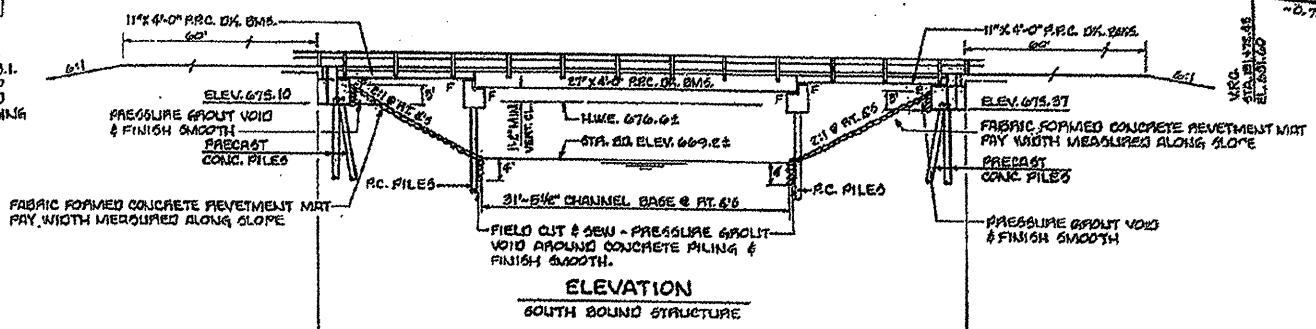

STATION 158+29.70  
BUILT 198... BY  
STATE OF ILLINOIS  
R.A.P. RTE. 10 SEC. 23B-2  
LOADING H5 20  
STA. NO. 055-0027

NAME PLATE  
SEE STANDARD 2115

WATERWAY INFORMATION											
DRAINAGE AREA: 4.85 CANAL LOW GRADE EL. 680.7 @ STA. 152+70											
FLOOD	PROJ. YR.	Q	CSA	EXPOSED	PROP.	W.C.	W.C. - FT.	W.C. - FT.	W.C. - FT.	W.C. - FT.	W.C. - FT.
DESIGN	50	1250	150	150	676.4	1.00	1.00	676.40	1.00	1.00	676.40
BASE	100	1208	146	146	676.9	1.02	1.02	676.92	1.02	1.02	676.92
OVERTOPPING											
MAX. CALC.	500	1823			183	677.4	1.03				677.38

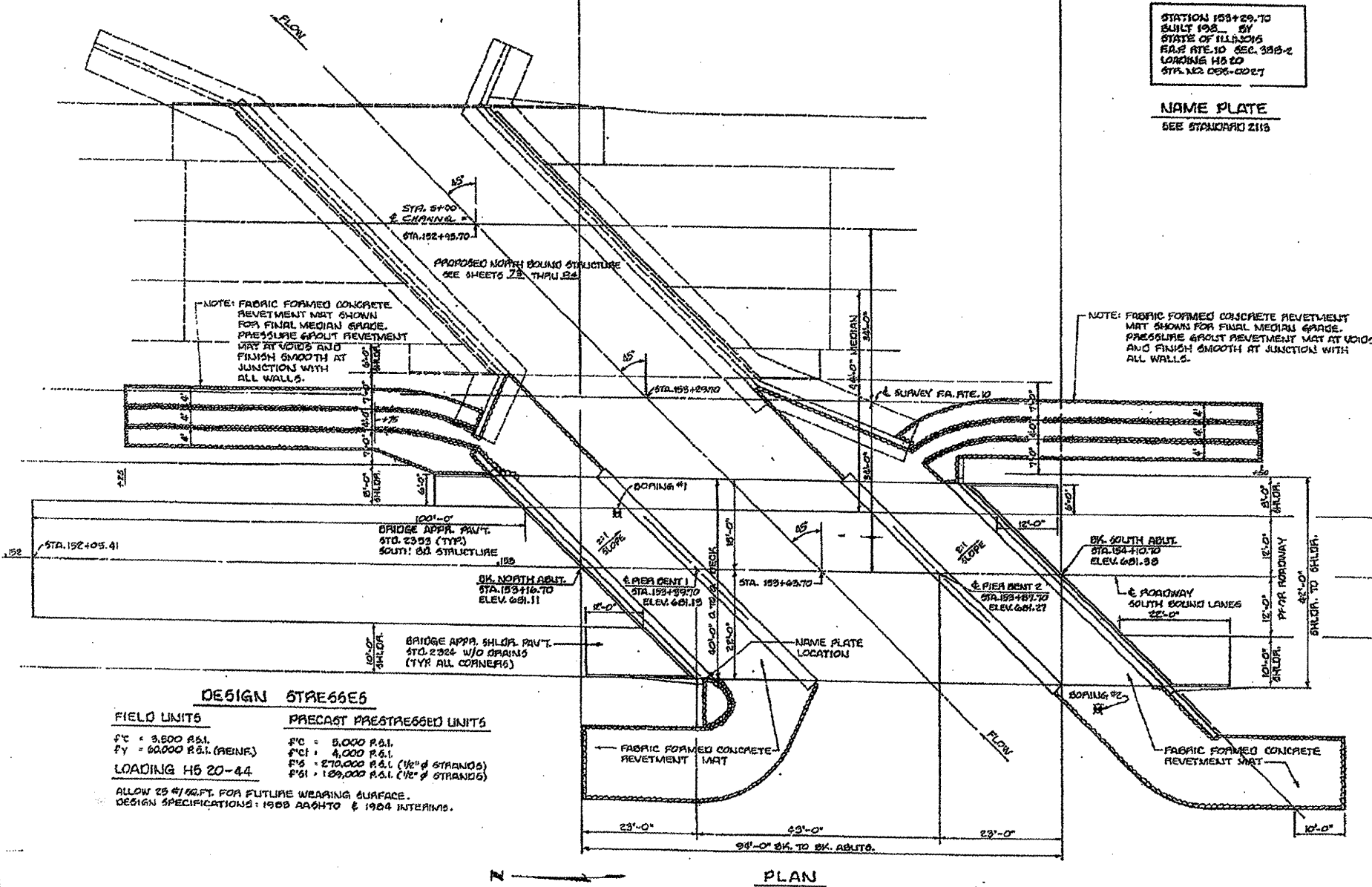

DESIGN STRE66E6	
FIELD LIMITS	PRECAST PRESTRESSED LIMITS
FC = 3,800 P.S.I.	FC = 5,000 P.S.I.
FY = 60,000 P.S.I. (REIN.)	F'CI = 4,000 P.S.I.
	F'CS = 270,000 P.S.I. (1/2" STRANDS)
	F'CI = 129,000 P.S.I. (1/2" STRANDS)

LOADING H5 20-44  
ALLOW 25 #/SQ.FT. FOR FUTURE WEARING SURFACE.  
DESIGN SPECIFICATIONS: 1985 BAHTO & 1984 INTERIMS.

TOTAL BILL OF MATERIAL				
ITEM	UNIT	AMT.	QTY.	TOTAL
PROTECTIVE COAT	SQ.YD.	411		411
CLASS 7" CONCRETE	CU.YD.	613	107.0	170.3
PRECAST PRESTRESSED CONCRETE DECK BEAMS (18" DEPTH)	SQ.FT.	1,673.7		1,673.7
PRECAST PRESTRESSED CONCRETE DECK BEAMS (27" DEPTH)	SQ.FT.	1,915.4		1,915.4
STEEL MAILING TYPE 5-1	LIN.FT.	100		100
REINFORCEMENT BARS	FOUN.	11,200		11,200
REINFORCEMENT BARS (EPOXY COATED)	FOUN.	4,060		4,060
PRECAST CONCRETE PILES, 18"	LIN.FT.	582		582
TEST PILE, PRECAST CONCRETE	EACH	2		2
NAME PLATE	EACH	1		1
FABRIC FORMED CONCRETE REVEMENT MATS	SQ.YD.	430		430
NEOPRENE EXPANSION JOINT, 2"	LIN.FT.	56.5		56.5
STRUCTURE EXCAVATION	CU.YD.	127		127

GENERAL NOTES:  
REINFORCEMENT BARS SHALL CONFORM TO THE REQUIREMENTS OF ASTM A-618 OR A-618 GRACE CO.  
LAYOUT OF REVEMENT MAT MAY BE VARIED IN THE FIELD TO SUIT SPECIAL CONDITIONS AS DIRECTED BY THE ENGINEER.  
THE EMBANKMENT CONSTRUCTION SHOWN SHALL BE THE MINIMUM EMBANKMENT THAT MUST BE CONSTRUCTED PRIOR TO CONSTRUCTION OF THE ABUTMENTS.  
THE CONTRACTOR SHALL GRADE ONE PRECAST CONCRETE TEST PILE AS A PERMANENT LOCATION AT EACH ABUTMENT AS DIRECTED BY THE ENGINEER BEFORE ORDERING THE REMOVAL OF PILES.  
A CALCIUM NITRATE CORROSION INHIBITOR, AS COVERED IN THE SPECIAL PROVISIONS, SHALL BE USED IN THE CONCRETE FOR PRECAST PRESTRESSED CONCRETE DECK BEAMS.  
For Precast Concrete Pile details see sheet 72.

APPROVED  
James J. Taylor  
FREDERICK D. DEERY, Jr. 12.15.96

GENERAL PLAN - ILL. RTE. 67 OVER FARMERS CREEK  
R.A. RTE. 10 SEC. 23B-2 SOUTH BOUND MCDONOUGH COUNTY  
AUSTIN ENGINEERING CO., INC. CIVIL ENGINEERS  
DATE: 12-15-96