

EAST EDGE OF SHOULDER

Location	Station	Offset	Theoretical Grade Elevations
N. End North Appr. Slab	151+85.76	-22.00	684.04
A1	151+95.76	-22.00	684.07
A2	152+05.76	-22.00	684.10
S. End North Appr. Slab	152+15.76	-22.00	684.13

EAST EDGE OF PAVEMENT

Location	Station	Offset	Theoretical Grade Elevations
N. End North Appr. Slab	151+95.76	-12.00	684.28
A1	152+05.76	-12.00	684.31
A2	152+15.76	-12.00	684.34
S. End North Appr. Slab	152+25.76	-12.00	684.37

☉ ROADWAY & PROFILE GRADE

Location	Station	Offset	Theoretical Grade Elevations
N. End North Appr. Slab	152+07.76	0.00	684.50
A1	152+17.76	0.00	684.53
A2	152+27.76	0.00	684.56
S. End North Appr. Slab	152+37.76	0.00	684.59

WEST EDGE OF PAVEMENT

Location	Station	Offset	Theoretical Grade Elevations
N. End North Appr. Slab	152+31.76	24.00	684.20
A1	152+41.76	24.00	684.23
A2	152+51.76	24.00	684.26
S. End North Appr. Slab	152+61.76	24.00	684.29

WEST EDGE OF SHOULDER

Location	Station	Offset	Theoretical Grade Elevations
N. End North Appr. Slab	152+35.76	28.00	684.13
A1	152+45.76	28.00	684.16
A2	152+55.76	28.00	684.19
S. End North Appr. Slab	152+65.76	28.00	684.22

Offsets are measured from ☉ NB lanes.

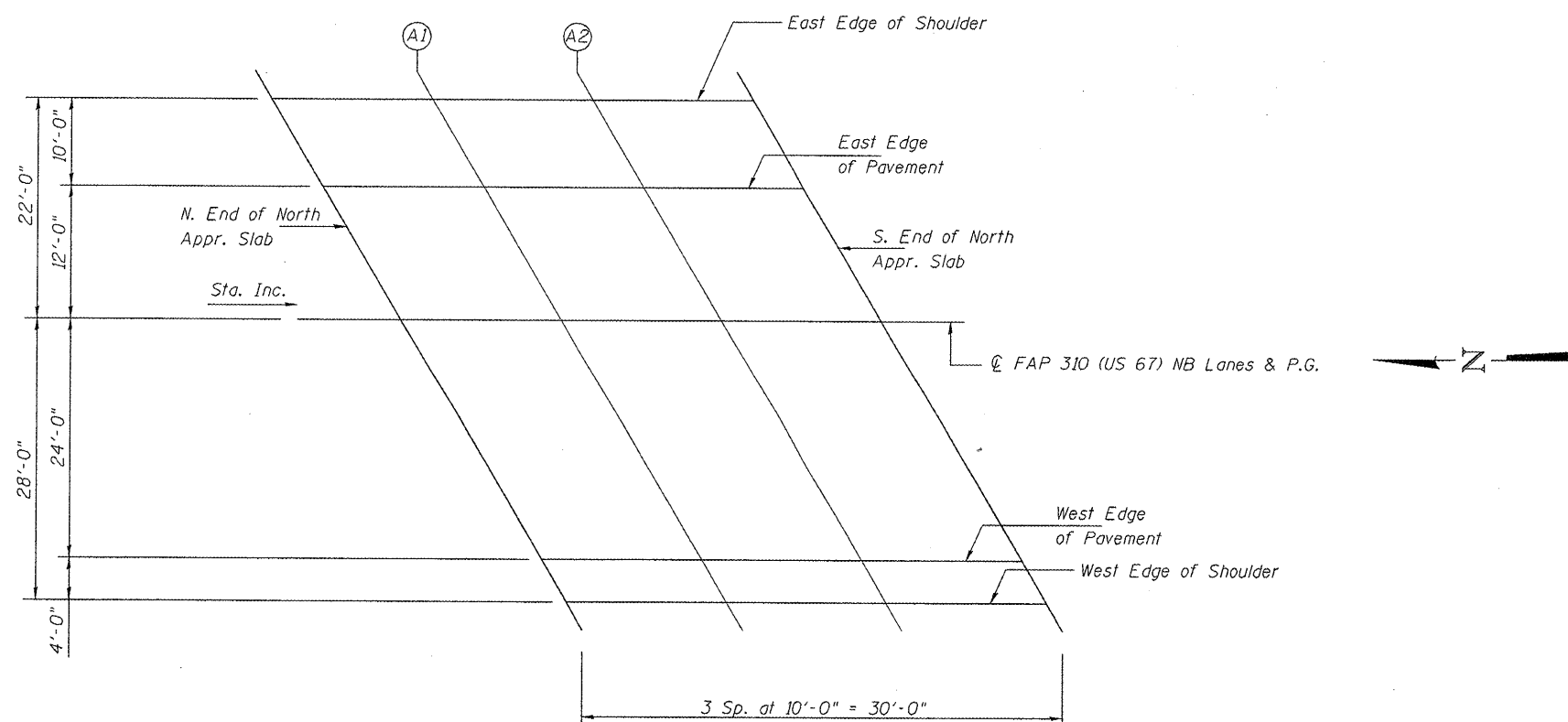

PLAN
North Approach (N.B.)

FILE NAME =	USER NAME = seb	DESIGNED - KTH	REVISED -
P:\07files\070286\Phase2\Bridges\Plans\08_Top_N-ApproachSlabElev_0000.dgn		CHECKED - ADL	REVISED -
		DRAWN - BGJ	REVISED -
		CHECKED - RJP	REVISED -

STATE OF ILLINOIS
DEPARTMENT OF TRANSPORTATION

TOP OF NORTH APPROACH SLAB ELEVATIONS
S.N. 055-0080 (NB)

F.A.P. RTE.	SECTION	COUNTY	TOTAL SHEETS	SHEET NO.
310	(38B-2)BR	MCDONOUGH	130	65
CONTRACT NO. 68691				