

F.A.P. RTE.	SECTION	COUNTY	TOTAL SHEETS	SHEET NO.
399	(35,36)N-1	TAZEWELL	60	1
		ILLINOIS	CONTRACT NO. 68A66	

STATE OF ILLINOIS
DEPARTMENT OF TRANSPORTATION
DIVISION OF HIGHWAYS

PROPOSED HIGHWAY PLANS

F.A.P. ROUTE 399 / F.A.U. 6717 (IL 8 / BUS. US 24)
SECTION (35,36)N-1
PROJECT F-HSIP-000S(87A)
TAZEWELL COUNTY
C-94-009-12

D-94-010-12

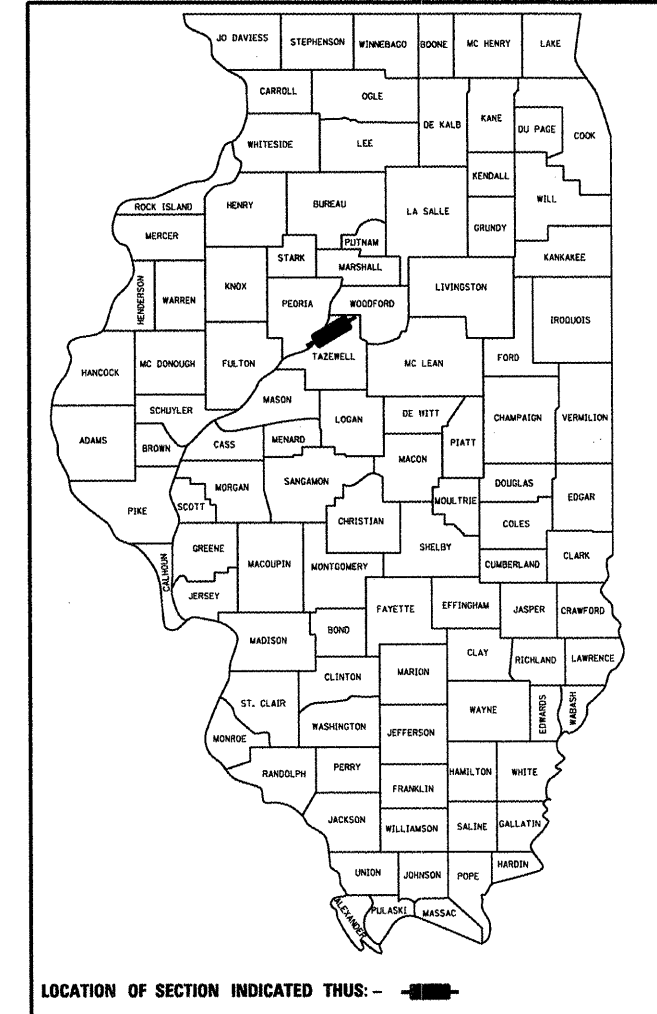

QC /QA CONCRETE
N P D E S REQUIRED

FOR INDEX OF SHEETS, SEE SHEET NO. 2

FAP 399 IL 8 (WEST OF M'CLUGGAGE RD.)
ADT = 12,900
% SU = 2.71%
% MU = 0.54%

FAU 6717 BUS. US 24 (EAST OF M'CLUGGAGE RD.)
ADT = 19,900
% SU = 1.63%
% MU = 0.50%

DESIGN DESIGNATION
CLASS II TRUCK ROUTE

FUNCTIONAL CLASSIFICATION
OTHER PRINCIPAL ARTERIAL / MINOR ARTERIAL URBAN

FOR THE LIST OF HIGHWAY STANDARDS, SEE SHEET NO. 2

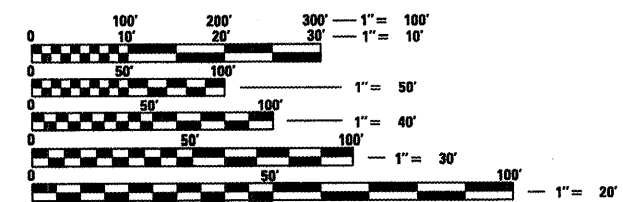

FULL SIZE PLANS HAVE BEEN PREPARED USING STANDARD ENGINEERING SCALES. REDUCED SIZED PLANS WILL NOT CONFORM TO STANDARD SCALES. IN MAKING MEASUREMENTS ON REDUCED PLANS, THE ABOVE SCALES MAY BE USED.

J.U.L.I.E.
JOINT UTILITY LOCATION INFORMATION FOR EXCAVATION
1-800-892-0123
OR 811

PROJECT ENGINEER: RICHARD DOTSON (309) 671-3455
DESIGN ENGINEER: JEN RUDZINSKI/KEVIN HORST (309) 671-3472

CATALOG NO. - 034714-00D
CONTRACT NO. 68A66

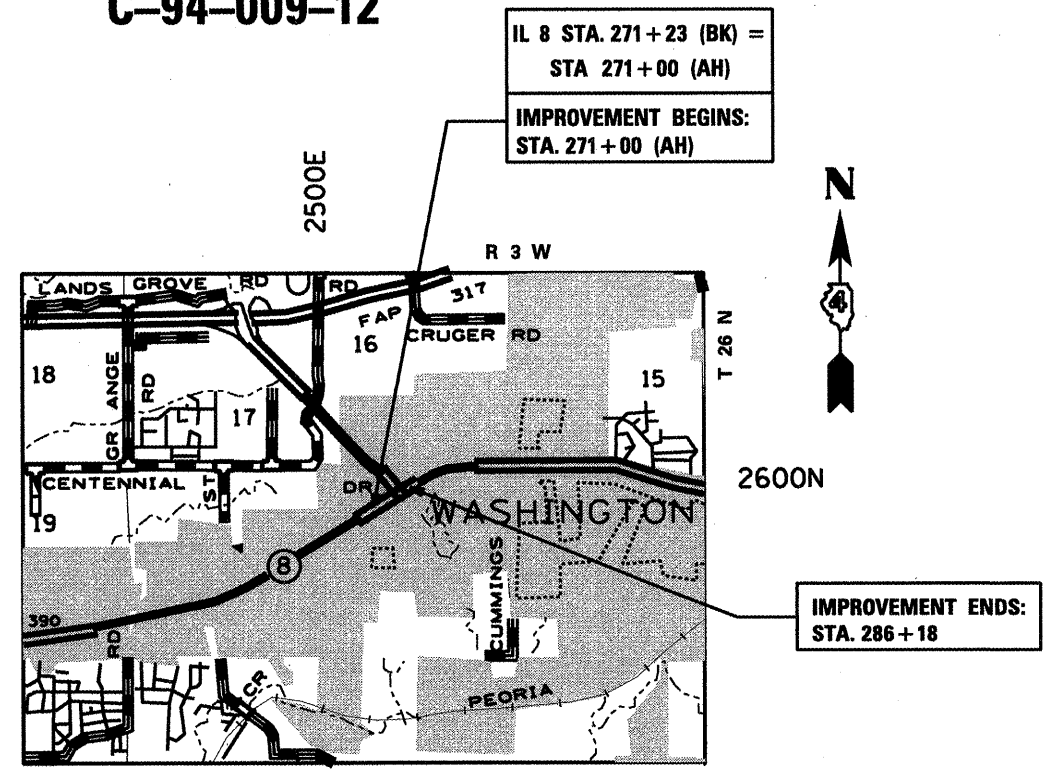

GROSS LENGTH = 1568 FT. = 0.297 MILE
NET LENGTH = 1518 FT. = 0.288 MILE

DESCRIPTION OF WORK:
THE PROPOSED IMPROVEMENT CONSISTS OF INTERSECTION MODIFICATION, TRAFFIC SIGNAL WORK, AS WELL AS CONSTRUCTION OF A MULTI-USE PATH.

STATE OF ILLINOIS
DEPARTMENT OF TRANSPORTATION
DIVISION OF HIGHWAYS

SUBMITTED Dec 19 20 11
Joseph E. Coast
DEPUTY DIRECTOR OF HIGHWAYS, REGION ENGINEER

Feb 3 20 12
John D. Zaramelli, P.E.
ENGINEER OF DESIGN AND ENVIRONMENT

Feb 3 20 12
William R. Fiey, Jr.
DIRECTOR OF HIGHWAYS, CHIEF ENGINEER

**PRINTED BY THE AUTHORITY
OF THE STATE OF ILLINOIS**