

MEDIAN INLET BOX REMOVAL
 STA. 711+01.61 1 EACH
 (SEE SCHEDULE)

MEDIAN INLET BOX REMOVAL
 STA. 725+02.28 1 EACH
 (SEE SCHEDULE)

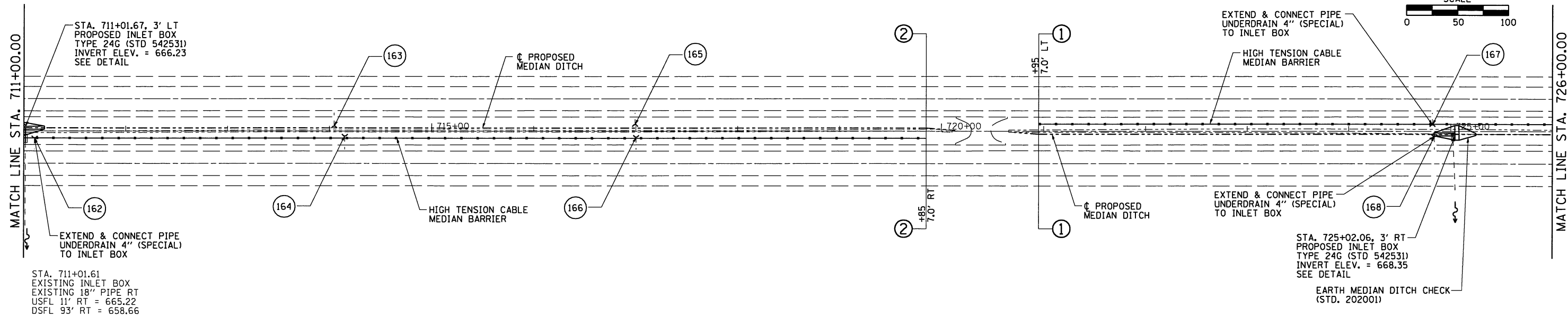
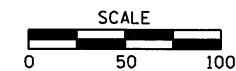

STA. 711+01.61
 EXISTING INLET BOX
 EXISTING 18" PIPE RT
 USFL 11' RT = 665.22
 DSFL 93' RT = 658.66

STA. 725+02.06, 3' RT
 PROPOSED INLET BOX
 TYPE 24G (STD 542531)
 INVERT ELEV. = 668.35
 SEE DETAIL

EARTH MEDIAN DITCH CHECK
 (STD. 202001)

STA. 725+02.28
 EXISTING INLET BOX
 EXISTING 18" PIPE RT
 USFL 8' RT = 668.34
 DSFL 62' RT = 668.22

INDICATES PIPE UNDERDRAINS, 4" (SPECIAL)
 SEE SCHEDULE

PLAN	REVISIONS	DATE
NO.	BY	
NO.	BY	
NO.	BY	
NO.	BY	
NO.	BY	

PROFILE	REVISIONS	DATE
NO.	BY	
NO.	BY	
NO.	BY	
NO.	BY	
NO.	BY	

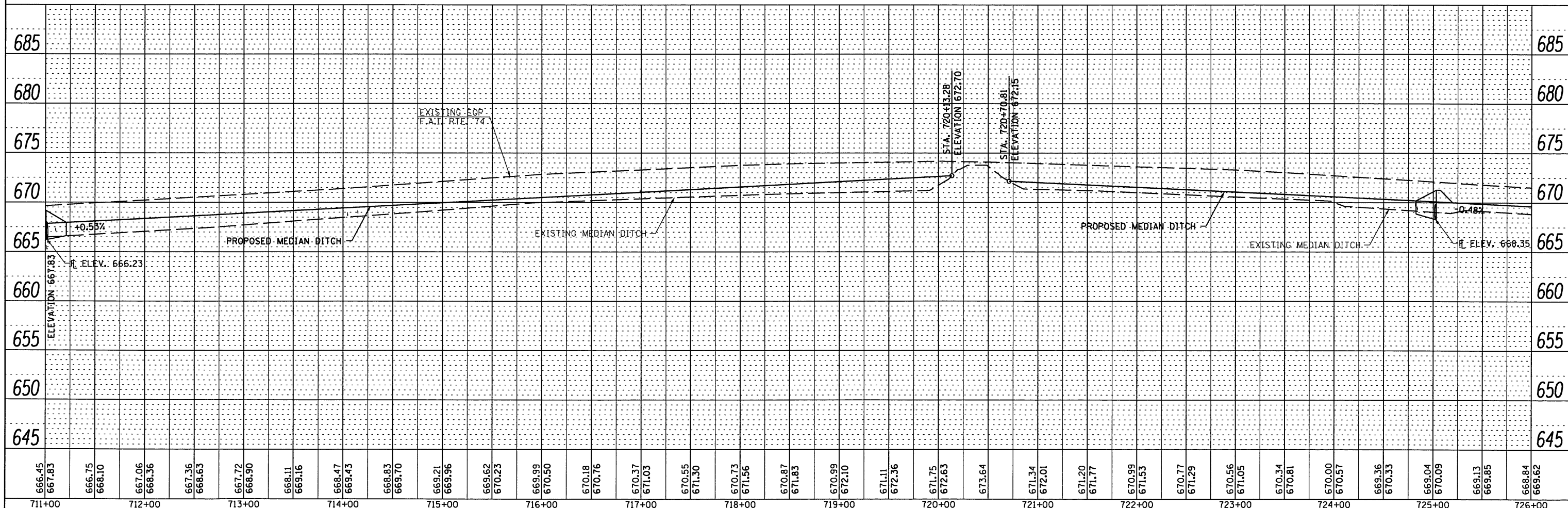

666.45	667.83	666.75	668.10	667.06	668.36	667.36	668.63	667.72	668.90	668.11	669.16	668.47	669.43	668.83	669.70	669.21	669.96	669.62	670.23	669.99	670.50	670.18	670.76	670.37	671.03	670.55	671.30	670.73	671.56	670.87	671.83	670.99	672.10	671.11	672.36	671.75	672.63	673.64	671.34	672.01	671.20	671.77	670.99	671.53	670.77	671.29	670.56	671.05	670.34	670.81	670.00	670.57	669.36	670.33	669.04	670.09	669.13	669.85	668.84	669.62
711+00	712+00	713+00	714+00	715+00	716+00	717+00	718+00	719+00	720+00	721+00	722+00	723+00	724+00	725+00	726+00																																													

STATE OF ILLINOIS
DEPARTMENT OF TRANSPORTATION

PLAN & PROFILE
F.A.I. 74

F.A.I. RTE. 74	SECTION HSIP FY2012-1	COUNTY CHAMPAIGN	TOTAL SHEETS 160	SHEET NO. 28
SCALE:			CONTRACT NO. 70956	