

STATE OF ILLINOIS
DEPARTMENT OF TRANSPORTATION
DIVISION OF HIGHWAYS

**PROPOSED
CONTRACT MAINTENANCE**

FAS 733 (OLD IL 4)
SECTION (E)RS, I-1

MACOUPIN COUNTY

C-96-006-12

R 6 W

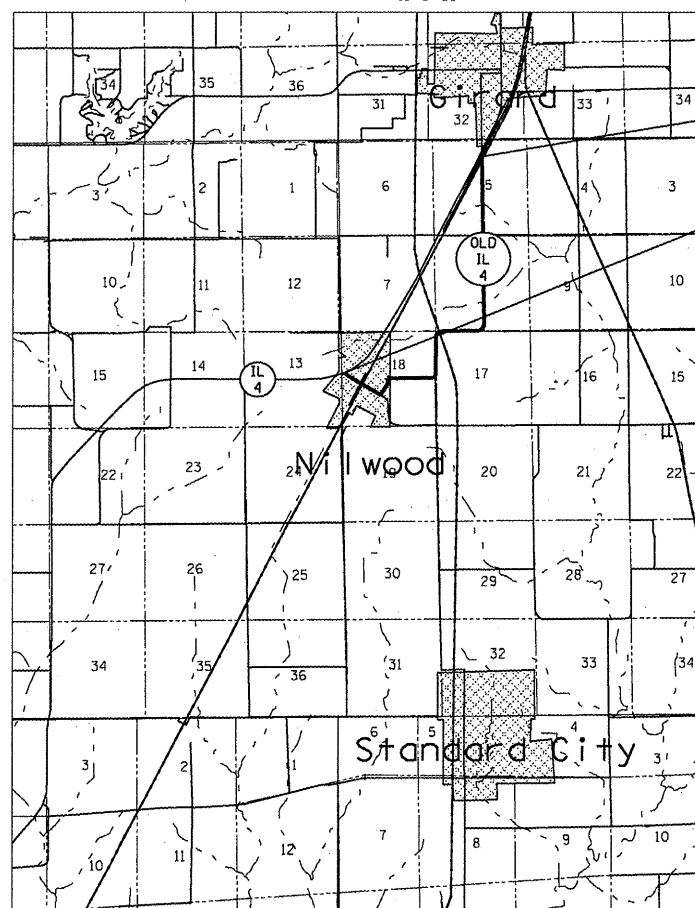

BEGIN PROJECT
STA. 1529 + 18.80

END PROJECT
STA. 1742 + 50.00

T 11 N

GROSS LENGTH = 21,331.20 FT. = 4.040 MILE

F.A.S. RTE.	SECTION	COUNTY	TOTAL SHEETS	SHEET NO.
733	(E)RS, I-1	MACOUPIN	5	1
FED. ROAD DIST. NO.	ILLINOIS	CONTRACT NO. 72E69		

D-96-006-12



LOCATION OF SECTION INDICATED THUS: - ■ -

FOR INDEX OF SHEETS, SEE SHEET NO. 2

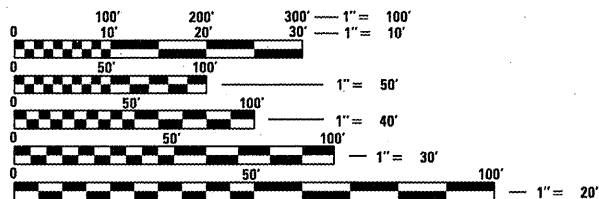

FULL SIZE PLANS HAVE BEEN PREPARED USING STANDARD ENGINEERING SCALES. REDUCED SIZED PLANS WILL NOT CONFORM TO STANDARD SCALES. IN MAKING MEASUREMENTS ON REDUCED PLANS, THE ABOVE SCALES MAY BE USED.

J.U.L.I.E.
JOINT UTILITY LOCATION INFORMATION FOR EXCAVATION
1-800-892-0123
OR 811

PLAN AND CONTRACT TECHNICIAN
TIMOTHY SHARP (217)782-7743

CONTRACT NO. 72E69

STATE OF ILLINOIS
DEPARTMENT OF TRANSPORTATION
DIVISION OF HIGHWAYS

SUBMITTED December 29, 2011
Roger Z. [Signature]
DEPUTY DIRECTOR OF HIGHWAYS, REGION ENGINEER
Feb 3, 2012
John D. Baranzelli, P.E., [Signature]
acting ENGINEER OF DESIGN AND ENVIRONMENT
Feb 3, 2012
William R. [Signature]
acting DIRECTOR OF HIGHWAYS, CHIEF ENGINEER

PRINTED BY THE AUTHORITY
OF THE STATE OF ILLINOIS