

STATE OF ILLINOIS
DEPARTMENT OF TRANSPORTATION
DIVISION OF HIGHWAYS

**PROPOSED
HIGHWAY PLANS**

S.B.I. ROUTE 11 (OLD U.S. RTE. 40)
SECTION D7 HMA RESUR 2012-3

CONTRACT MAINTENANCE RESURF
CLARK COUNTY

C-97-082-11

FOR INDEX OF SHEETS, SEE SHEET NO. 2

ADT = 500 (2006)

S.B.I. RTE.	SECTION	COUNTY	TOTAL SHEETS	SHEET NO.
11	DT HMA RESUR 2012-3	CLARK	11	1
		ILLINOIS	CONTRACT NO. 74533	

D-97-035-11

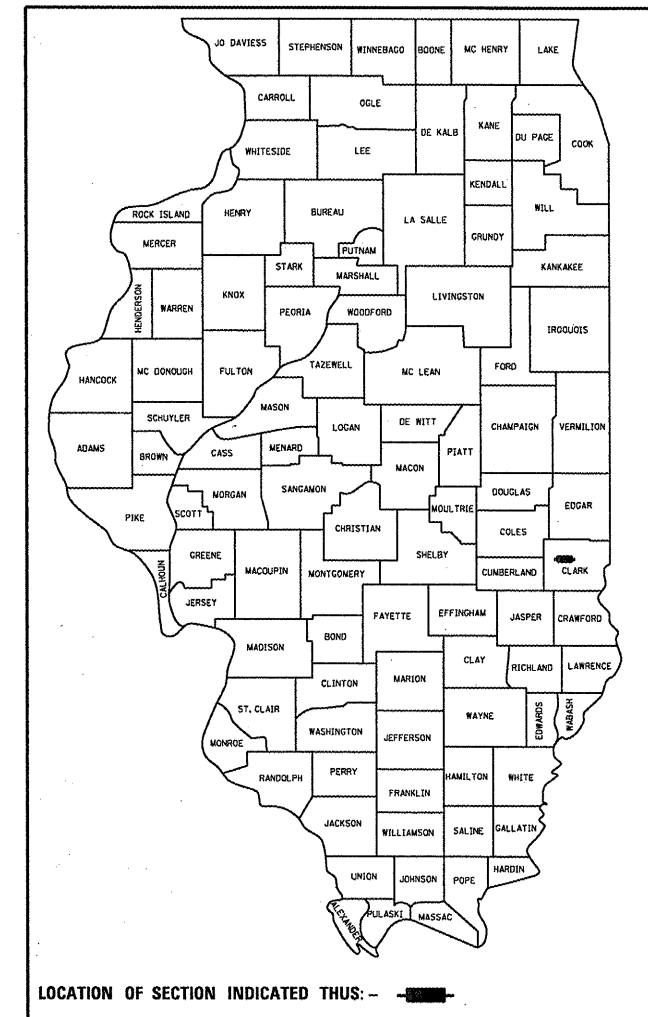

LOCATION OF SECTION INDICATED THUS: - [shaded area] -

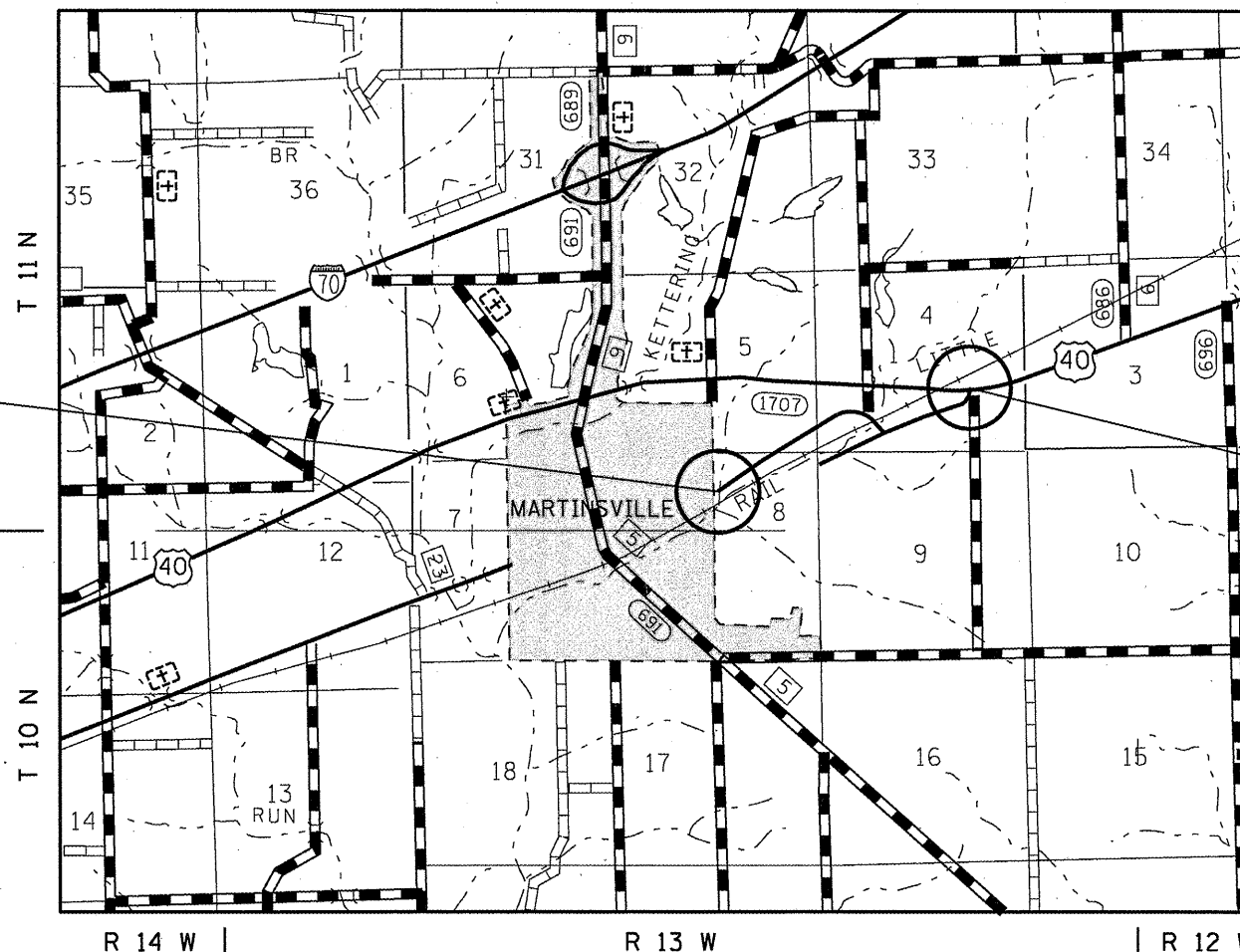

PROJECT STARTS:
STATION 5+06

PROJECT ENDS:
STATION 79+85

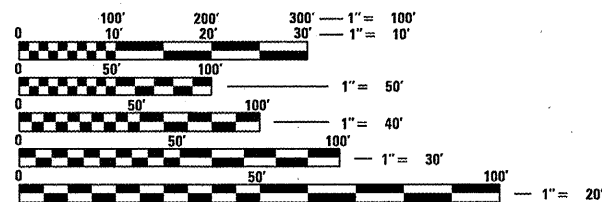

FULL SIZE PLANS HAVE BEEN PREPARED USING STANDARD ENGINEERING SCALES. REDUCED SIZED PLANS WILL NOT CONFORM TO STANDARD SCALES. IN MAKING MEASUREMENTS ON REDUCED PLANS, THE ABOVE SCALES MAY BE USED.

J.U.L.I.E.
JOINT UTILITY LOCATION INFORMATION FOR EXCAVATION
1-800-892-0123
OR 811

PROJECT ENGINEER: TOM RONAN
PROJECT MANAGER: TOM RONAN
PHONE: 217-342-8320
CONTRACT NO. 74533

GROSS LENGTH = 7,479 FT. = 1.42 MILE
NET LENGTH = 7,304 FT. = 1.38 MILE

STATE OF ILLINOIS
DEPARTMENT OF TRANSPORTATION
DIVISION OF HIGHWAYS

SUBMITTED *Dec 7 20 11*
Roger L. Driskell
DEPUTY DIRECTOR OF HIGHWAYS, REGION ENGINEER

Feb 3 20 12
John D. Baranzelli, P.E.
ENGINEER OF DESIGN AND ENVIRONMENT

Feb 3 20 12
William R. Fleener
DIRECTOR OF HIGHWAYS, CHIEF ENGINEER

PRINTED BY THE AUTHORITY
OF THE STATE OF ILLINOIS

INDEX OF SHEETS

SHEET NO.	ITEM
1	COVER SHEET
2	INDEX OF SHEETS AND GENERAL NOTES
3-4	SUMMARY OF QUANTITIES
5-6	TYPICAL SECTIONS
7	SCHEDULE OF QUANTITIES
8	ENTRANCE SCHEDULE
9-10	CONSTRUCTION DETAILS
11	LOCATION MAP

THE FOLLOWING STANDARDS ARE A PART OF THESE PLANS AND ARE INCLUDED AFTER SHEET NO. 11:

STD. NO.	DESCRIPTION
000001-06	STANDARD SYMBOLS, ABBREVIATIONS AND PATTERNS
442201-03	CLASS C AND D PATCHES
482011-03	HMA SHLD. STRIPS/SHLDS. WITH RESURFACING OR WIDENING AND RESURFACING PROJECTS
701001-02	OFF-ROAD OPERATIONS, 2L, 2W, MORE THAN 15' AWAY
701006-03	OFF-RD OPERATIONS, 2L, 2W, 15' TO 24" FROM PAVEMENT EDGE
701011-02	OFF-RD MOVING OPERATIONS, 2L, 2W, DAY ONLY
701201-04	LANE CLOSURE, 2L, 2W, DAY ONLY, FOR SPEEDS >= 45 MPH
701301-04	LANE CLOSURE, 2L, 2W, SHORT TIME OPERATIONS
701306-03	LANE CLOSURE, 2L, 2W, SLOW MOVING OPERATIONS DAY ONLY, FOR SPEEDS >= 45 MPH
701311-03	LANE CLOSURE 2L, 2W, MOVING OPERATIONS - DAY ONLY
701901-02	TRAFFIC CONTROL DEVICES
780001-03	TYPICAL PAVEMENT MARKINGS

GENERAL NOTES

THIS SECTION SHALL BE CONSTRUCTED IN ACCORDANCE WITH THE PLANS; THE "STANDARD SPECIFICATIONS FOR ROAD AND BRIDGE CONSTRUCTION" ADOPTED JANUARY 1, 2012; AND THE SPECIAL PROVISIONS INCLUDED IN THE PROPOSAL.

THIS PROJECT IS LOCATED ON SBI ROUTE 11 (OLD US 40) IN CLARK COUNTY, FROM THE EAST CORPORATE LIMITS OF MARTINSVILLE EXTENDING EAST FOR 1.42 MILES TO US ROUTE 40. THE WORK INCLUDED IN SECTION D7 HMA RESURF 2012-3 CONSISTS OF PAVEMENT PATCHING, MILLING, HOT-MIX ASPHALT RESURFACING, AGGREGATE SHOULDERS, PAVEMENT MARKING, AND ANY OTHER WORK NECESSARY TO COMPLETE THE SECTION.

PAVEMENT MARKING SHALL BE APPLIED IN ACCORDANCE WITH SECTION 780 OF THE STANDARD SPECIFICATIONS. SHORT TERM PAVEMENT MARKING SHALL BE APPLIED TO THE MILLED SURFACE, BITUMINOUS MATERIALS (PRIME COAT), LEVELING BINDER, AND HOT-MIX ASPHALT SURFACE COURSE AS SPECIFIED IN SECTION 703 OF THE STANDARD SPECIFICATIONS. TEMPORARY TAPE SHALL BE USED ON THE SURFACE COURSE AND PAINT SHALL BE USED ON THE MILLED SURFACE.

THE TOTAL QUANTITY OF PAINT PAVEMENT MARKING-LINE 4" CONSISTS OF 14,722 FEET OF WHITE AND 8,018 FEET OF YELLOW.

THE MATERIAL USED FOR AGGREGATE SHOULDERS, TYPE B SHALL BE CRUSHED STONE, CRUSHED CONCRETE, OR RAP. THE MATERIAL USED FOR AGGREGATE SURFACE COURSE, TYPE B SHALL BE CRUSHED STONE OR CRUSHED CONCRETE.

THE EXISTING PAVEMENT SHALL BE PATCHED IN ACCORDANCE WITH SECTION 442 OF THE STANDARD SPECIFICATIONS AND THE SPECIAL PROVISIONS. THE QUANTITY OF PATCHING SHOWN ON THE PLANS IS AN ESTIMATE ONLY AND THE FINAL LOCATIONS AND QUANTITY SHALL BE DETERMINED BY THE ENGINEER IN THE FIELD.

THE PAY ITEM TEMPORARY RAMP HAS BEEN INCLUDED FOR THE CONSTRUCTION OF TEMPORARY RAMPS IN ACCORDANCE WITH ARTICLE 406.08 OF THE STANDARD SPECIFICATIONS. THE COST SHALL INCLUDE BOTH THE INSTALLATION AND THE REMOVAL OF THE TEMPORARY RAMPS.

THE RESIDENT ENGINEER SHALL BE THE SOLE JUDGE CONCERNING THE CURING TIME FOR THE VARIOUS HOT-MIX ASPHALT LIFTS.

THE CONTRACTOR SHALL PROVIDE INTERNET ACCESSIBILITY TO THE HOT-MIX ASPHALT PLANT QUALITY CONTROL LAB SO THAT HOT-MIX ASPHALT PLANT REPORTS CAN BE E-MAILED TO THE DISTRICT HEADQUARTERS. THIS WORK SHALL BE INCLUDED IN THE COST OF ALL HOT-MIX ASPHALT ITEMS.

THE CONTRACTOR SHALL USE EITHER RC-70, SS1H, OR SS-1HP, APPLIED AT THE RATE DIRECTED BY THE ENGINEER, FOR THE PAY ITEM BITUMINOUS MATERIALS (PRIME COAT).

A UNIFORMLY STRAIGHT SAW CUT SHALL BE MADE AT LOCATIONS WHERE PROPOSED NEW CONSTRUCTION WILL ABUT EXISTING HOT-MIX ASPHALT SURFACES. THE SAW CUT SHALL BE MADE FULL DEPTH THROUGH THE EXISTING SURFACE. THIS WORK WILL BE CONSIDERED INCLUDED IN THE COST OF THE CONTRACT ITEMS INVOLVED AND NO EXTRA COMPENSATION WILL BE ALLOWED.

THE FOLLOWING MIXTURE REQUIREMENTS ARE APPLICABLE FOR THIS PROJECT:

MIXTURE USE:	SURFACE COURSE	LEVEL BINDER
PG GRADE:	PG 64-22	PG 64-22
DESIGN AIR VOIDS:	4.0% @ NDESIGN = 70	4.0% @ NDESIGN = 70
MIXTURE COMPOSITION:	IL-9.5	IL-9.5
FRICTION AGGREGATE:	MIXTURE C	N/A
MIXTURE USE:	INCIDENTAL	CLASS D & PARTIAL DEPTH PATCHING
PG GRADE:	PG 64-22	PG 64-22
DESIGN AIR VOIDS:	4.0% @ NDESIGN = 70	4.0% @ NDESIGN = 70
MIXTURE COMPOSITION:	IL-9.5	IL-19.0
FRICTION AGGREGATE:	MIXTURE C	N/A

THE FOLLOWING RATES OF APPLICATION HAVE BEEN USED IN THE CALCULATING PLAN QUANTITIES:

AGGREGATE SURFACE COURSE	2.05 TONS/CU YD
AGGREGATE SHOULDERS	2.05 TONS/CU YD
BITUMINOUS MATERIALS (PRIME COAT)	0.10 GAL/SQ YD
AGGREGATE (PRIME COAT)	4 LBS/SQ YD
HOT-MIX ASPHALT	112 LBS/SQ YD/INCH

FILE NAME :	USER NAME : administrator	DESIGNED -	REVISED -	STATE OF ILLINOIS DEPARTMENT OF TRANSPORTATION	INDEX OF SHEETS & GENERAL NOTES		S.B.I. RTE.	SECTION	COUNTY	TOTAL SHEETS	SHEET NO.
c:\pwork\pwork\stefanmk\d0270542\0	74533-ent-index.dgn	DRAWN -	REVISED -		11	D7 HMA RESUR 2012-3	CLARK	11	2		
PLOT SCALE = 100.0000 ' / in.		CHECKED -	REVISED -		CONTRACT NO. 74533						
PLOT DATE = 12/8/2011		DATE -	REVISED -		SCALE: NA	SHEET NO. 1 OF 1 SHEETS	STA. TO STA.	ILLINOIS FED. AID PROJECT			

SUMMARY OF QUANTITIES			TOTAL QUANTITIES	CONSTRUCTION TYPE CODE		
CODE NO	ITEM	UNIT		100% STATE 0005		
20200600	EXCAVATING AND GRADING EXISTING SHOULDER	UNIT	104	104		
40200800	AGGREGATE SURFACE COURSE, TYPE B	TON	46	46		
40600100	BITUMINOUS MATERIALS (PRIME COAT)	GALLON	1476	1476		
40600300	AGGREGATE (PRIME COAT)	TON	29	29		
40600635	LEVELING BINDER (MACHINE METHOD), N70	TON	634	634		
40600982	HOT-MIX ASPHALT SURFACE REMOVAL - BUTT JOINT	SO YD	70	70		
40600985	PORTLAND CEMENT CONCRETE SURFACE REMOVAL - BUTT JOINT	SO YD	78	78		
40600990	TEMPORARY RAMP	SO YD	50	50		
40603315	HOT-MIX ASPHALT SURFACE COURSE, MIX "C", N70	TON	1361	1361		
40800050	INCIDENTAL HOT-MIX ASPHALT SURFACING	TON	15	15		
44000158	HOT-MIX ASPHALT SURFACE REMOVAL, 2 1/4"	SO YD	2907	2907		
44201798	CLASS D PATCHES, TYPE I, 13 INCH	SO YD	445	445		
44201803	CLASS D PATCHES, TYPE II, 13 INCH	SO YD	455	455		

SUMMARY OF QUANTITIES			TOTAL QUANTITIES	CONSTRUCTION TYPE CODE		
CODE NO	ITEM	UNIT		100% STATE 0005		
44201807	CLASS D PATCHES, TYPE III, 13 INCH	SO YD	147	147		
44201809	CLASS D PATCHES, TYPE IV, 13 INCH	SO YD	108	108		
48101200	AGGREGATE SHOULDERS, TYPE B	TON	460	460		
67000500	ENGINEER'S FIELD OFFICE, TYPE B	CAL MO	2	2		
67100100	MOBILIZATION	L SUM	1	1		
70100450	TRAFFIC CONTROL AND PROTECTION, STANDARD 701201	L SUM	1	1		
70100460	TRAFFIC CONTROL AND PROTECTION, STANDARD 701306	L SUM	1	1		
70103815	TRAFFIC CONTROL SURVEILLANCE	CAL DA	4	4		
70300100	SHORT TERM PAVEMENT MARKING	FOOT	2992	2992		
70300220	TEMPORARY PAVEMENT MARKING - LINE 4"	FOOT	22740	22740		
70301000	WORK ZONE PAVEMENT MARKING REMOVAL	SO FT	247	247		
X 78001110	PAINT PAVEMENT MARKING - LINE 4"	FOOT	22740	22740		

X SPECIALTY ITEM

FILE NAME =	USER NAME = administrator	DESIGNED -	REVISED -
ct:\p\work\pav\dot\stef\enmk\d0270542\074533-shr-soq.dgn		DRAWN -	REVISED -
	PLOT SCALE = 100.0000' / 1" =	CHECKED -	REVISED -
	PLOT DATE = 12/8/2011	DATE -	REVISED -

STATE OF ILLINOIS
DEPARTMENT OF TRANSPORTATION

SUMMARY OF QUANTITIES

SCALE: NA SHEET NO. 1 OF 2 SHEETS STA. TO STA.

S.B.I. RTE.	SECTION	COUNTY	TOTAL SHEETS	SHEET NO.
11	07 HMA RESUR 2012-3	CLARK	11	3
CONTRACT NO. 74533				
ILLINOIS FED. AID PROJECT				

PROPOSED TYPICAL CROSS SECTION

STA. 5+06 TO STA. 62+16

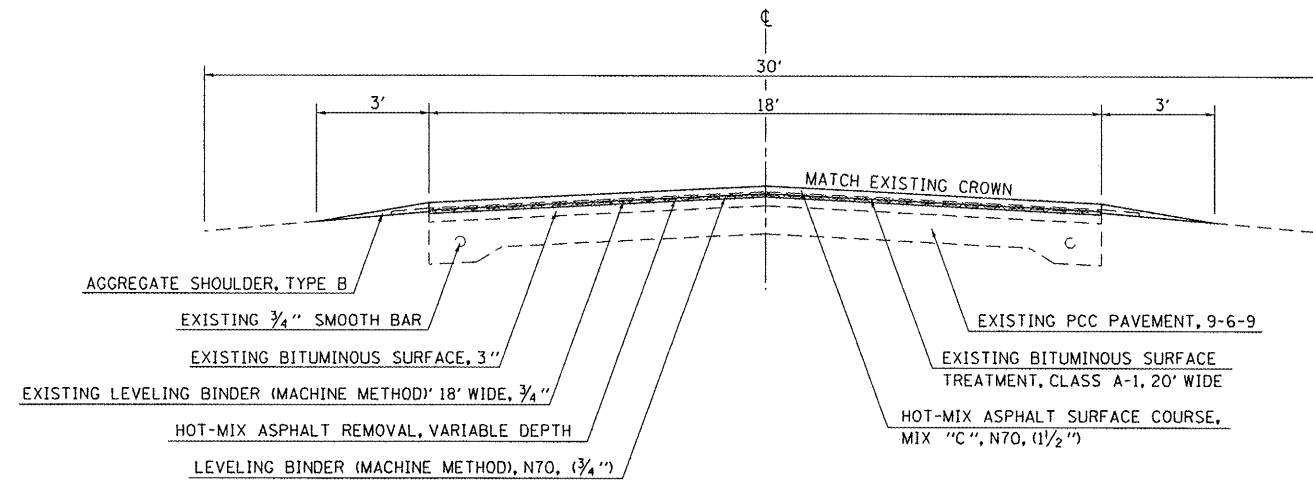

NOTE: NOT DRAWN TO SCALE

HOT-MIX ASPHALT REMOVAL, VARIABLE DEPTH

PROPOSED TYPICAL CROSS SECTION

(• SEE V-GUTTERS, HMA SHOULDERS TABLE)

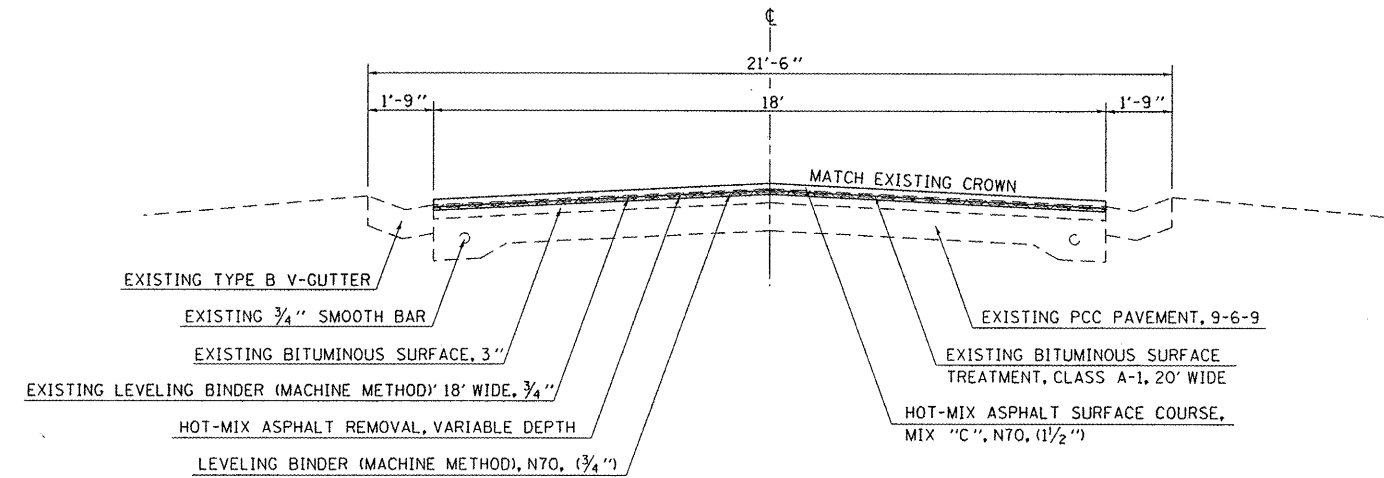

NOTE: NOT DRAWN TO SCALE

HOT-MIX ASPHALT REMOVAL, VARIABLE DEPTH

V-GUTTERS, HMA SHOULDERS TABLE

V-GUTTERS	
STATION	SIDE (WEST TO EAST)
STA. 44+49 TO STA. 48+71	LEFT
STA. 44+49 TO STA. 50+86	RIGHT
STA. 52+61 TO STA. 55+93	RIGHT
STA. 52+61 TO STA. 59+90	LEFT
STA. 74+79 TO STA. 79+85	LEFT

HMA SHOULDERS	
STATION	SIDE (WEST TO EAST)
STA. 58+16 TO STA. 62+22	RIGHT (3 FT.)
STA. 74+79 TO STA. 79+85	RIGHT (2 FT.)

* MILLING DEPTH INCREASED TO 2 1/4" IN V-GUTTER LOCATIONS. SEE MILLING DETAIL SHEET FOR MILLING TRANSITIONS.

FILE NAME =	USER NAME = administrator	DESIGNED -	REVISED -
ct:\pwwork\pwwork\stef\enmk\0270542\074533-shr-typicals.dgn		DRAWN -	REVISED -
		CHECKED -	REVISED -
		DATE -	REVISED -

**STATE OF ILLINOIS
DEPARTMENT OF TRANSPORTATION**

TYPICAL CROSS SECTIONS

SCALE: NA SHEET NO. 1 OF 2 SHEETS STA. TO STA.

S.B.I. RTE.	SECTION	COUNTY	TOTAL SHEETS	SHEET NO.
11	D7 HMA RESUR 2012-3	CLARK	11	5
CONTRACT NO. 74533				
ILLINOIS FED. AID PROJECT				

PROPOSED TYPICAL CROSS SECTION

STA. 62+16 TO STA. 73+98

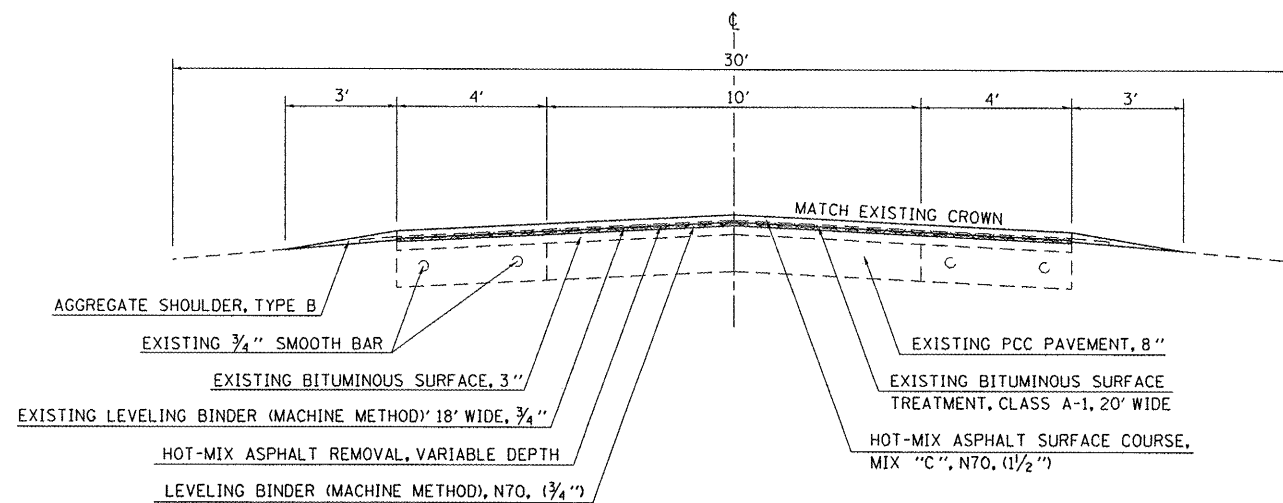

NOTE: NOT DRAWN TO SCALE

☒ HOT-MIX ASPHALT REMOVAL, VARIABLE DEPTH

PROPOSED TYPICAL CROSS SECTION

STA. 73+98 TO STA. 79+85

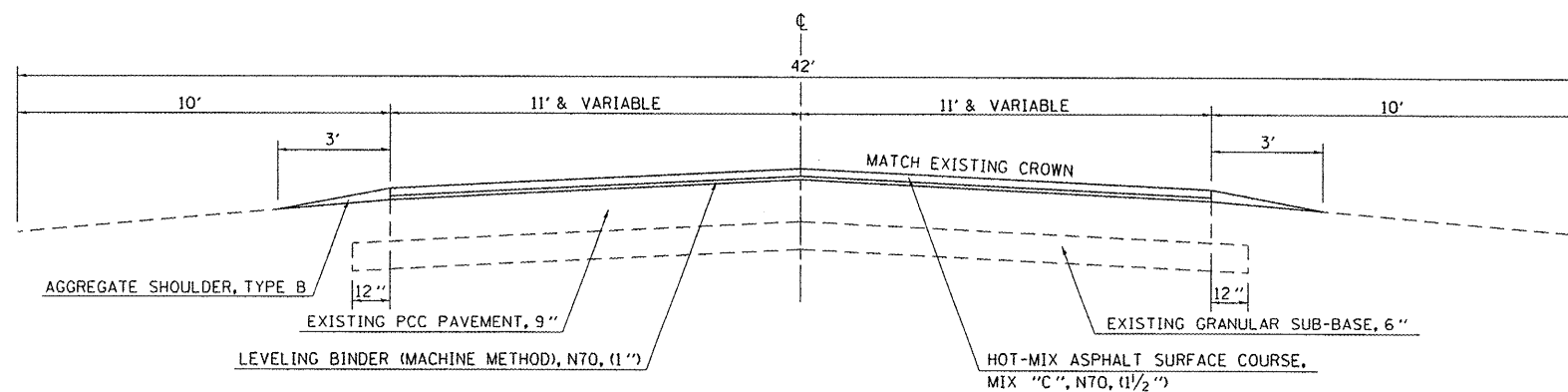

NOTE: NOT DRAWN TO SCALE

FILE NAME =	USER NAME = administrator	DESIGNED -	REVISED -
c:\pw-work\pwidot\stefhenk\d0270542\074533-shr-typicals.dgn		DRAWN -	REVISED -
PLOT SCALE = 100.0000' / 1"		CHECKED -	REVISED -
PLOT DATE = 12/8/2011		DATE -	REVISED -

STATE OF ILLINOIS
DEPARTMENT OF TRANSPORTATION

TYPICAL CROSS SECTIONS

SCALE: NA SHEET NO. 2 OF 2 SHEETS STA. TO STA.

S.B.I. RTE.	SECTION	COUNTY	TOTAL SHEETS	SHEET NO.
11	D7 HMA RESUR 2012-3	CLARK	11	6
CONTRACT NO. 74533			ILLINOIS FED. AID PROJECT	

PAVING SCHEDULE			LENGTH	AVERAGE PAVEMENT WIDTH	AREA	HOT-MIX ASPHALT SURFACE REMOVAL - BUTT JOINT	PORTLAND CEMENT CONCRETE SURFACE REMOVAL - BUTT JOINT	HOT-MIX ASPHALT SURFACE REMOVAL, VARIABLE DEPTH	HOT-MIX ASPHALT SURFACE REMOVAL, 2 1/4"	BITUMINOUS MATERIALS (PRIME COAT)	AGGREGATE (PRIME COAT)	HOT-MIX ASPHALT SURFACE COURSE, MIX "C", NTO	LEVELING BINDER (MACHINE METHOD), NTO	AGGREGATE SHOULDERS, TYPE B	TEMPORARY RAMP	EXCAVATING AND GRADING EXISTING SHOULDERS
STATION	TO	STATION	FOOT	FOOT	SO YD	SO YD	SO YD	SO YD	SO YD	GALLON	TON	TON	TON	TON	SO YD	UNIT
5+06.00	TO	5+41.00	35.0	18.0	70.0	70.0	0.0	0.0	0.0	7.0	0.1	6.7	1.5	2.7	10.0	0.7
5+41.00	TO	43+99.00	3858.0	18.0	7716.0	0.0	0.0	7716.0	0.0	771.6	15.4	738.1	324.1	298.8	0.0	77.2
43+99.00	TO	44+49.00	50.0	18.0	100.0	0.0	0.0	0.0	100.0	10.0	0.2	9.6	4.2	3.9	0.0	1.0
44+99.00	TO	50+86.00	587.0	18.0	1174.0	0.0	0.0	0.0	1174.0	117.4	2.3	98.6	49.3	0.0	15.0	0.0
50+86.00	TO	52+61.00	175.0	18.0	350.0	BRIDGE OMISSION										
52+61.00	TO	58+16.00	555.0	18.0	1110.0	0.0	0.0	0.0	1110.0	111.0	2.2	93.2	46.6	0.0	15.0	0.0
58+16.00	TO	59+90.00	174.0	21.0	406.0	0.0	0.0	0.0	406.0	40.6	0.8	34.1	17.1	0.0	0.0	0.0
59+90.00	TO	60+40.00	50.0	21.0	116.7	0.0	0.0	0.0	116.7	11.7	0.2	9.8	4.9	3.9	0.0	0.0
60+40.00	TO	62+22.00	182.0	21.0	424.7	0.0	0.0	424.7	0.0	42.5	0.8	35.7	17.8	14.1	0.0	0.0
62+22.00	TO	73+78.00	1156.0	18.0	2312.0	0.0	0.0	2312.0	0.0	231.2	4.6	221.2	97.1	87.2	0.0	23.1
73+78.00	TO	73+98.00	20.0	18.0	40.0	0.0	0.0	40.0	0.0	4.0	0.1	3.9	1.7	3.9	0.0	0.4
73+98.00	TO	74+79.00	81.0	18.0	162.0	0.0	0.0	0.0	0.0	16.2	0.3	15.5	9.1	6.3	0.0	1.6
74+79.00	TO	79+50.00	471.0	20.0	1046.7	0.0	0.0	0.0	0.0	104.7	2.1	87.9	58.6	36.5	0.0	0.0
79+50.00	TO	79+85.00	35.0	20.0	77.8	0.0	77.8	0.0	0.0	7.8	0.2	6.5	1.7	2.7	10.0	0.0
TOTALS			7429.0		15106.0	70	78	10493	2907	1476	29	1361	634	460	50.0	104

PAVEMENT MARKING SCHEDULE							
LOCATION			LENGTH	SHORT-TERM PAVEMENT MARKING	TEMPORARY PAVEMENT MARKING-LINE 4"	WORK ZONE PAVEMENT MARKING REMOVAL	PAINT PAVEMENT MARKING-LINE 4"
STATION	TO	STATION	FOOT	FOOT	FOOT	SO FT	FOOT
OLD US 40							
5+06.00	TO	12+20.00	714.0	285.6	2,320.5	23.6	2,320.5
12+20.00	TO	32+33.00	2,013.0	805.2	4,529.3	66.4	4,529.3
32+33.00	TO	42+62.00	1,029.0	411.6	3,344.3	34.0	3,344.3
42+62.00	TO	61+55.00	1,893.0	757.2	7,438.0	62.5	7,438.0
61+55.00	TO	72+47.00	1,092.0	436.8	3,549.0	36.0	3,549.0
72+47.00	TO	79+85.00	738.0	295.2	1,558.5	24.4	1,558.5
SHEET TOTALS			7,479	2,992	22,740	247	22,740

PATCHING SCHEDULE					
CLASS D PATCHES, TYPE 1, 13"	CLASS D PATCHES, TYPE 11, 13"	CLASS D PATCHES, TYPE 111, 13"	CLASS D PATCHES, TYPE 1V, 13"	PARTIAL DEPTH REMOVAL (VAR. DEPTH)	HOT-MIX ASPHALT FOR PATCHING
445 SQ. YD.	455 SQ. YD.	147 SQ. YD.	108 SQ. YD.	*750 SQ. YD.	*210 TON

* PATCH CENTERLINE STA. 74+05 TO STA. 79+85
 PATCH CRACK (5' FROM CENTERLINE) BOTH LANES
 STA. 61+95 TO STA. 74+05
 ADDITIONAL SMALL ISOLATED PATCHES

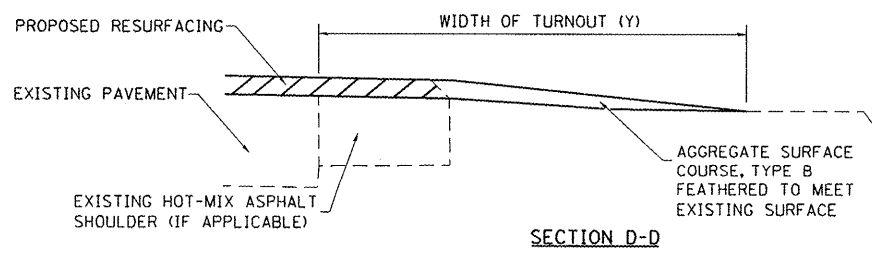
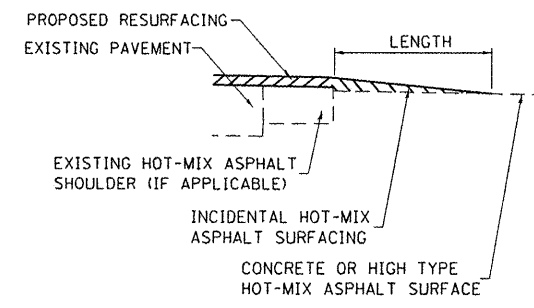
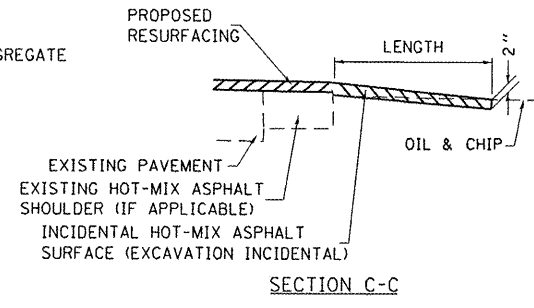
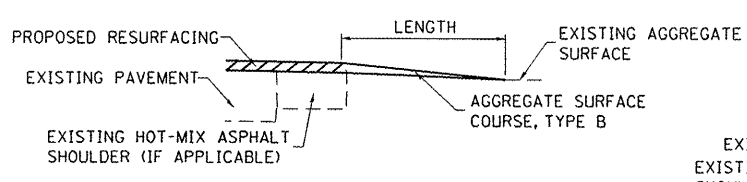
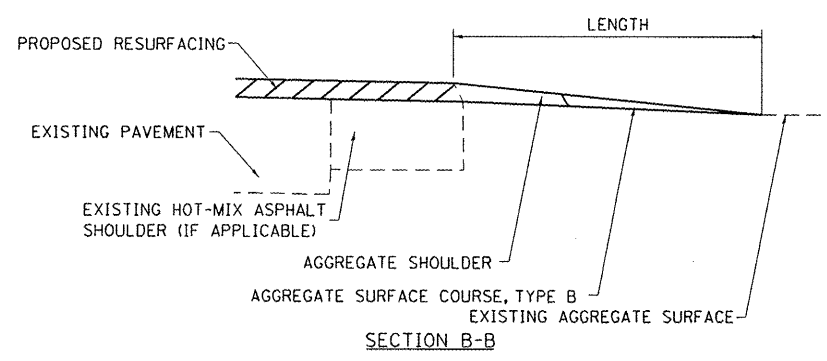
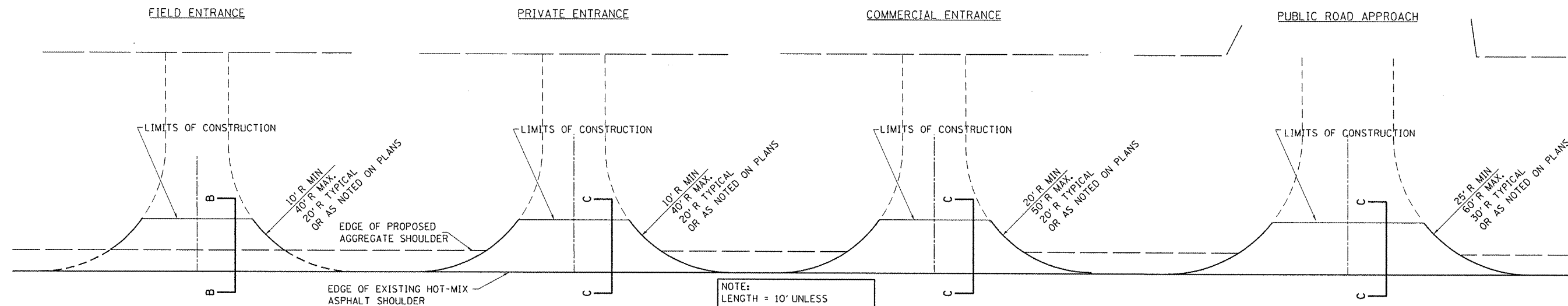

TYPICAL SECTION AT MAILBOX TURNOUT
NOTE: SEE STANDARD 406201 FOR MAILBOX TURNOUT DETAILS

NOTES

THE COST OF THE ASPHALT MATERIALS, AND AGGREGATE (PRIME COAT) FOR ENTRANCES AND PUBLIC ROADS AND APPROACHES SHALL BE INCLUDED IN THE PAY ITEM INCIDENTAL HOT-MIX ASPHALT SURFACING.

THE COST OF EXCAVATION IS INCLUDED IN THE PAY ITEM INCIDENTAL HOT-MIX ASPHALT SURFACING.

IF THERE IS NOT EXISTING HOT-MIX ASPHALT SHOULDER THEN THE ENTRANCE TAPER STARTS AT THE EDGE OF EXISTING PAVEMENT.

THE COST OF THE BITUMINOUS MATERIALS AND AGGREGATE (PRIME COAT) FOR ENTRANCES AND PUBLIC ROAD APPROACHES SHALL BE INCLUDED IN THE PAY ITEM INCIDENTAL HOT-MIX ASPHALT SURFACING.

SIDE	STATION	TYPE	INCIDENTAL HOT-MIX ASPHALT SURFACING	
			TON	TON
LT	6+59	PE		4.7
LT	14+53	FE		2.3
LT	26+83	PE		7.5
RT	26+83	FE		2.1
LT	39+65	PE		4.3
LT	50+29	PRA	8	
RT	58+16	FE		9.2
LT	62+04	PE		2.8
RT	62+22	FE/MBT		2.2
RT	64+14	PE		2.5
RT	6533	FE		2.7
LT	68+49	PE		2.6
RT	69+65	FE/MBT		2.6
RT	77+78	PRA	6.5	
TOTALS			15	46

FE=FIELD ENTRANCE PRA - PUBLIC ROAD APPROACH
PE=PRIVATE ENTRANCE MBT - MAILBOX TURNOUT
CE=COMMERCIAL ENTRANCE

FILE NAME =	USER NAME = administrator	DESIGNED - 08-03-99	REVISED - 03-13-07
et:\p\work\p\ridot\stefanmk\d0270542\074533-shr-sch.dgn		DRAWN -	REVISED -
	PLOT SCALE = 100.0000 "/> <td>CHECKED -</td> <td>REVISED -</td>	CHECKED -	REVISED -
	PLOT DATE = 12/8/2011	DATE -	REVISED -

**STATE OF ILLINOIS
DEPARTMENT OF TRANSPORTATION**

**RURAL ENTRANCE SCHEDULE AND MAILBOX TURNOUT DETAILS
WITH SHOULDERS**

SCALE: NA SHEET NO. 1 OF 1 SHEETS STA. TO STA.

S.B.I. RTE.	SECTION	COUNTY	TOTAL SHEETS	SHEET NO.
11	D7 HMA RESUR 2012-3	CLARK	11	8
CONTRACT NO. 74533				
FED. ROAD DIST. NO. ILLINOIS FED. AID PROJECT				

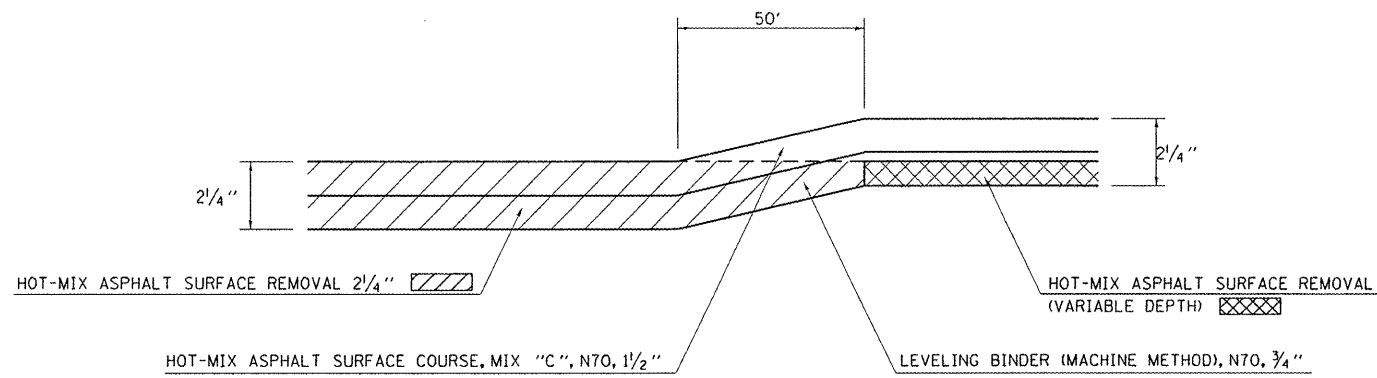

MILLING TRANSITION DETAIL FROM VAR. DEPTH TO 2 1/4"

STA. 43+99 TO STA. 44+49
STA. 59+90 TO STA. 60+40

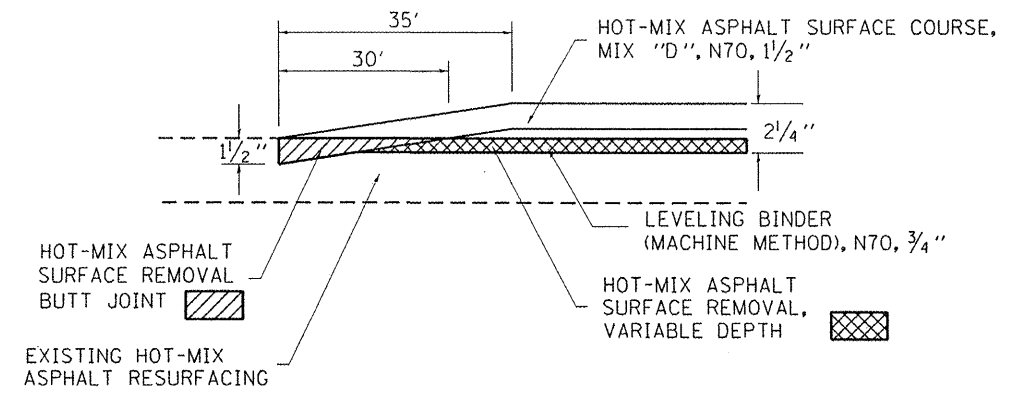

HOT-MIX ASPHALT BUTT JOINT DETAIL

STA. 5+06 TO STA. 5+41

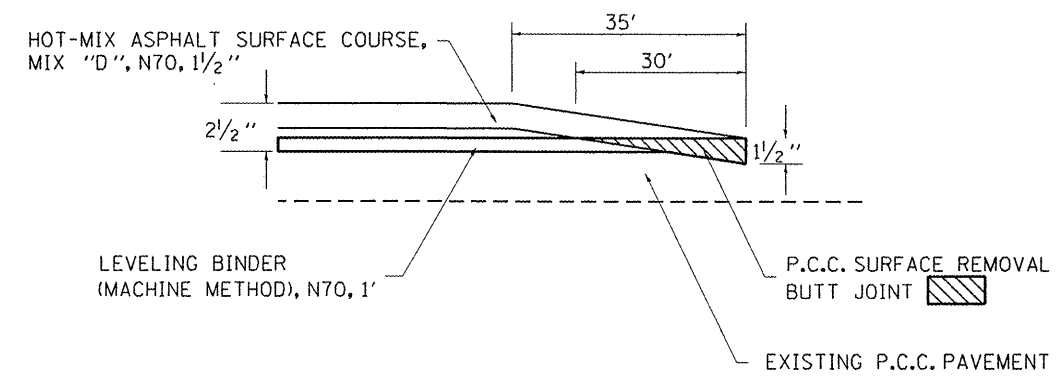

P.C.C. BUTT JOINT DETAIL

STA. 79+50 TP STA. 79+85

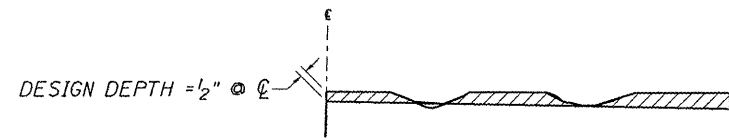

NOTES:

1. MILLING SHALL BE DONE TO ATTAIN A 3/16 "/FT. SLOPE IN CROWN SECTIONS
2. EXISTING S.E. AND S.E. TRANSITIONS SHALL BE MAINTAINED UNLESS OTHERWISE SHOWN ON THE PLANS.
3. MILLING TO THE BOTTOM OF WHEEL RUTS SHALL NOT BE NECESSARY UNLESS REQUIRED TO OBTAIN SLOPE OR THE DESIGN DEPTH AT CENTERLINE.
4. THE AVERAGE DEPTH OF MILLING IS ESTIMATED TO BE 1/2" BUT MAY VARY IN ISOLATED LOCATIONS.

HOT-MIX ASPHALT SURFACE REMOVAL (VARIABLE DEPTH) DETAIL

STA. 5+41 TO STA. 43+99
STA. 60+40 TO STA. 73+78

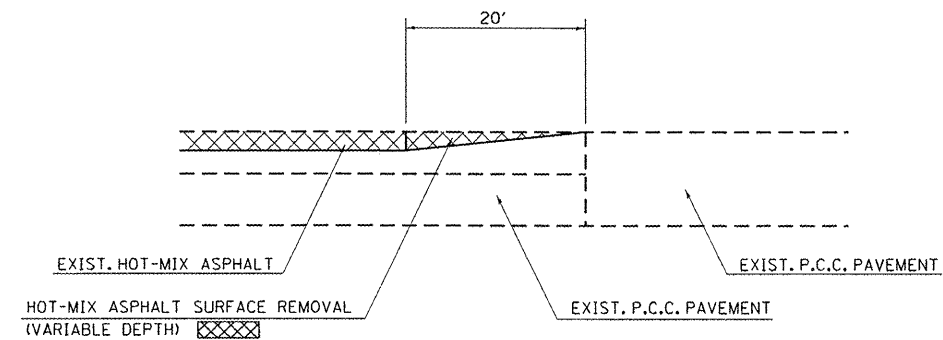

MILLING TRANSITION DETAIL FROM VAR. DEPTH TO 0"

STA. 73+78 TO STA. 73+98

FILE NAME =	USER NAME = administrator	DESIGNED -	REVISED -
c:\p\work\p\p\dot\stef\enmk\d0270542\ND74533-sht-details.dgn		DRAWN -	REVISED -
		CHECKED -	REVISED -
		DATE -	REVISED -

**STATE OF ILLINOIS
DEPARTMENT OF TRANSPORTATION**

MILLING DETAILS		
SCALE: NA	SHEET NO. 1 OF 1 SHEETS	STA. TO STA.

S.B.I. RTE.	SECTION	COUNTY	TOTAL SHEETS	SHEET NO.
11	D7 HMA RESUR 2012-3	CLARK	11	9
			CONTRACT NO. 74533	
ILLINOIS FED. AID PROJECT				

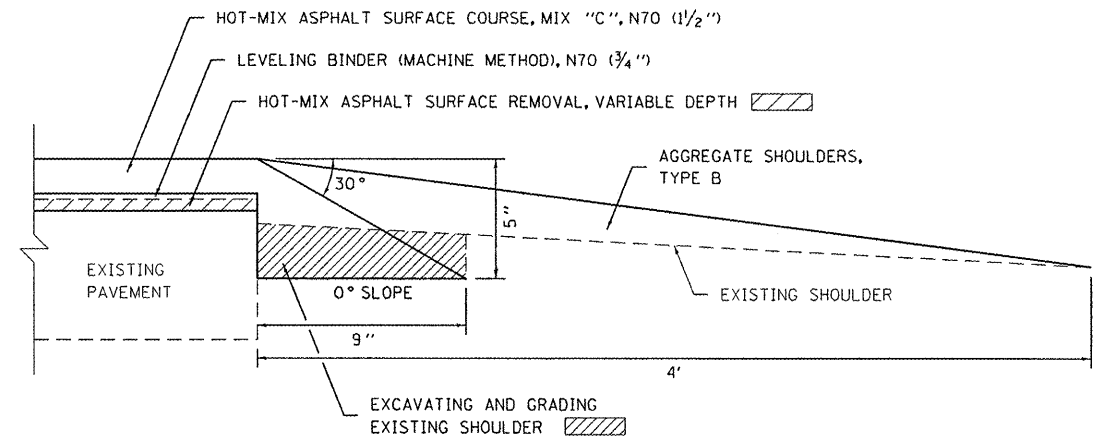

SAFETY EDGE FOR 3P RESURFACING

FILE NAME =	USER NAME = administrator	DESIGNED -	REVISED -
c:\pwork\pvidot\steffenk\d0270542\074533-shd-details.dgn		DRAWN -	REVISED -
	PLOT SCALE = 40.0000" / 1"	CHECKED -	REVISED -
	PLOT DATE = 12/8/2011	DATE -	REVISED -

STATE OF ILLINOIS
DEPARTMENT OF TRANSPORTATION

JOB DETAILS

SCALE: NA SHEET NO. 1 OF 1 SHEETS STA. TO STA.

S.B.I. RTE.	SECTION	COUNTY	TOTAL SHEETS	SHEET NO.
11	D7 HMA RESUR 2012-3	CLARK	11	10
CONTRACT NO. 74533				
ILLINOIS FED. AID PROJECT				

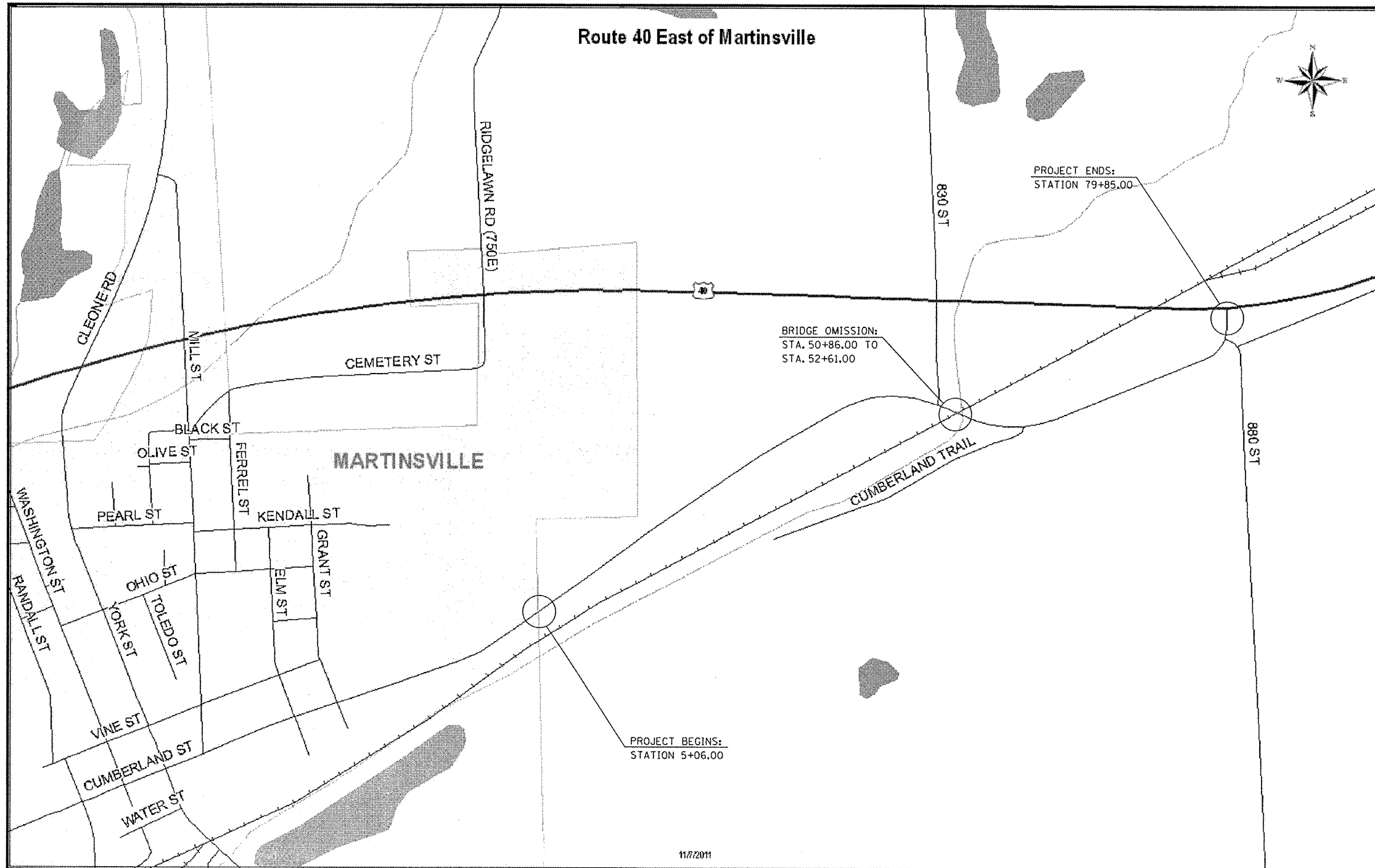

FILE NAME =	USER NAME = administrator	DESIGNED -	REVISED -
c:\pvc\work\puidot\stefFennk\00270542\074533-LocMap.dgn	74533-LocMap.dgn	DRAWN -	REVISED -
PLOT SCALE = 100.0000' / in.		CHECKED -	REVISED -
PLOT DATE = 12/8/2011		DATE -	REVISED -

**STATE OF ILLINOIS
DEPARTMENT OF TRANSPORTATION**

LOCATION MAP	
SCALE: NA	SHEET NO. 1 OF 1 SHEETS
STA. TO STA.	

S.B.I. RTE.	SECTION	COUNTY	TOTAL SHEETS	SHEET NO.
11	D7 HMA RESUR 2012-3	CLARK	11	11
CONTRACT NO. 74533				
ILLINOIS FED. AID PROJECT				