

**TYPICAL SECTION
STAGE 2 CONSTRUCTION
(LOOKING EAST)**

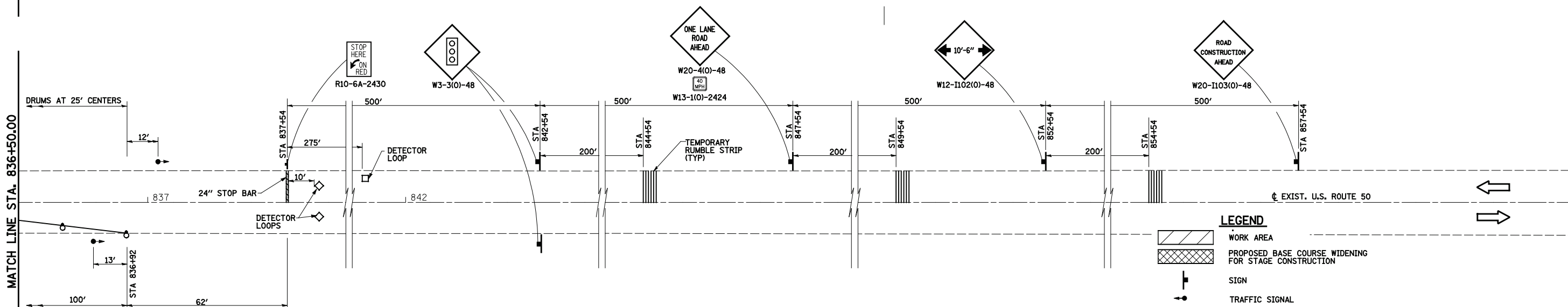
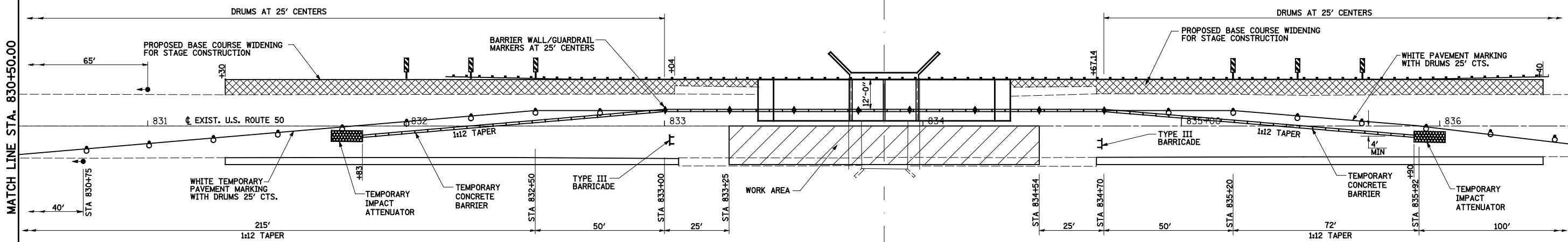
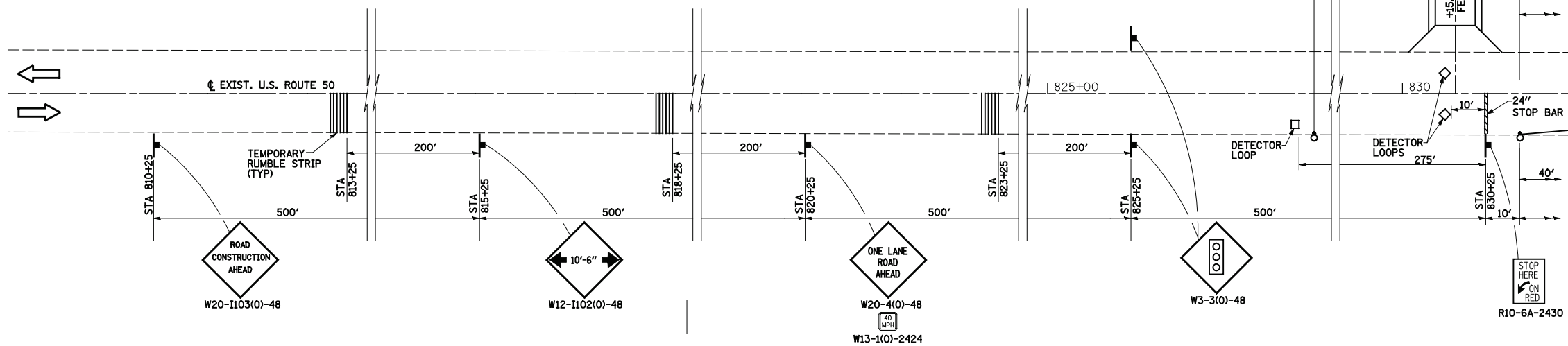

LEGEND

- WORK AREA
- PROPOSED BASE COURSE WIDENING FOR STAGE CONSTRUCTION
- SIGN
- TRAFFIC SIGNAL
- INDUCTION LOOP DETECTOR
- DOUBLE VERTICAL PANEL
- DRUMS WITH BI-DIRECTIONAL STEADY BURNING LIGHTS
- TYPE C BIDIRECTIONAL REFLECTORS

NOTE:
SEE STANDARD 701321 FOR DETAILS NOT SHOWN ON PLANS.
SEE MISCELLANEOUS DETAIL SHEET FOR SAND MODULE IMPACT ATTENUATOR LAYOUT.



FILE NAME = #FILEL#	USER NAME = Paul	DESIGNED - JLS	REVISED -	STATE OF ILLINOIS DEPARTMENT OF TRANSPORTATION	STAGE CONSTRUCTION DETAILS STAGE 2, US ROUTE 50		F.A.P. RTE. 327	SECTION 20BR	COUNTY CLINTON	TOTAL SHEETS 51	SHEET NO. 15
	PLOT SCALE = 40.0000' / IN.	CHECKED - BRM	REVISED -		SCALE: 1"=20'	SHEET NO. 2 OF 2 SHEETS	STA. 810+25.00 TO STA. 857+52.00	CONTRACT NO. 76B43		ILLINOIS FED. AID PROJECT	
PLOT DATE = 12/8/2011	DATE - 02-08-11	REVISOR -	REVISOR -								