

NORTH EDGE OF SHOULDER

Location	Station	Offset	Theoretical Grade Elevations
End of West Approach	833+42.17	-18.00	461.81
A	833+52.17	-18.00	461.84
B	833+62.17	-18.00	461.86
☉ of West Exterior Wall	833+72.17	-18.00	461.88

NORTH EDGE OF PAVEMENT

Location	Station	Offset	Theoretical Grade Elevations
End of West Approach	833+42.17	-12.00	461.93
A	833+52.17	-12.00	461.96
B	833+62.17	-12.00	461.98
☉ of West Exterior Wall	833+72.17	-12.00	462.00

STAGE CONSTRUCTION LINE

Location	Station	Offset	Theoretical Grade Elevations
End of West Approach	833+42.17	-2.00	462.08
A	833+52.17	-2.00	462.11
B	833+62.17	-2.00	462.13
☉ of West Exterior Wall	833+72.17	-2.00	462.15

☉ US RTE. 50 & PROFILE GRADE

Location	Station	Offset	Theoretical Grade Elevations
End of West Approach	833+42.17	0.00	462.11
A	833+52.17	0.00	462.14
B	833+62.17	0.00	462.16
☉ of West Exterior Wall	833+72.17	0.00	462.18

SOUTH EDGE OF PAVEMENT

Location	Station	Offset	Theoretical Grade Elevations
End of West Approach	833+42.17	12.00	461.93
A	833+52.17	12.00	461.96
B	833+62.17	12.00	461.98
☉ of West Exterior Wall	833+72.17	12.00	462.00

SOUTH EDGE OF SHOULDER

Location	Station	Offset	Theoretical Grade Elevations
End of West Approach	833+42.17	18.00	461.81
A	833+52.17	18.00	461.84
B	833+62.17	18.00	461.86
☉ of West Exterior Wall	833+72.17	18.00	461.88

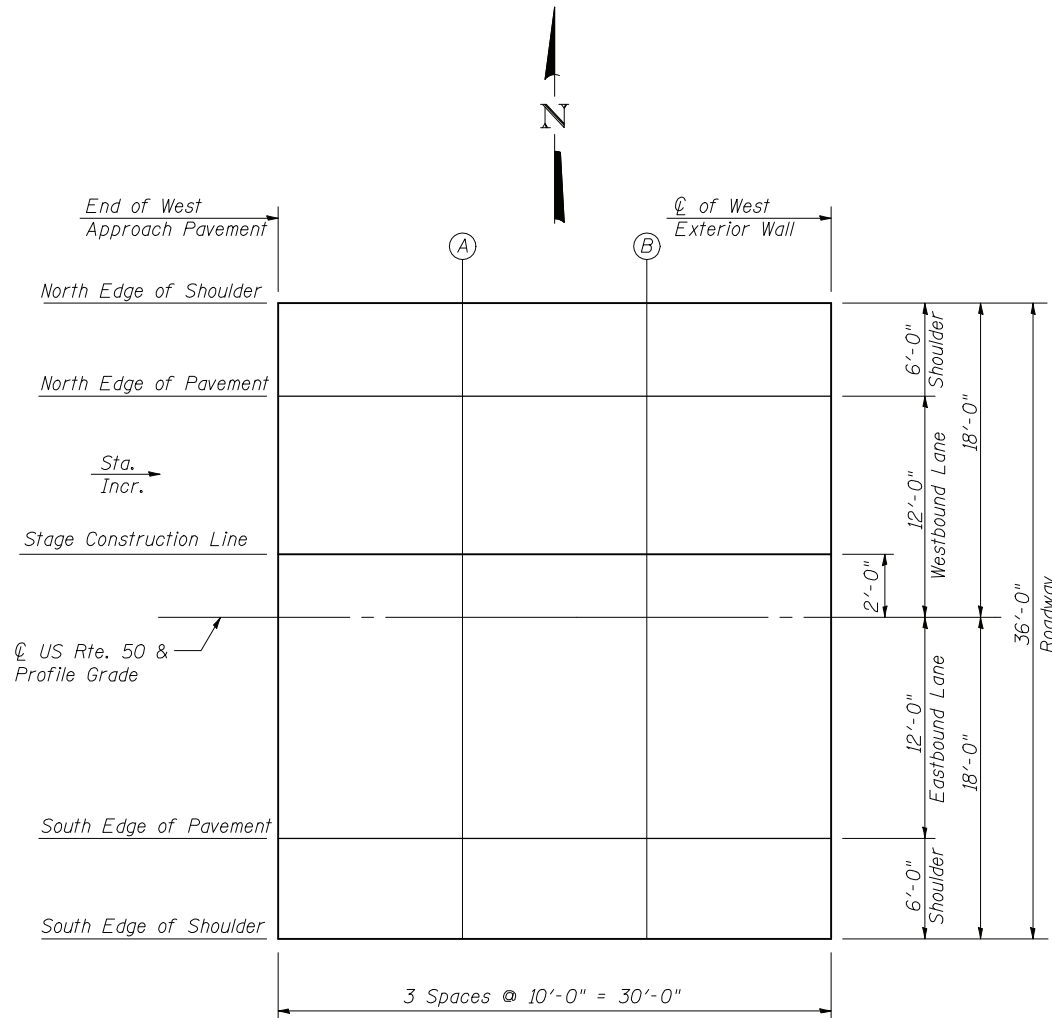

PLAN