

NORTH EDGE OF SHOULDER

Location	Station	Offset	Theoretical Grade Elevations
☉ of East Exterior Wall	833+97.83	-18.00	461.89
A	834+07.83	-18.00	461.89
B	834+17.83	-18.00	461.88
End of East Approach	834+27.83	-18.00	461.88

NORTH EDGE OF PAVEMENT

Location	Station	Offset	Theoretical Grade Elevations
☉ of East Exterior Wall	833+97.83	-12.00	462.01
A	834+07.83	-12.00	462.01
B	834+17.83	-12.00	462.00
End of East Approach	834+27.83	-12.00	462.00

STAGE CONSTRUCTION LINE

Location	Station	Offset	Theoretical Grade Elevations
☉ of East Exterior Wall	833+97.83	-2.00	462.16
A	834+07.83	-2.00	462.16
B	834+17.83	-2.00	462.15
End of East Approach	834+27.83	-2.00	462.15

☉ US RTE. 50 & PROFILE GRADE

Location	Station	Offset	Theoretical Grade Elevations
☉ of East Exterior Wall	833+97.83	0.00	462.19
A	834+07.83	0.00	462.19
B	834+17.83	0.00	462.18
End of East Approach	834+27.83	0.00	462.18

SOUTH EDGE OF PAVEMENT

Location	Station	Offset	Theoretical Grade Elevations
☉ of East Exterior Wall	833+97.83	12.00	462.01
A	834+07.83	12.00	462.01
B	834+17.83	12.00	462.00
End of East Approach	834+27.83	12.00	462.00

SOUTH EDGE OF SHOULDER

Location	Station	Offset	Theoretical Grade Elevations
☉ of East Exterior Wall	833+97.83	18.00	461.89
A	834+07.83	18.00	461.89
B	834+17.83	18.00	461.88
End of East Approach	834+27.83	18.00	461.88

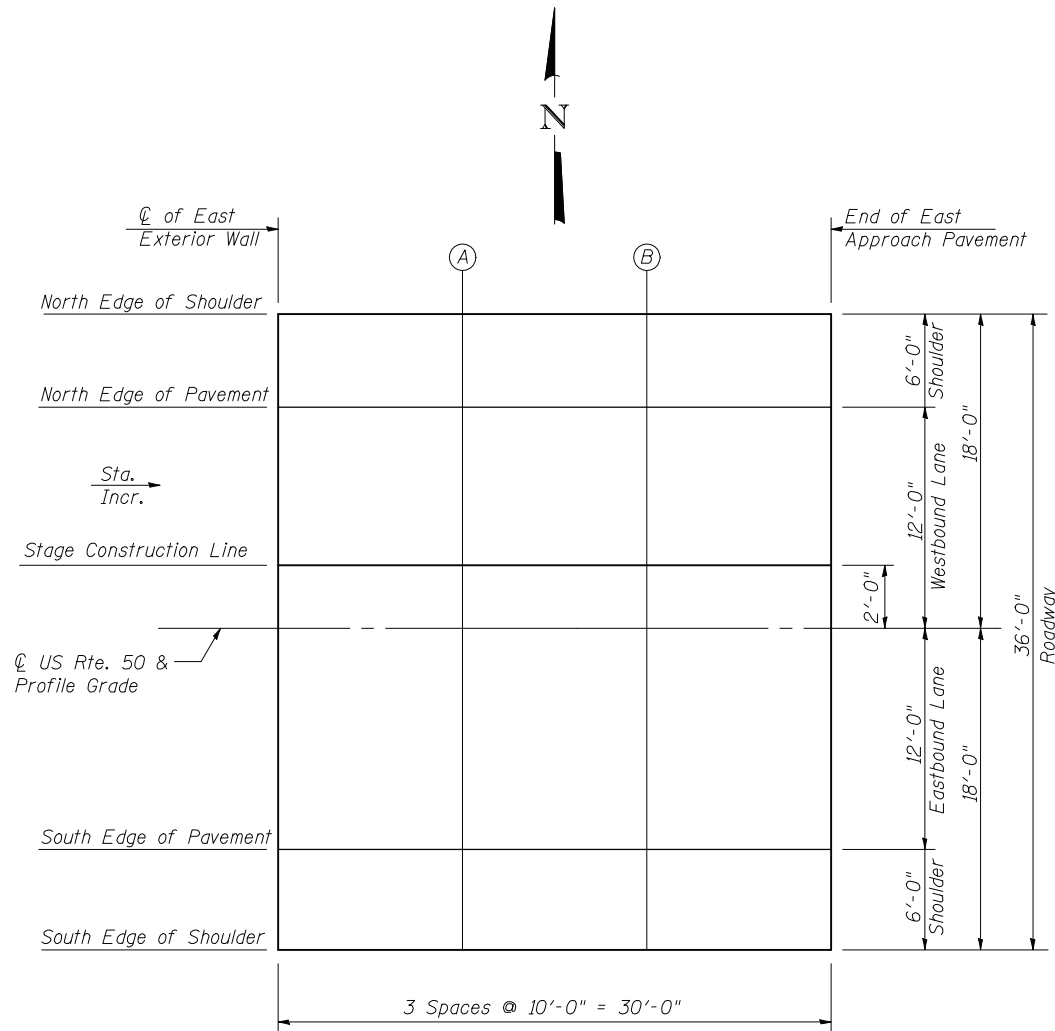

PLAN