

**SOUTHBOUND**  
 STA. 183+95.69 TO STA. 190+45  
 STA. 196+15 TO STA. 204+88

**NORTHBOUND**  
 STA. 183+95.69 TO STA. 192+92  
 STA. 198+52 TO STA. 203+00.00

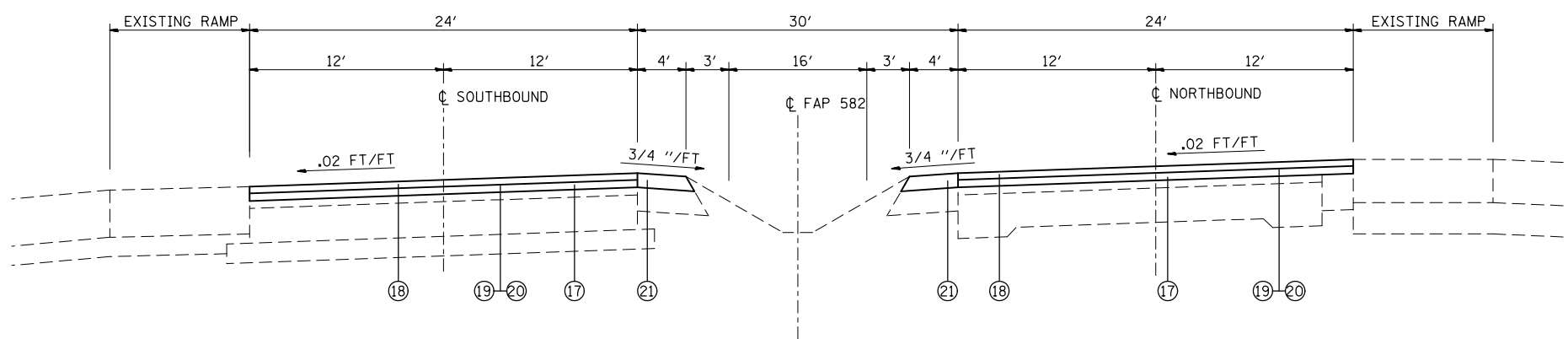

**SOUTHBOUND**  
 STA. 190+45 TO STA. 196+15

**NORTHBOUND**  
 STA. 192+92 TO STA. 196+39.26  
 \*\*STA. 196+39.26 TO STA. 198+01.04  
 STA. 198+01.04 TO STA. 198+52  
 (\*\*SEE DETAIL A-A)

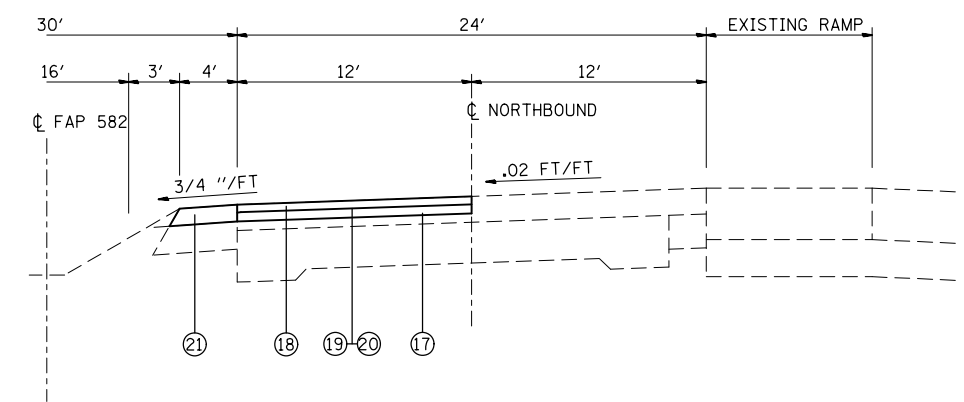

**DETAIL A-A**  
 NORTHBOUND ONLY  
 \*\*STA. 196+39.26 TO STA. 198+01.04

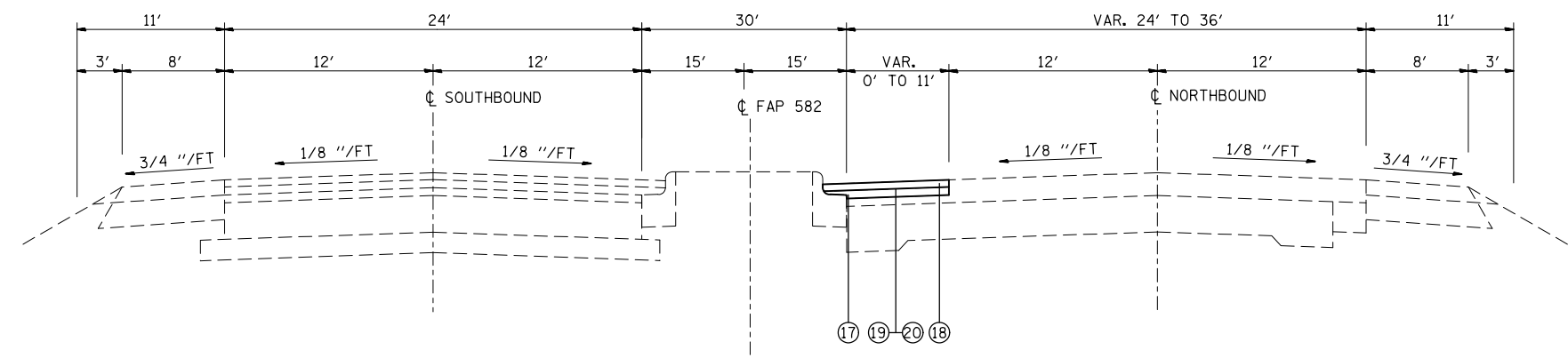

**SOUTHBOUND**  
 STA. 204+88 TO STA. 207+41

**NORTHBOUND**  
 STA. 203+00 TO STA. 207+41

- LEGEND**
- ⑰ PROPOSED POLY-LEVELING BINDER (MM) N50, 3/4"
  - ⑱ PROPOSED POLY-HMA SURFACE COURSE, MIX E, N90, 1 1/2"
  - ⑲ PROPOSED BITUMINIOUS MATERIAL (PRIME COAT)
  - ⑳ PROPOSED AGGREGATE (PRIME COAT)
  - ㉑ PROPOSED HMA SHOULDERS 2 1/4"
  - ㉒ PROPOSED AGGREGATE WEDGE SHOULDER
  - ㉓ PROPOSED SHOULDER RUMBLE STRIP

FILE NAME =	USER NAME = milleraj	DESIGNED -	REVISED -	<b>STATE OF ILLINOIS DEPARTMENT OF TRANSPORTATION</b>	<b>PROPOSED TYPICAL SECTIONS</b>				F.A.P. RTE.	SECTION	COUNTY	TOTAL SHEETS	SHEET NO.
et:\pw\work\p\dot\milleraj\d0260814\d876e96-sht-plan.dgn	PLOT SCALE = 100.0000' / in.	DRAWN -	REVISED -						582	(6-3, 6-1)RS-3	MADISON	66	13
	PLOT DATE = 12/16/2011	CHECKED -	REVISED -		SCALE: SHEET NO. OF SHEETS STA. TO STA.				CONTRACT NO. 76E96				
		DATE -	REVISED -						FED. ROAD DIST. NO. ILLINOIS FED. AID PROJECT				