

ONE-WAY CRYSTAL RAISED REFLECTIVE
PAVEMENT MARKERS @ 80' CTRS

4" WHITE CENTER SKIP-DASH
LINE 10'-30"

4" WHITE EDGE LINE

4" YELLOW EDGE LINE

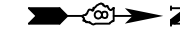

MATCHLINE STA. 152+00

MATCHLINE STA. 157+00

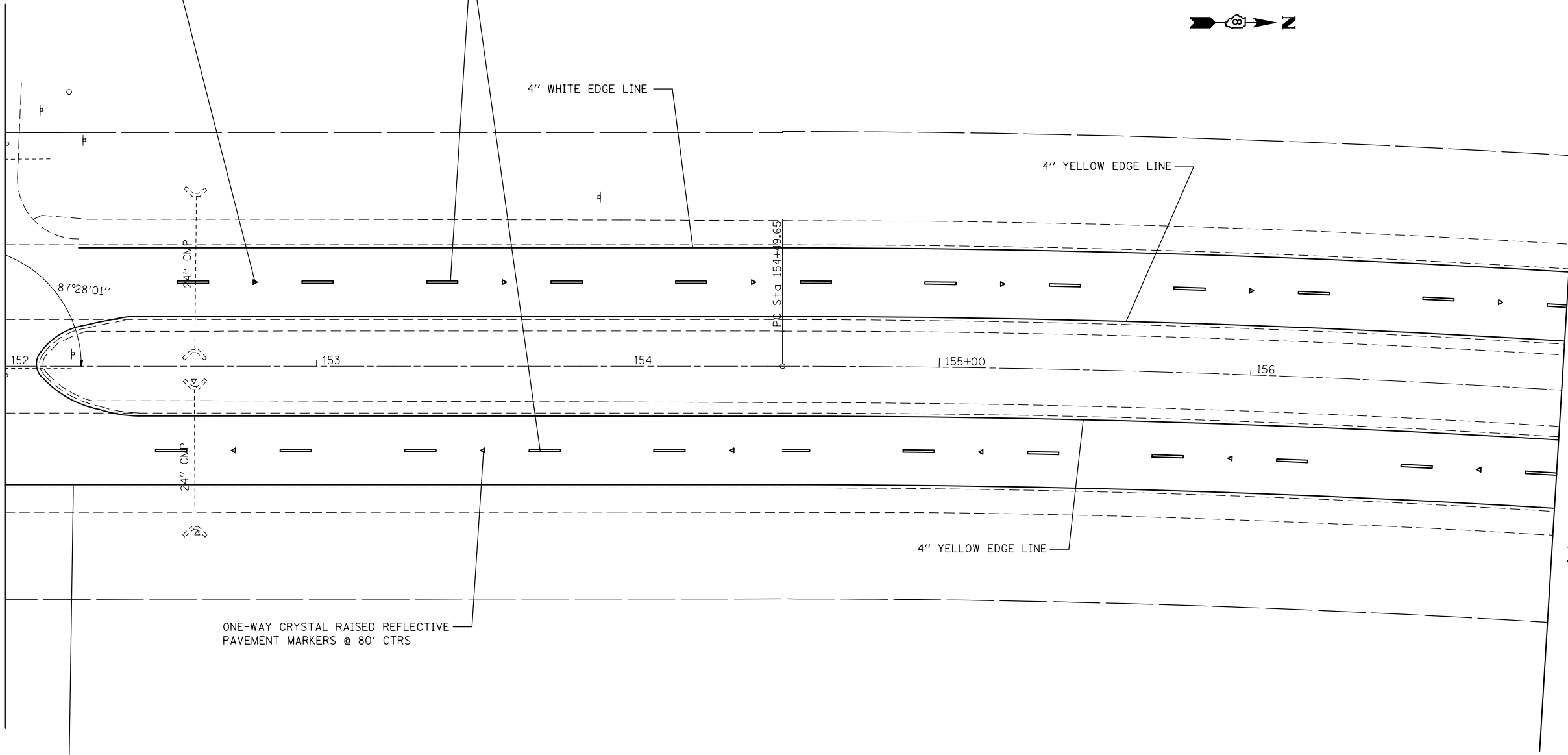

ONE-WAY CRYSTAL RAISED REFLECTIVE
PAVEMENT MARKERS @ 80' CTRS

4" WHITE EDGE LINE

4" YELLOW EDGE LINE

FILE NAME =	USER NAME = milleraj	DESIGNED -	REVISED -
et:\pw\work\p\dot\milleraj\d0260814\d876e96-sht-plan.dgn		DRAWN -	REVISED -
	PLOT SCALE = 40.0000' / in.	CHECKED -	REVISED -
	PLOT DATE = 12/16/2011	DATE -	REVISED -

**STATE OF ILLINOIS
DEPARTMENT OF TRANSPORTATION**

PAVEMENT_MARKING_SHEETS

SCALE: 20 SHEET NO. 13 OF 24 SHEETS STA. 152+00 TO STA. 157+00

F.A.P. RTE.	SECTION	COUNTY	TOTAL SHEETS	SHEET NO.
582	(6-3,-6-1)RS-3	MADISON	66	50
CONTRACT NO. 76E96				
ILLINOIS FED. AID PROJECT				