

SN 082-0221 was originally built in 1981 as FAI 270 Section 82-6B-(B);(FE);(D);(P)
 It consists of 14 plate girder spans on pile bent abutments and multi-column piers, with
 joints at both abutments, and at the pin and links adjacent to piers 3, 7, and 11.
 In 2004 the original neoprene joints were replaced with finger plates with troughs.
 The beam ends, bearings, pin and links, and crossframes at each joint shall be cleaned and painted.
 The finger plate trough plates shall be repaired.

GENERAL NOTES

All new fasteners shall be high strength bolts. Bolts $\frac{3}{8}$ " ϕ , open holes $\frac{7}{16}$ " ϕ , unless otherwise noted.

Plan dimensions and details relative to existing structure have been taken from existing plans and are subject to nominal construction variations. It shall be the Contractor's responsibility to verify such dimensions and details in the field and make necessary approved adjustments prior to construction or ordering materials. Such variations shall not be cause for additional compensation for a change in the scope of the work, however, the Contractor will be paid for the quantity actually furnished at the unit price bid

The existing structural steel coating contains lead. The Contractor shall take appropriate precautions to deal with the presence of lead on this project.

Location 1 is SN 082-0221. There are no other bridges on this contract.

At location 1, cleaning and painting of the existing structural steel and bearings shall be as specified in the special provisions for "Cleaning and Painting Existing Steel Structures." All plate girders within 5' of ϕ bearings at abutments and within 10' of ϕ pin and links at piers 3, 7, and 11 shall be painted (measured along girder). All bearings at abutments and piers 3, 7, and 11 shall be cleaned and painted. All crossframes parallel, and adjacent to the joints shall be cleaned and painted. All pin and links shall also be cleaned and painted. The existing steel and bearings shall be cleaned per "Near White Metal Blast Cleaning SSPC-SP10". The existing steel and bearings shall be painted according to the requirements of "Paint system 1 - OZ/E/U". The color of the final finish coat for all surfaces shall be similar to the existing color, and will be at the discretion of the Engineer.

A minimum of two air monitors will be required to monitor abrasive blasting operation. See special provisions for "Containment and Disposal of Lead Paint Cleaning Residues".

The SSPC-QP1 and SSPC-QP2 certifications will be required.

All trough repairs specified with Details A-H on sheet 3 shall be included with the pay item "Clean Trough".

Cost of removal and re-installation of all members necessary to complete the work as detailed on the plans and as specified in the Special Provisions shall be included with Clean Trough.

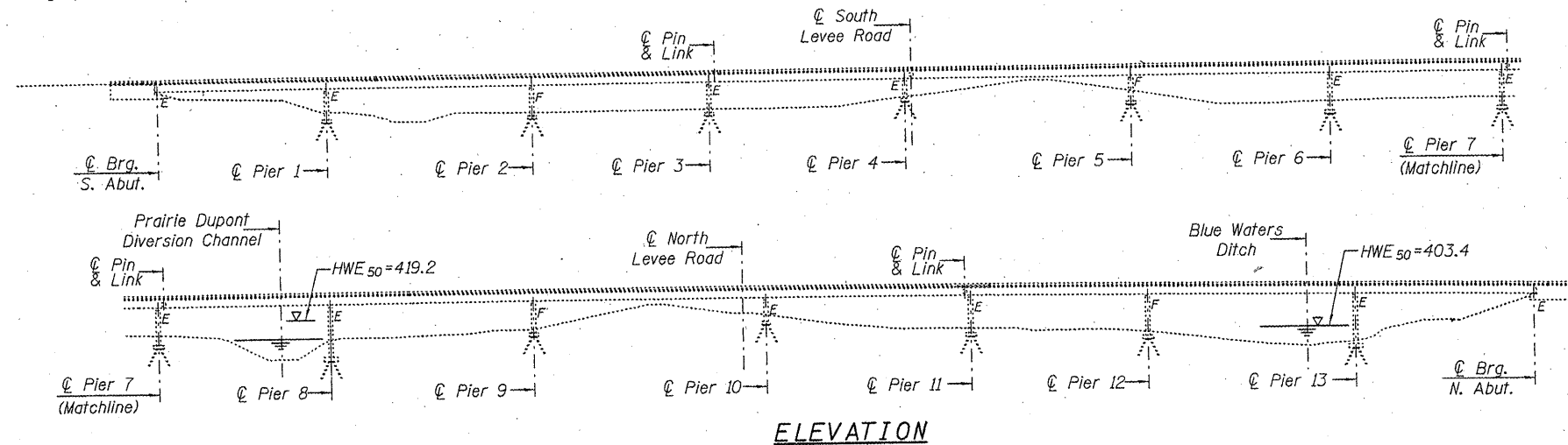

ELEVATION

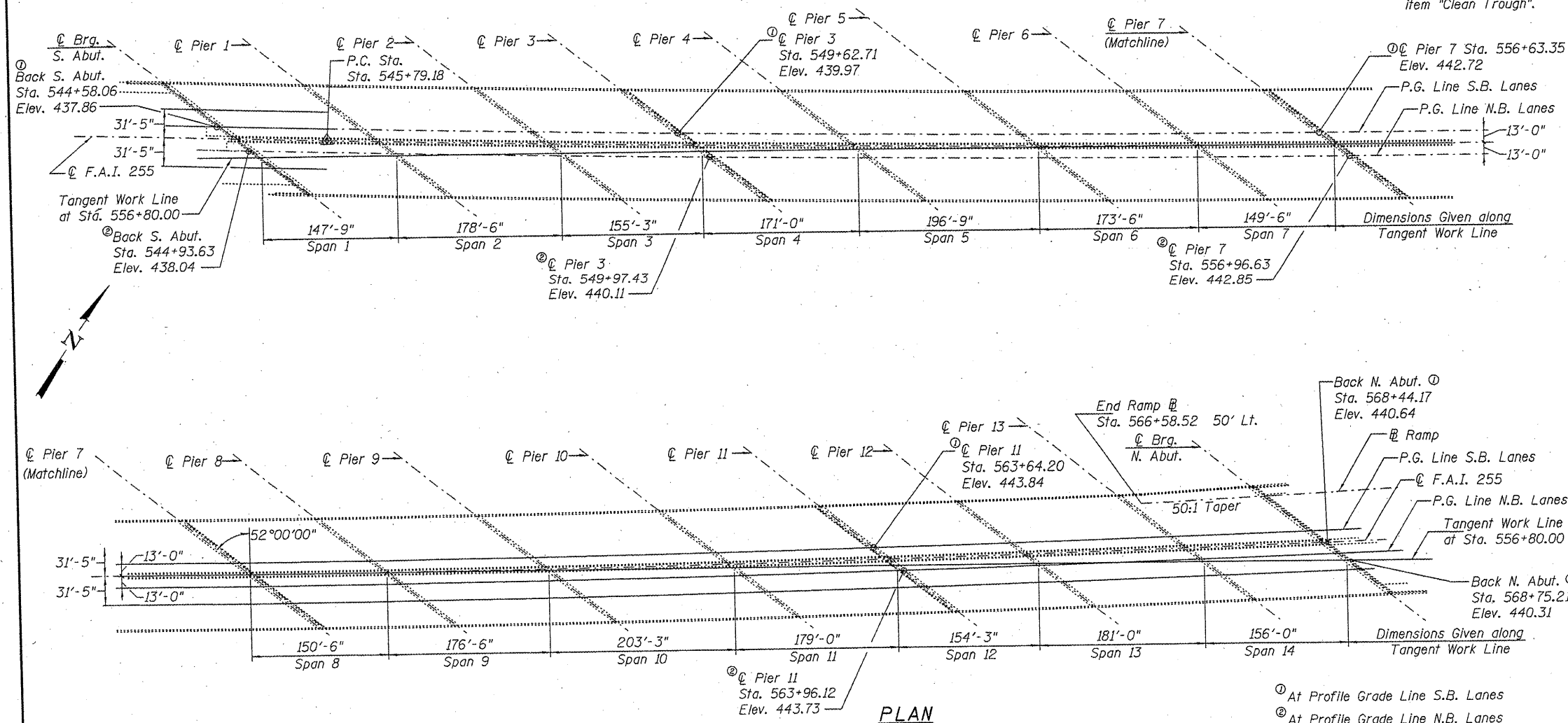

PLAN

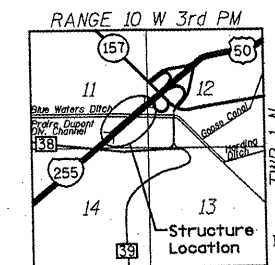

LOCATION SKETCH

TOTAL BILL OF MATERIAL

ITEM	UNIT	TOTAL
Cleaning and Painting Steel Bridge No. 1	L. Sum	1
C & D of Lead Paint Cleaning Residues No. 1	L. Sum	1
Clean Trough	Each	5

DESIGNED - J. Uehle	EXAMINED	DATE - March 9, 2012
CHECKED - B. Williams	PASSED	
DRAWN - J. Uehle		
CHECKED - B. Williams		

STATE OF ILLINOIS
 DEPARTMENT OF TRANSPORTATION

GENERAL PLAN AND ELEVATION
 SN 082-0221

SHEET NO. 1 OF 16 SHEETS

F.A.I. RTE. 255	SECTION 82-6B-1	COUNTY ST. CLAIR	TOTAL SHEETS 18	SHEET NO. 3
				CONTRACT NO. 76F44
ILLINOIS FED. AID PROJECT				