

LEGEND

- POLYMERIZED HOT-MIX ASPHALT SURFACE COURSE, MIX E, N105 (1 1/2")
- POLYMERIZED HOT-MIX ASPHALT BINDER COURSE, N105, IL-19.0 (2 3/4")
- HOT-MIX ASPHALT BINDER COURSE, N90, IL-19.0 (7")
- SUB-BASE GRANULAR MATERIAL TYPE A, 12"
- PORTLAND CONCRETE CEMENT SHOULDERS, 9 1/4"
- POLYMERIZED HOT-MIX ASPHALT SURFACE COURSE, MIX E, N105 (1 1/2")
- POLYMERIZED HOT-MIX ASPHALT BINDER COURSE, N105, IL-19.0 (2 1/4")
- HOT-MIX ASPHALT BASE COURSE, (5 1/4")
- LIME MODIFIED SOIL 12"
- PCC PAVEMENT 9.25" (JOINTED)
- SUB-BASE GRANULAR MATERIAL TYPE A, 12"
- HOT-MIX ASPHALT SHOULDERS, 11 1/4"
- HOT-MIX ASPHALT SHOULDERS, 8"
- HOT-MIX ASPHALT SURFACE COURSE, MIX C, N70, 1.5"
- HOT-MIX ASPHALT BINDER COURSE, IL-19.0, N90, (2 1/2")
- AGGREGATE BASE COURSE, TYPE A 8"

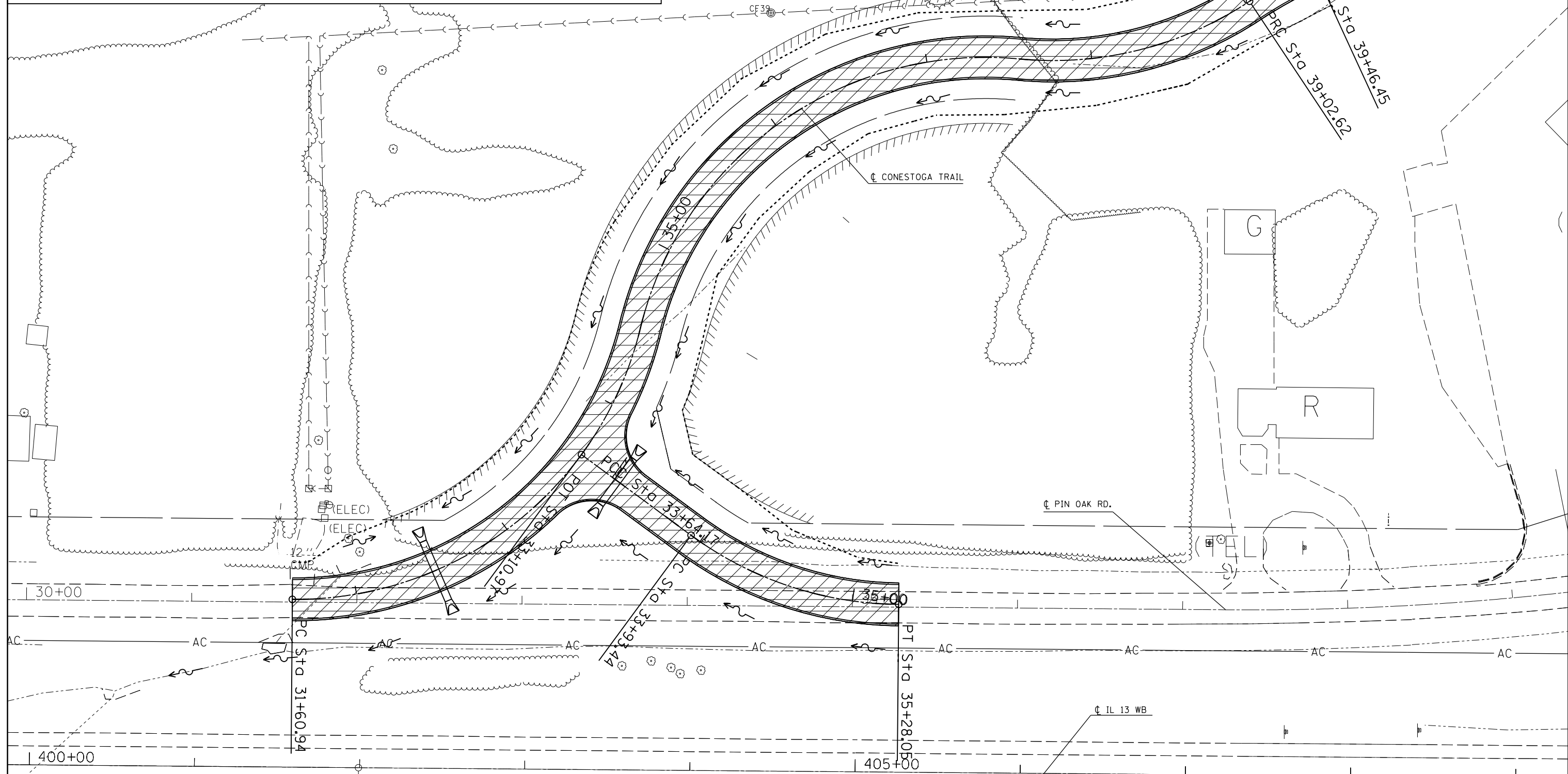
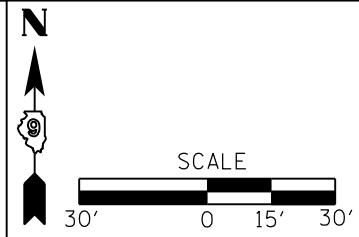

FILE NAME =	USER NAME = kellek	DESIGNED -	REVISED -	STATE OF ILLINOIS DEPARTMENT OF TRANSPORTATION	CONSTRUCTION SHEET			F.A.P. RTE.	SECTION	COUNTY	TOTAL SHEETS	SHEET NO.
et:\pwork\pwork\kellek\d0205725\782	6-sht-plnprf.dgn	DRAWN -	REVISED -		331	(1-4R-1,N-3,TS-3	Williamson	220	60			
PLOT SCALE = 60.0000' / in.	CHECKED -	REVISED -	REVISED -		CONTRACT NO. 78216			ILLINOIS FED. AID PROJECT				
PLOT DATE = 12/15/2011	DATE -	REVISED -	REVISED -		SCALE:	SHEET	OF	SHEETS	STA.	TO	STA.	