

STAGE 2

1. REMOVE EXISTING PAVEMENT AND SHOULDER. CONSTRUCT HMA PAVEMENT, SHOULDER AND GUARDRAIL.
2. SHIFT EB LANES AS SHOWN. A 2' OUTSIDE SHOULDER AND GREATER THAN A 3' CLEARANCE BETWEEN THE INSIDE EDGE OF PAVEMENT AND THE DROP OFF AREA IS REQUIRED AS A MINIMUM. REFER TO DROP OFF PROTECTION CHART. IF THESE REQUIREMENTS AREN'T MET A LANE CLOSURE WILL BE REQUIRED AND A LANE RENTAL WILL BE CHARGED.

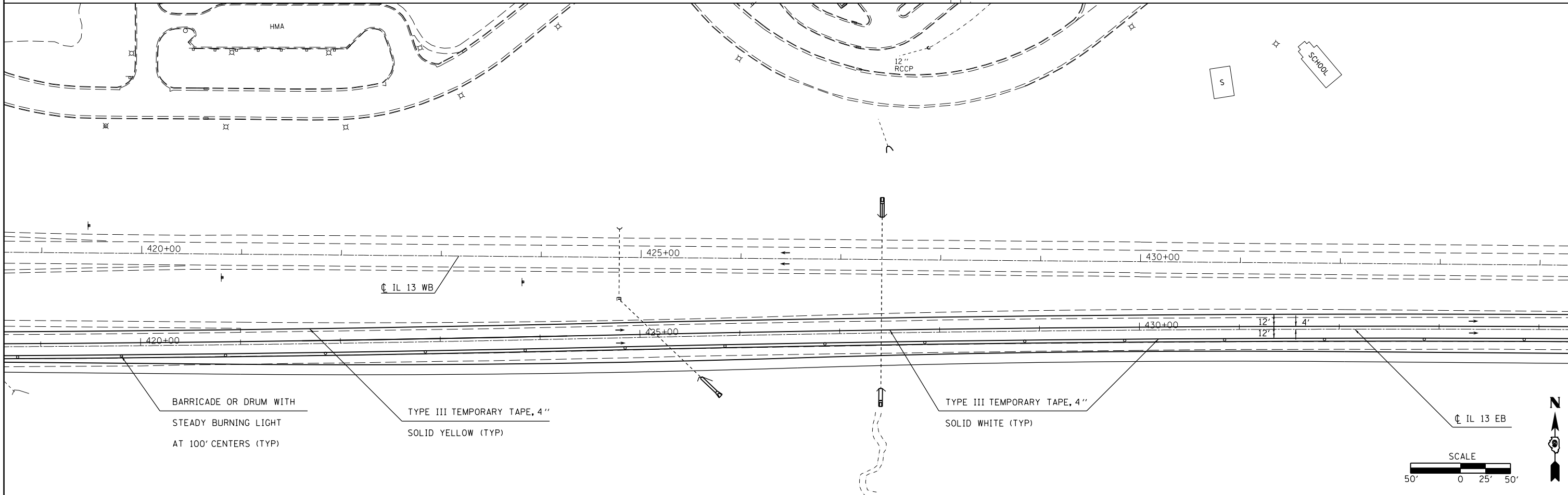
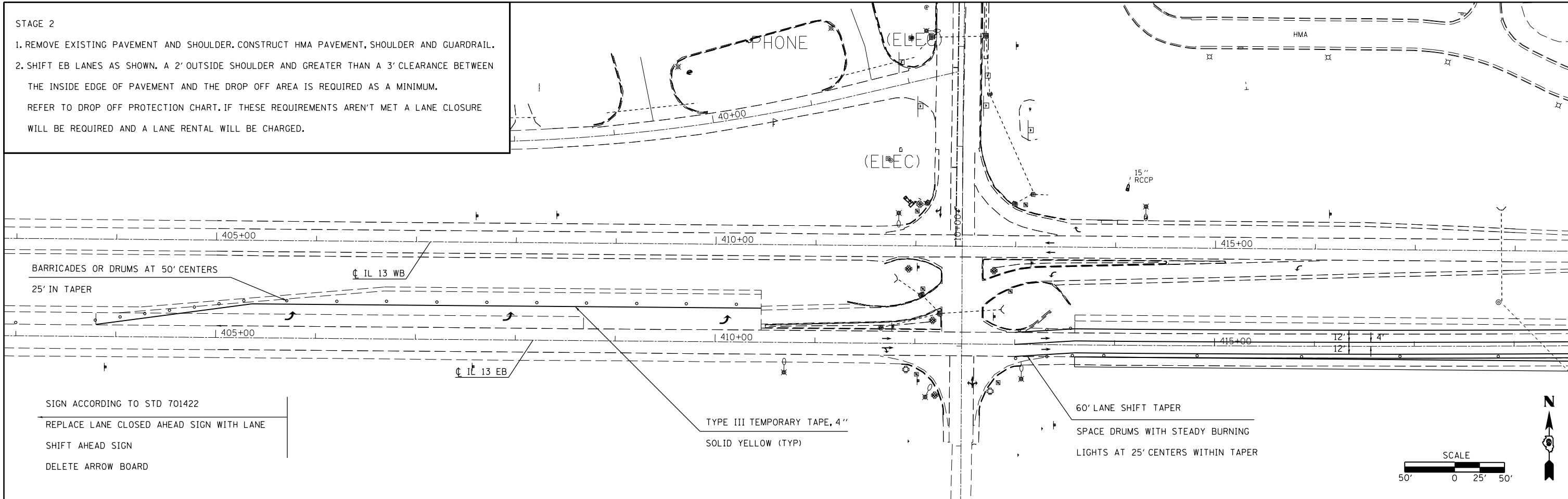

FILE NAME =	USER NAME = kellek	DESIGNED -	REVISED -	<b>STATE OF ILLINOIS DEPARTMENT OF TRANSPORTATION</b>	<b>STAGING SHEET STAGE 2</b>				F.A.P. RTE.	SECTION	COUNTY	TOTAL SHEETS	SHEET NO.
ei:\pwork\pwork\kellek\d0205725\78216-sht-staging.dgn		DRAWN -	REVISED -		331	(1-4)R-1,N-3,TS-3	Williamson	220	64				
PLOT SCALE = 100.0000' / in.		CHECKED -	REVISED -		CONTRACT NO. 78216								
PLOT DATE = 12/15/2011		DATE -	REVISED -		ILLINOIS FED. AID PROJECT								