

STAGE 10

1. REMOVE EXISTING PAVEMENT, CURB AND GUTTER, DRAINAGE ITEMS AND TRAFFIC SIGNALS AND REPLACE.
2. SHIFT WB LANES AS SHOWN. CLOSE WB RIGHT TURN LANE.
3. SHIFT NORTH GREENBRIAR LANES TO ALLOW GREATER THAN A 3' CLEARANCE BETWEEN THE OUTSIDE EDGE OF PAVEMENT AND THE DROP OFF AREA. REFER TO DROP OFF PROTECTION CHART.
4. FOR EACH PARTIAL OR FULL DAY THE WB RIGHT TURN LANE IS CLOSED AN INTERSECTION RENTAL DAY WILL BE CHARGED.

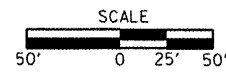

R

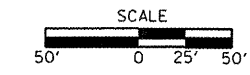
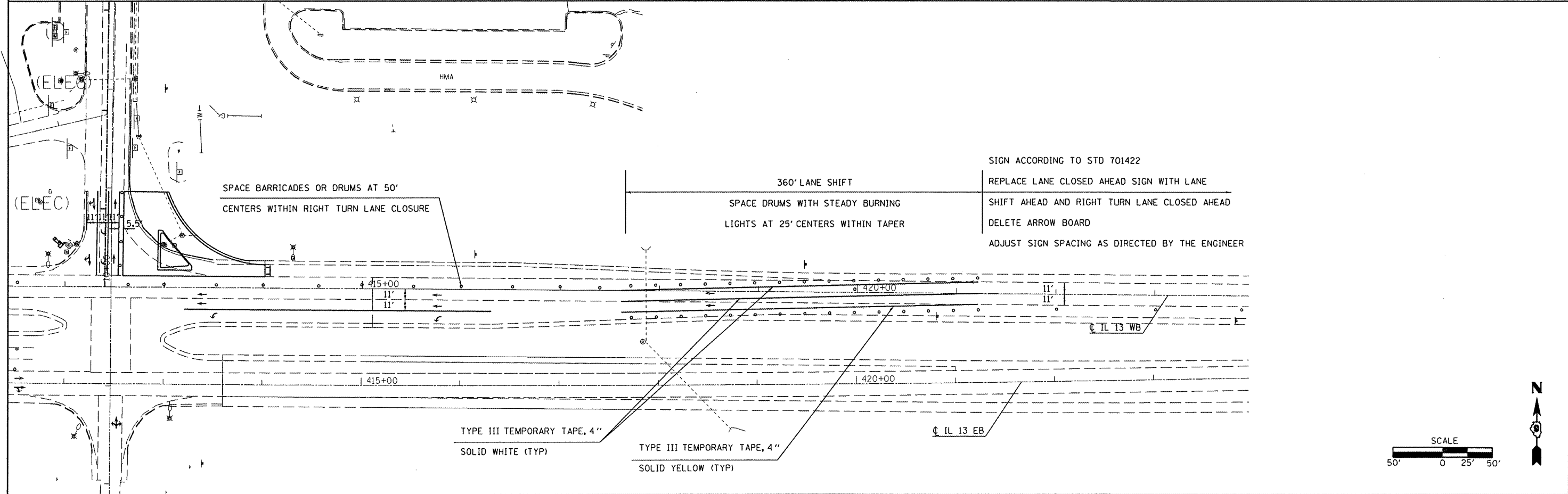
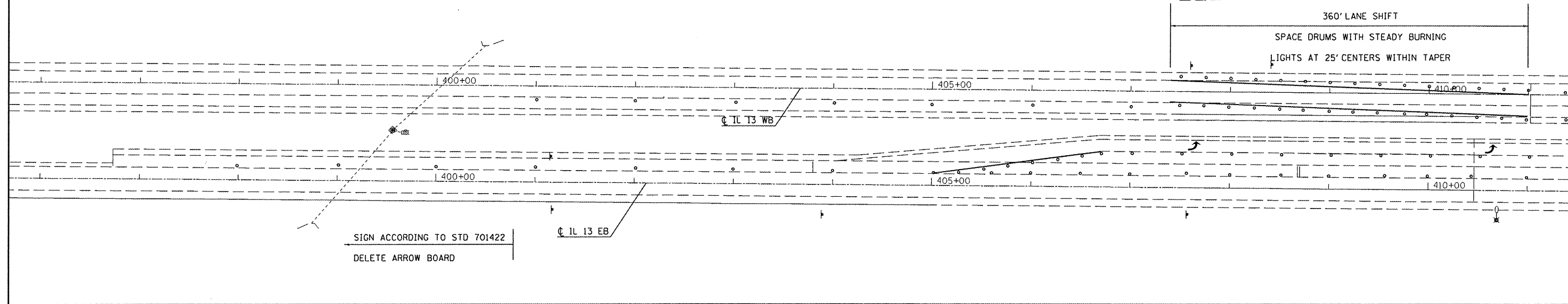

FILE NAME =	USER NAME = kelleykd	DESIGNED -	REVISED -
cr:\pwork\pwork\kelleykd\08285725\782	8-ght-staging.dgn	DRAWN -	REVISED -
	PLOT SCALE = 100.0000' / in.	CHECKED -	REVISED -
	PLOT DATE = 12/22/2011	DATE -	REVISED -

**STATE OF ILLINOIS
DEPARTMENT OF TRANSPORTATION**

**STAGING SHEET
STAGE 10**

SCALE: SHEET OF SHEETS STA. TO STA.

F.A.P. RTE.	SECTION	COUNTY	TOTAL SHEETS	SHEET NO.
331	(1-4R-1,N-3,TS-3)	Williamson	220	74
CONTRACT NO. 78216			ILLINOIS FED. AID PROJECT	