

DATE	
BY	
FINAL SURVEY	
SURVEYED	
PLOTTED	
TEMPLATE	
NOTE BOOK	
AREAS CHECKED	
NO.	

DATE	
BY	
ORIGINAL SURVEY	
SURVEYED	
PLOTTED	
TEMPLATE	
NOTE BOOK	
AREAS CHECKED	
NO.	

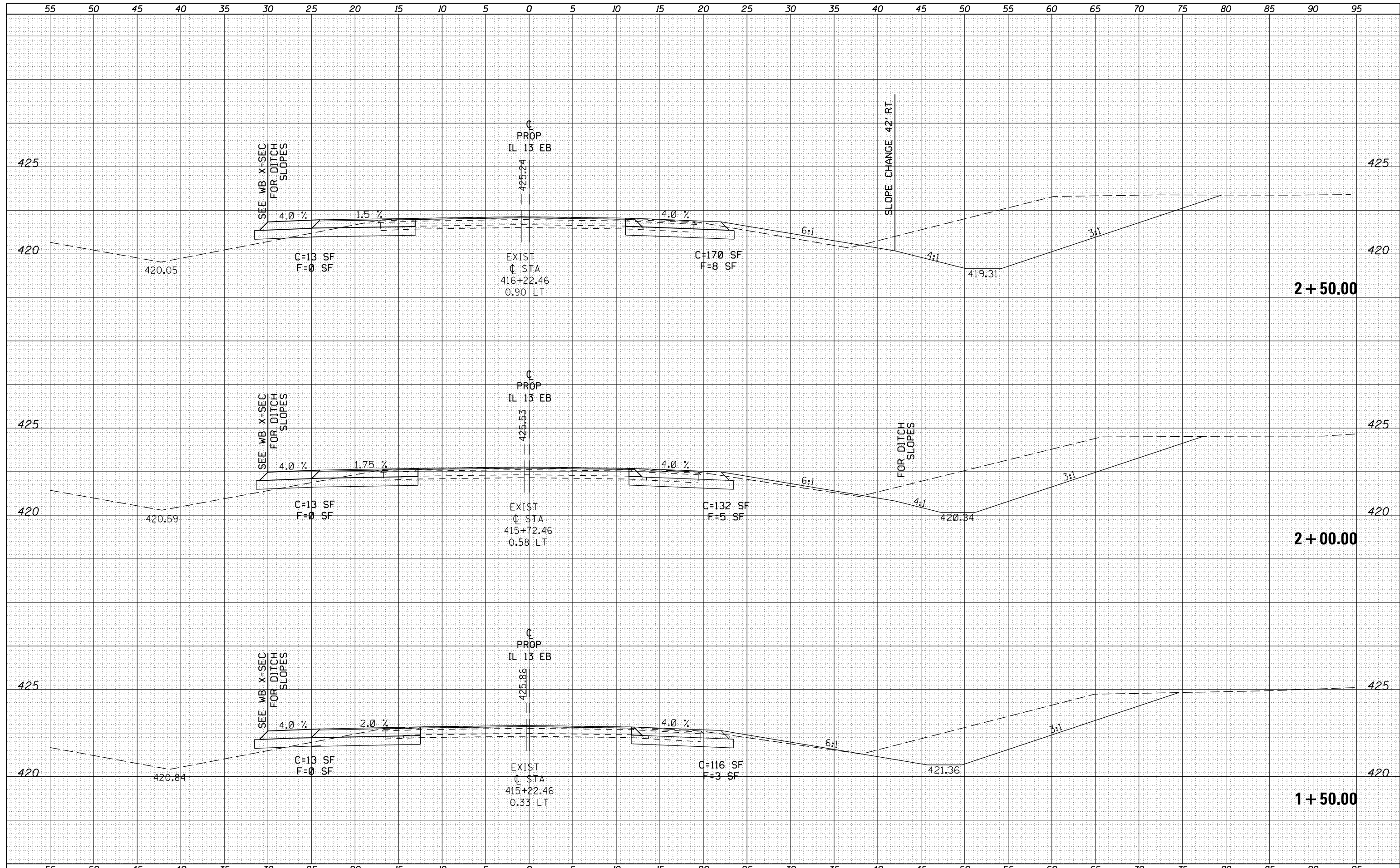

FILE NAME =	USER NAME = kellek	DESIGNED -	REVISD -	STATE OF ILLINOIS DEPARTMENT OF TRANSPORTATION	CROSS SECTION SHEETS IL 13 EASTBOUND	F.A.P. RTE.	SECTION	COUNTY	TOTAL SHEETS	SHEET NO.	
es:\pw\work\pwidot\kellek\d0205725\78216-sht-1		DRAWN -	REVISD -			331	(1-4)R-1,N-3,TS-3	Williamson	220	160	
		CHECKED -	REVISD -			CONTRACT NO. 78216					
		DATE -	REVISD -			ILLINOIS FED. AID PROJECT					
PLOT SCALE = 10.0000' / in.				SCALE:		SHEET OF SHEETS		STA. 1+50.00 TO STA. 2+50.00			
PLOT DATE = 12/16/2011											