

DATE	
BY	
FINAL SURVEY	SURVEYED
NOTE BOOK	PLOTTED
NO.	TEMPLATE
	AREAS
	CHECKED

DATE	
BY	
ORIGINAL SURVEY	SURVEYED
NOTE BOOK	PLOTTED
NO.	TEMPLATE
	AREAS
	CHECKED

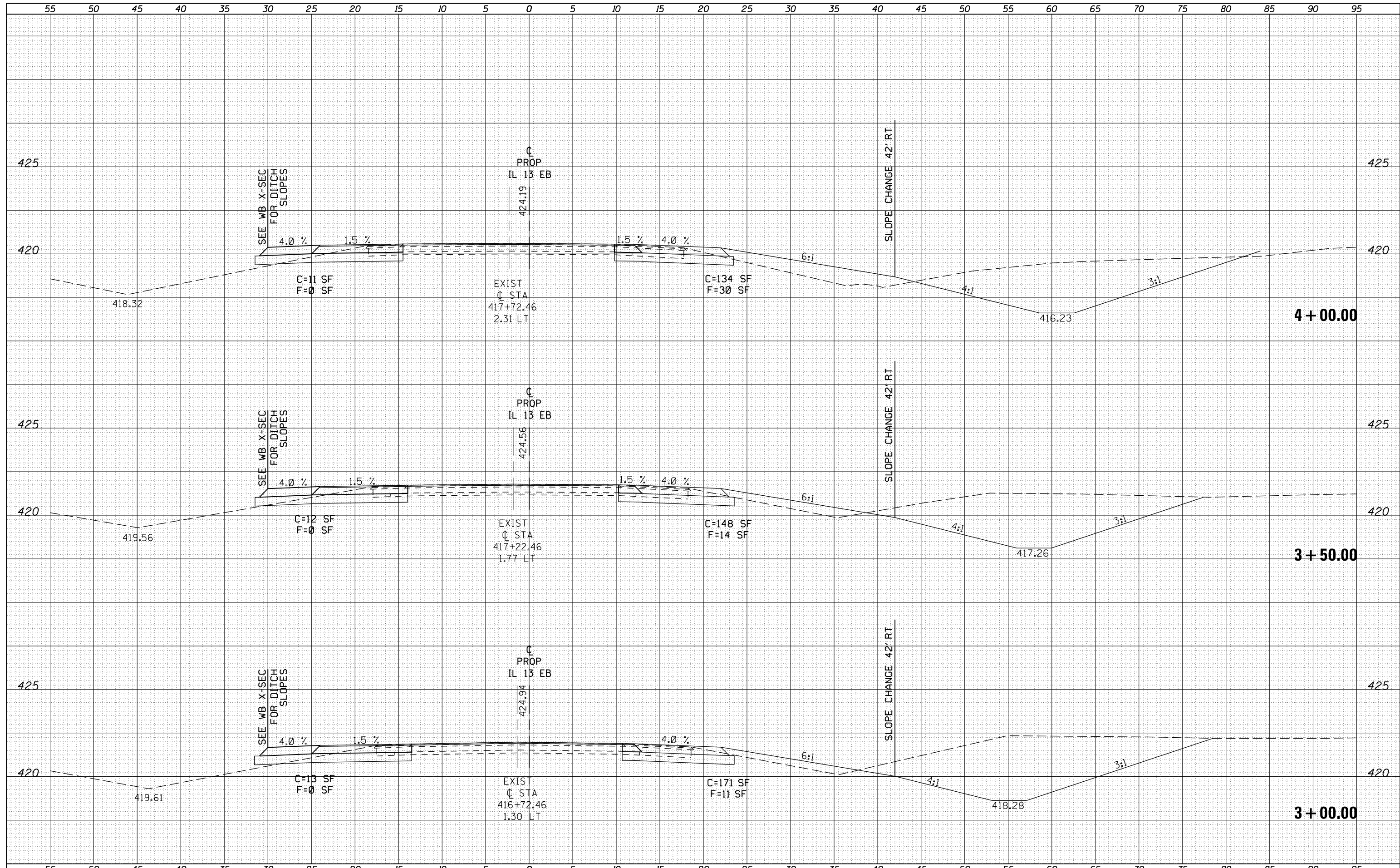

FILE NAME =	USER NAME = kellekdk	DESIGNED -	REVISED -	STATE OF ILLINOIS DEPARTMENT OF TRANSPORTATION	CROSS SECTION SHEETS IL 13 EASTBOUND			F.A.P. RTE.	SECTION	COUNTY	TOTAL SHEETS	SHEET NO.
es:\pwork\pwork\kellekdk\0205725\78216-sht-1	13xs.dgn	DRAWN -	REVISED -		331	(1-4)R-1,N-3,TS-3	Williamson	220	161			
		PLLOT SCALE = 10.0000' / in.	CHECKED -		REVISED -				CONTRACT NO. 78216			
		PLLOT DATE = 12/16/2011	DATE -		REVISED -	SCALE:	SHEET OF SHEETS	STA. 3+00.00 TO STA. 4+00.00	ILLINOIS FED. AID PROJECT			