

C.H.	SECTION	COUNTY	TOTAL SHEETS	SHEET NO.
9	06-00127-00-BR	JO DAVIESS	55	5
STA. 16+50		TO STA. 26+00		
ILLINOIS				

CONTRACT NO. 85539

**CURVE #1**  
 PI STA. = 15+93.28  
 $\Delta = 55^\circ 00' 00''$  (LT)  
 $D = 7^\circ 30' 00''$   
 $R = 763.94'$   
 $T = 397.68'$   
 $L = 733.33'$   
 $E = 97.31'$   
 $S.E. = 8.0\%$   
 P.C. STA. = 11+95.60  
 P.T. STA. = 19+28.93  
 TRANSITION:  
 STA. 10+38.00 TO STA. 12+47.00  
 STA. 18+77.00 TO STA. 20+86.00

**CURVE #2**  
 PI STA. = 25+85.05  
 $\Delta = 9^\circ 30' 40''$  (LT)  
 $D = 3^\circ 10' 12''$   
 $R = 1,807.40'$   
 $T = 150.36'$   
 $L = 300.03'$   
 $E = 6.24'$   
 $S.E. = 5.5\%$   
 P.C. STA. = 24+34.69  
 P.T. STA. = 27+34.72  
 TRANSITION:  
 STA. 23+40.00 TO STA. 24+94.00  
 STA. 26+97.00 TO STA. 28+51.00

**EXISTING S.N. 043-3011**  
 THE STRUCTURE WAS BUILT IN 1938. THE SUPERSTRUCTURE CONSISTS OF TWO-SPAN CONTINUOUS STEEL WIDE FLANGE BEAM WITH A REINFORCED CONCRETE DECK. THE SUBSTRUCTURE CONSISTS OF A REINFORCED CONCRETE SOLID-WALL PIER AND REINFORCED CONCRETE STUB ABUTMENTS. THE STRUCTURE IS 140'-0" BACK TO BACK OF ABUTMENTS AND 23.1' OUT TO OUT OF DECK

REMOVAL OF EXISTING STRUCTURES = 1 EACH

**PIPES TO BE REMOVED**

- RT. STA. 20+14, C.M.P., 28' LONG
  - LT. STA. 23+87.5, C.M.P., 30' LONG
- COST INCLUDED IN "EARTH EXCAVATION".

- TURF REINFORCEMENT MAT
- PAVEMENT REMOVAL

DATE	BY

DATE	BY

PLOT DATE = 1/12/87  
 FILE NAME = 4688PP2.DGN  
 PLOT SCALE = 1" = 40'  
 PLOT NAME = 0,0,0,0, S. PRICE

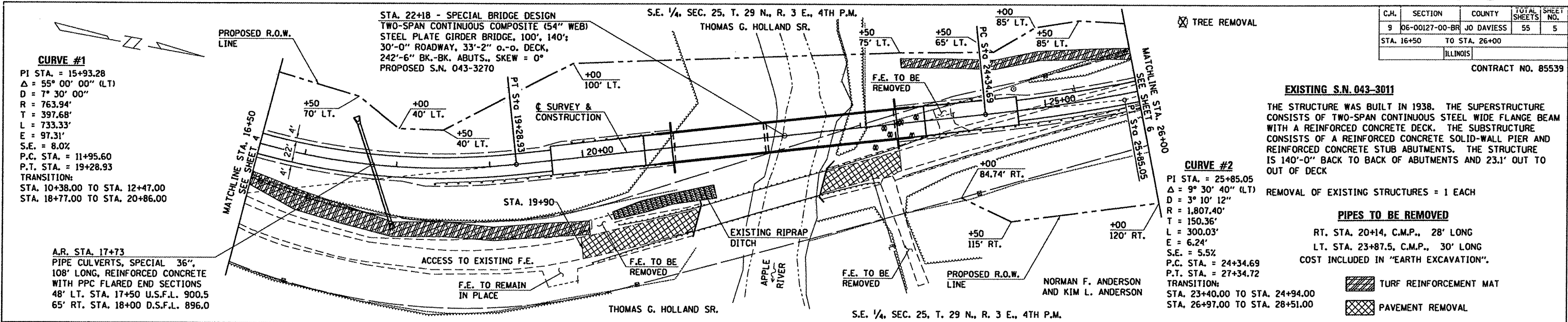

EARTH EXCAVATION = 3,890 CU. YD.  
 FURNISHED EXCAVATION = 41,484 CU. YD.  
 EMBANKMENT (INFO ONLY) = 44,402 CU. YD.

B.M. #2	CHISELED "C" ON SW. COR. WING
62' RT. STA. 21+20	
EL. 886.24	

