

DESCRIPTION OF INTENDED SEQUENCE OF MAJOR CONSTRUCTION ACTIVITIES WHICH WILL DISTURB EARTH AND LEAD TO POSSIBLE EROSION FOR MAJOR PORTIONS OF THE CONSTRUCTION SITE:

1. PLACEMENT OF PERIMETER EROSION CONTROL FENCE PRIOR TO THE COMMENCEMENT OF ANY ROAD OR BRIDGE WORK. SEE STD. 280001.
2. CONSTRUCTION OF THE REPLACEMENT STRUCTURE.
3. PLACEMENT OF ROADWAY EMBANKMENT TO RAISE THE ROADWAY TO THE PROPOSED GRADE.
4. REMOVAL OF EXISTING STRUCTURE
5. DEGRADING OF EXISTING ROADWAY
6. DRAINAGE STRUCTURES, INCLUDING DITCHES, WILL BE INSTALLED BEFORE AND/OR DURING THE COMPLETION OF THE EMBANKMENT.
7. PLACEMENT AND MAINTENANCE OF TEMPORARY EROSION CONTROL.
8. PLACEMENT OF PERMANENT EROSION CONTROL.
9. REMOVAL AND PROPER CLEAN UP OF TEMPORARY EROSION CONTROL.
10. FINAL GRADING, PLACING AGGREGATE AND OTHER MISCELLANEOUS ITEMS.

CURVE #1

PI STA. = 15+93.28
 $\Delta = 55^\circ 00' 00''$ (LT)
 D = 7° 30' 00"
 R = 763.94'
 T = 397.68'
 L = 733.33'
 E = 97.31'
 e = -----
 T.R. = -----
 S.E. RUN = -----
 P.C. STA. = 11+95.60
 P.T. STA. = 19+28.92

TEMPORARY DITCH CHECKS

LT. STA. 10+00	= 20 FOOT
LT. STA. 10+50	= 20 FOOT
LT. STA. 11+00	= 20 FOOT
LT. STA. 11+50	= 20 FOOT
LT. STA. 12+00	= 20 FOOT
LT. STA. 12+50	= 20 FOOT
LT. STA. 13+00	= 20 FOOT
LT. STA. 13+50	= 20 FOOT
LT. STA. 15+50	= 20 FOOT
LT. STA. 16+50	= 20 FOOT
LT. STA. 23+50	= 20 FOOT
LT. STA. 23+70	= 10 FOOT
LT. STA. 23+90	= 10 FOOT
LT. STA. 24+10	= 10 FOOT
LT. STA. 24+30	= 10 FOOT
LT. STA. 24+50	= 10 FOOT
LT. STA. 24+70	= 10 FOOT
LT. STA. 24+90	= 10 FOOT
LT. STA. 25+10	= 10 FOOT
LT. STA. 25+30	= 20 FOOT
LT. STA. 25+50	= 20 FOOT
LT. STA. 25+70	= 20 FOOT
LT. STA. 25+90	= 20 FOOT
LT. STA. 26+10	= 20 FOOT
LT. STA. 26+30	= 20 FOOT
LT. STA. 26+50	= 20 FOOT
LT. STA. 26+70	= 20 FOOT
LT. STA. 26+90	= 20 FOOT
LT. STA. 27+17	= 20 FOOT
RT. STA. 14+17	= 20 FOOT
RT. STA. 14+50	= 20 FOOT
RT. STA. 14+84	= 20 FOOT
RT. STA. 15+17	= 20 FOOT
RT. STA. 15+50	= 20 FOOT
RT. STA. 16+50	= 20 FOOT
RT. STA. 16+75	= 20 FOOT
RT. STA. 17+00	= 30 FOOT
RT. STA. 17+25	= 20 FOOT
RT. STA. 17+50	= 20 FOOT
RT. STA. 17+70	= 20 FOOT
RT. STA. 17+90	= 20 FOOT
RT. STA. 18+10	= 20 FOOT
RT. STA. 18+30	= 20 FOOT
RT. STA. 18+50	= 20 FOOT
RT. STA. 18+70	= 20 FOOT
RT. STA. 18+90	= 20 FOOT
RT. STA. 19+33	= 20 FOOT
RT. STA. 20+00	= 20 FOOT
RT. STA. 20+50	= 20 FOOT
RT. STA. 21+00	= 20 FOOT
TOTAL	= 930 FOOT

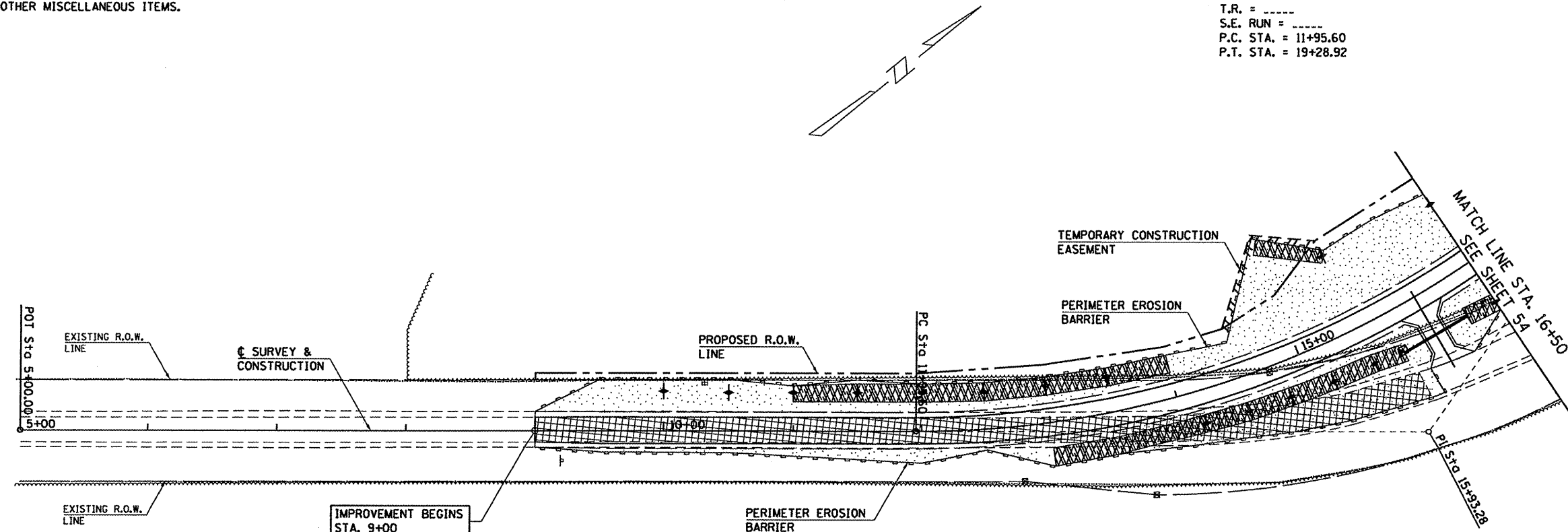

BILL OF MATERIAL

ITEM	UNIT	QUANTITY
TEMPORARY EROSION CONTROL SEEDING	POUND	950
TEMPORARY DITCH CHECKS	FOOT	930
PERIMETER EROSION BARRIER	FOOT	3995
INLET AND PIPE PROTECTION	EACH	4

INLET AND PIPE PROTECTION

RT. STA. 15+72	= 1 EACH
LT. STA. 17+50	= 1 EACH
LT. STA. 27+87	= 1 EACH
RT. STA. 29+17	= 1 EACH
TOTAL	= 4 EACH

THE ABOVE QUANTITIES ARE ESTIMATES ONLY. ACTUAL QUANTITIES FOR EROSION CONTROL WILL BE DETERMINED BY THE ENGINEER IN THE FIELD AND THERE WILL BE NO ADJUSTMENT IN ANY PRICE DUE TO A CHANGE IN PLAN QUANTITY.

TEMPORARY EROSION CONTROL:

- PERIMETER EROSION BARRIER
- TEMPORARY DITCH CHECK
- INLET AND PIPE PROTECTION

PERMANENT EROSION CONTROL:

- SEEDING CLASS 2, FERTILIZERS, & MULCH, METHOD 2
- TURF REINFORCEMENT MAT

FILE NAME = 46860 EROSION.DGN

DESIGNED - G.J.C.	REVISED - S.A.P. 03/24/11
DRAWN - S.A.P.	REVISED -
CHECKED - R.J.C.	REVISED -
DATE - 01/10/11	REVISED -

4440 ASH GROVE
 SPRINGFIELD, IL. 62711
 (217) 793-8600
 www.fehr-graham.com

FEHR-GRAHAM & ASSOCIATES, LLC
 ENGINEERING AND SCIENCE CONSULTANTS
 FREEPORT, IL ROCKFORD, IL ROCHELLE, IL MONROE, WI SPRINGFIELD, IL

EROSION CONTROL PLAN

PROPOSED STRUCTURE @ STA. 22+18.00

CO. HWY.	SECTION	COUNTY	TOTAL SHEETS	SHEET NO.
9	06-00127-00-BR	JO DAVIESS	55	53

SCOUT CAMP ROAD
 ILLINOIS
 CONTRACT NO. 85539