

BM 332 RR Spike in Power Pole #2102
Sta. 38+784.317, 2.403m LT
Elev. 253.615

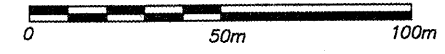

STATION EQUATION
STA. 39+369.864 (BACK)
STA. 39+376.300 (AHEAD)
AND BEGIN HMA SURFACE

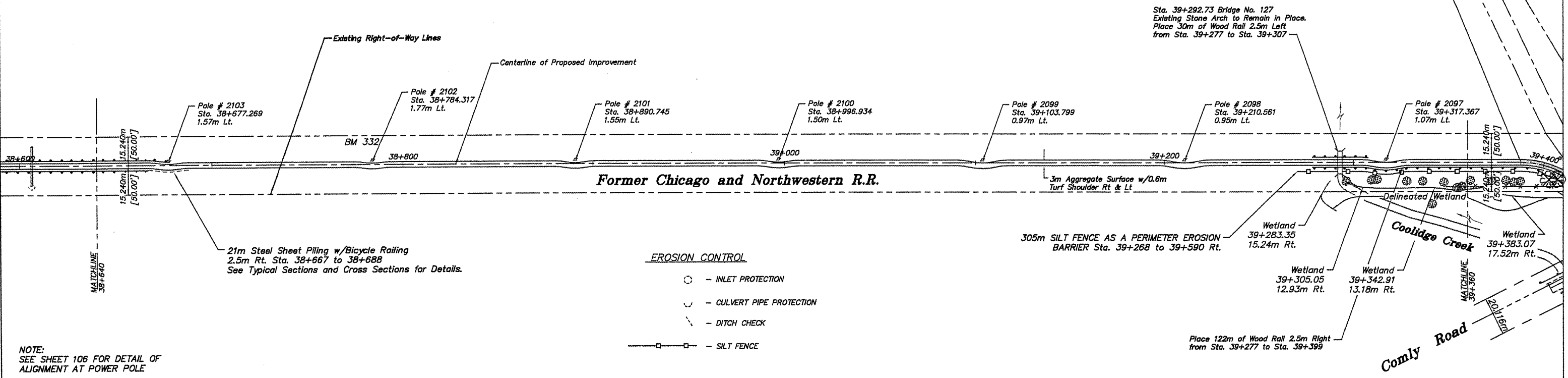

EROSION CONTROL

- - INLET PROTECTION
- ⌋ - CULVERT PIPE PROTECTION
- - - - DITCH CHECK
- - SILT FENCE

NOTE:
SEE SHEET 106 FOR DETAIL OF
ALIGNMENT AT POWER POLE

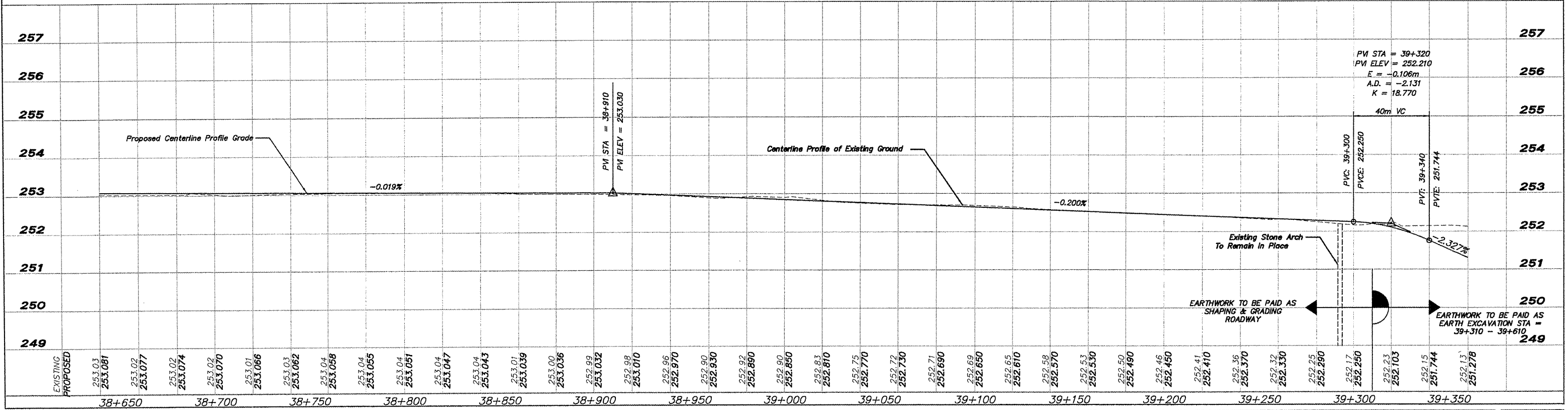

EXISTING	PROPOSED
253.03	253.03
253.081	253.081
253.02	253.02
253.077	253.077
253.074	253.074
253.02	253.02
253.070	253.070
253.01	253.01
253.066	253.066
253.03	253.03
253.062	253.062
253.04	253.04
253.058	253.058
253.04	253.04
253.055	253.055
253.04	253.04
253.047	253.047
253.04	253.04
253.043	253.043
253.01	253.01
253.039	253.039
253.00	253.00
253.036	253.036
252.99	252.99
253.032	253.032
252.98	252.98
253.010	253.010
252.96	252.96
252.970	252.970
252.90	252.90
252.930	252.930
252.92	252.92
252.890	252.890
252.90	252.90
252.83	252.83
252.870	252.870
252.75	252.75
252.770	252.770
252.72	252.72
252.730	252.730
252.71	252.71
252.690	252.690
252.69	252.69
252.650	252.650
252.65	252.65
252.610	252.610
252.58	252.58
252.570	252.570
252.53	252.53
252.530	252.530
252.50	252.50
252.490	252.490
252.46	252.46
252.450	252.450
252.41	252.41
252.410	252.410
252.36	252.36
252.370	252.370
252.32	252.32
252.330	252.330
252.25	252.25
252.260	252.260
252.17	252.17
252.260	252.260
252.23	252.23
252.103	252.103
252.15	252.15
251.744	251.744
251.13	251.13
251.278	251.278

SHEET REVIEW	
AGENCY	DATE

REVISIONS		
NO.	ITEM	DATE

SCALE: Hor. = 1:1000 Ver. = 1:50
DRAWN BY: REK
CHECKED BY: JWH
DATE: DECEMBER 12, 2011

McClure
Engineering Associates, Inc.
7283 Argus Drive Rookford, Illinois 61107-5837
(815) 388-2332 FAX (815) 388-2486
Design Firm License: Illinois 184-000816
Copyright 2011 By McClure Engineering Associates, Inc.

PLAN & PROFILE 38+640 TO 39+360
PECATONICA PRAIRIE PATH
WINNEBAGO COUNTY HIGHWAY DEPARTMENT SECTION 94-00267-00-BT
FILE:H:\10-042 WINN CO PEC PATH\DESIGN\DRAWINGS\10-042 PP38+640 TO 39+360.DWG JOB:04-30-10-042