

STATE OF ILLINOIS
DEPARTMENT OF TRANSPORTATION

CAUTION
OVERHEAD
WIRES

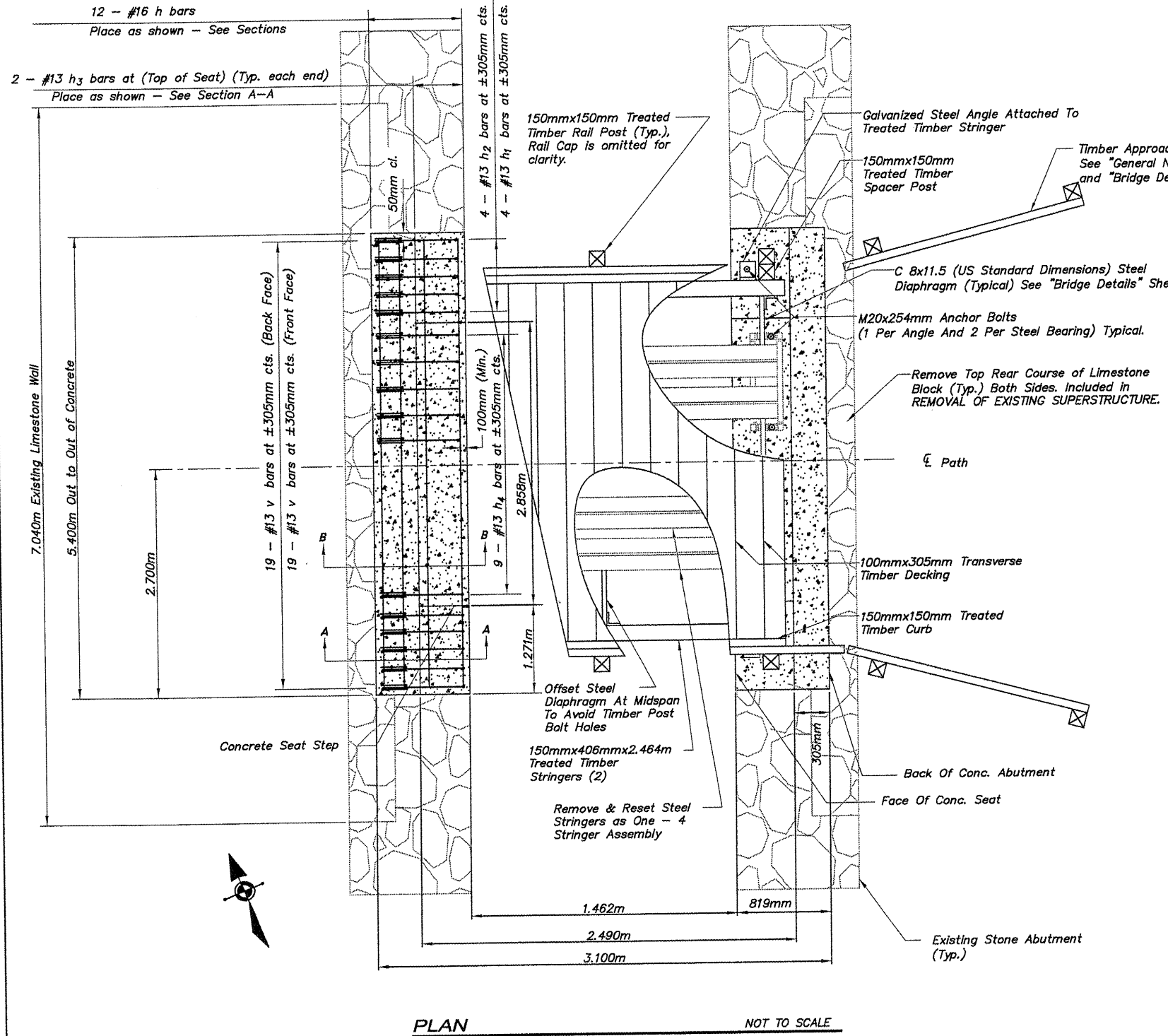

PLAN NOT TO SCALE

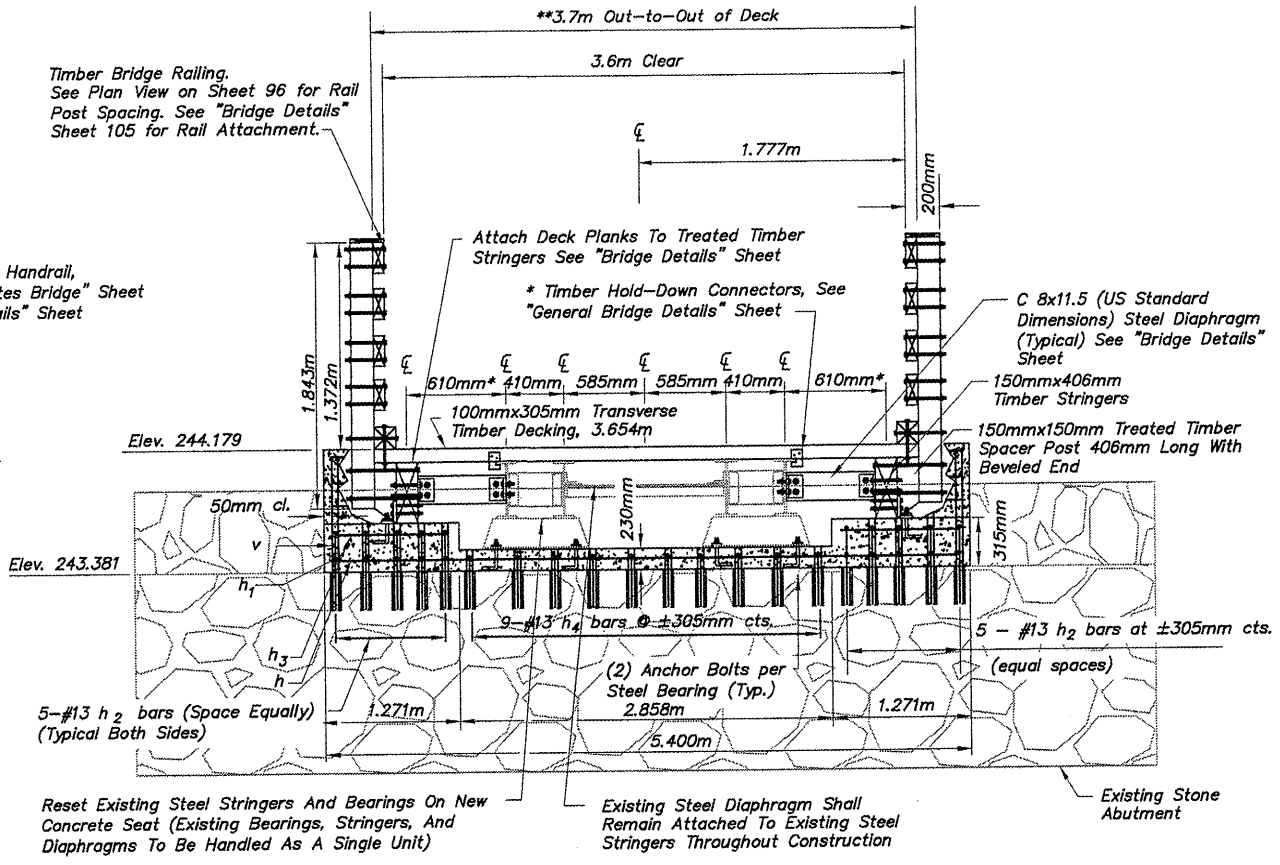

SECTION THRU DECK NOT TO SCALE

* Note: The Contractor may use an alternative method of using a 10mm thick plate washer and lag screw in place of the Timber Deck Angle as shown on the General Bridge Details and General Bridge Notes.

** Note: Dimensional lumber may vary in furnished size. Clear width of the deck shall be 3.6m minimum.

Note: Space reinforcing to avoid Anchor Bolt locations.

GENERAL PLAN & ELEVATION
BRIDGE 125
OVER A MINOR DITCH
TRIBUTARY TO THE PECATONICA RIVER
WINNEBAGO COUNTY
SECTION NO. 94-00267-00-BT
STATION 34+560.26

SHEET 2 OF 3

| SHEET REVIEW | |
|--------------|------|
| AGENCY | DATE |
| | |
| | |

| REVISIONS | | |
|-----------|------|------|
| NO. | ITEM | DATE |
| | | |
| | | |

| | |
|-------------|-------------------|
| SCALE: | N/A |
| DRAWN BY: | REK |
| CHECKED BY: | JWH |
| DATE: | DECEMBER 12, 2011 |

| | |
|------------------------------------|---|
| 7282 Arvus Drive (616) 398-2332 | McClure Engineering Associates, Inc. Rockford, Illinois 61107-5837 FAX (616) 398-2498 Design Firm License: Illinois 184-000816 Copyright 2011 By McClure Engineering Associates, Inc. |
|------------------------------------|---|

| | |
|--|------------------------|
| BRIDGE NO. 125 DETAILS I | |
| PECATONICA PRAIRIE PATH | |
| WINNEBAGO COUNTY HIGHWAY DEPARTMENT | SECTION 94-00267-00-BT |
| FILE: H:\10-042 WINN CO PEC PATH\DESIGN\DRAWINGS\BRIDGES\10-042 B\25.DWG | JOB: 04-30-10-042 |

| | |
|-----------|-----|
| SHEET NO. | 97 |
| OF | 107 |