

85552

STATE OF ILLINOIS  
DEPARTMENT OF TRANSPORTATION  
DIVISION OF HIGHWAYS

PLANS FOR PROPOSED  
HIGHWAY BRIDGE PROGRAM  
FAS 0052 (MONTAGUE ROAD BRIDGE)  
over MILL CREEK

SECTION 03-00324-00-BR  
PROJECT #BRS-0052 (109)  
WINNEBAGO COUNTY  
JOB NUMBER C-92-080-12  
CONTRACT 85552

INDEX OF SHEETS

- 1. TITLE SHEET
- 2. GENERAL NOTES, UTILITY CONTACTS, AND TYPICAL SECTIONS
- 3. SUMMARY OF QUANTITIES AND SCHEDULES OF QUANTITIES
- 4. ALIGNMENT, TIES, BENCHMARKS AND REMOVAL PLAN
- 5. PLAN AND PROFILE
- 6. EROSION CONTROL PLAN
- 7.-8. TRAFFIC CONTROL PLAN
- 9.-20. BRIDGE PLANS (INCLUDING BORING LOGS)
- 21.-24. CROSS SECTIONS

LIST OF HIGHWAY STANDARDS

- 280001-06 TEMPORARY EROSION CONTROL SYSTEMS
- 515001-03 NAME PLATE FOR BRIDGES
- 630001-10 STEEL PLATE BEAM GUARDRAIL
- 630301-05 SHOULDER WIDENING FOR TYPE 1 (SPECIAL) GUARDRAIL TERMINALS
- 631032-07 TRAFFIC BARRIER TERMINAL TYPE 6A
- 635006-03 REFLECTOR AND TERMINAL MARKER PLACEMENT
- 635011-02 REFLECTOR MARKER AND MOUNTING DETAILS
- 667101-02 PERMANENT SURVEY MARKERS
- 701006-03 OFF-RD OPERATIONS, 2L, 2W, 15' TO 24" FROM PAVEMENT EDGE
- 701201-04 LANE CLOSURE, 2L, 2W, DAY ONLY, FOR SPEEDS ≥ 45 MPH
- 701301-04 LANE CLOSURE, 2L, 2W, SHORT TIME OPERATIONS
- 701901-02 TRAFFIC CONTROL DEVICES
- 720001-01 SIGN PANEL MOUNTING DETAILS
- 720006-03 SIGN PANEL ERECTION DETAILS
- 720011-01 METAL POSTS FOR SIGN, MARKERS & DELINEATORS
- 728001-01 TELESCOPING STEEL SIGN SUPPORTS
- 729001-01 APPLICATIONS OF TYPES A AND B METAL POSTS (FOR SIGNS AND MARKERS)
- 731001-01 BASE FOR TELESCOPING STEEL SIGN SUPPORT
- 780001-03 TYPICAL PAVEMENT MARKINGS
- BLR 21-9 TYPICAL APPLICATION OF TRAFFIC CONTROL DEVICES FOR CONSTRUCTION ON RURAL LOCAL HIGHWAYS

NOTE  
SEE SHEET 2 FOR NAMES AND ADDRESSES  
OF UTILITY OWNERS.

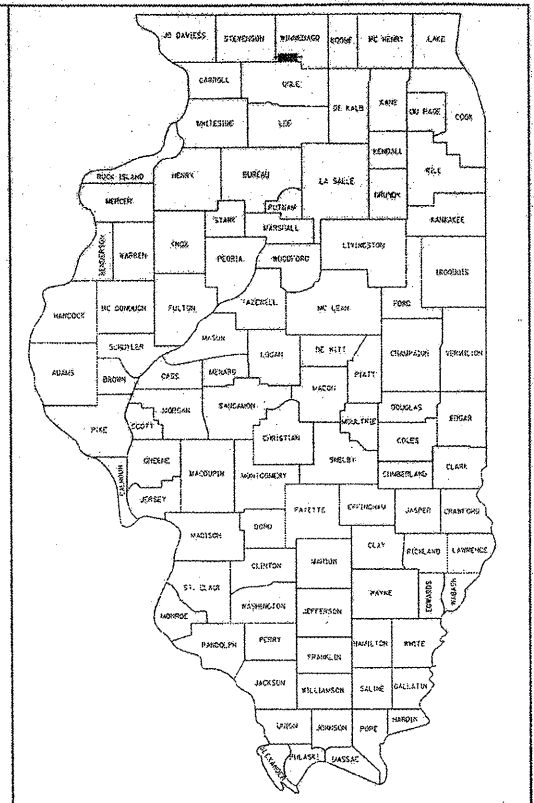

LOCATION OF SECTION INDICATED THUS: - - -

APPROVED *December 21, 2011*  
COUNTY ENGINEER

PASSED *12-23 2011*  
*Eric S. Thackildon*  
DISTRICT ENGINEER OF LOCAL ROADS & STREETS

RELEASING FOR BID BASED ON LIMITED REVIEW  
*12-23 2011*  
*Eric S. Thackildon*  
DEPUTY DIRECTOR OF HIGHWAYS REGION 2 ENGINEER

STATE OF ILLINOIS  
DEPARTMENT OF TRANSPORTATION

PROPOSED IMPROVEMENTS:

REMOVAL AND REPLACEMENT OF THE EXISTING BRIDGE CARRYING FAS ROUTE 0052 (MONTAGUE ROAD) OVER MILL CREEK AT STA. 55+30. NEW STRUCTURE CONSISTS OF A SINGLE SPAN PPC I-BEAM AND CONCRETE DECK SUPERSTRUCTURE, ON PILE-BENT ABUTMENTS. SN 101-3102

TRAFFIC DATA:

FUNCTIONAL CLASSIFICATION: RURAL COLLECTOR  
2011 ADT : 2150 1% TRUCKS  
DESIGN SPEED : 50 MPH

PLAN SHEET SCALES: HORIZ. = 20  
VERT. = 5

CROSS SECTION SHT. SCALES: HORIZ. = 10  
VERT. = 5

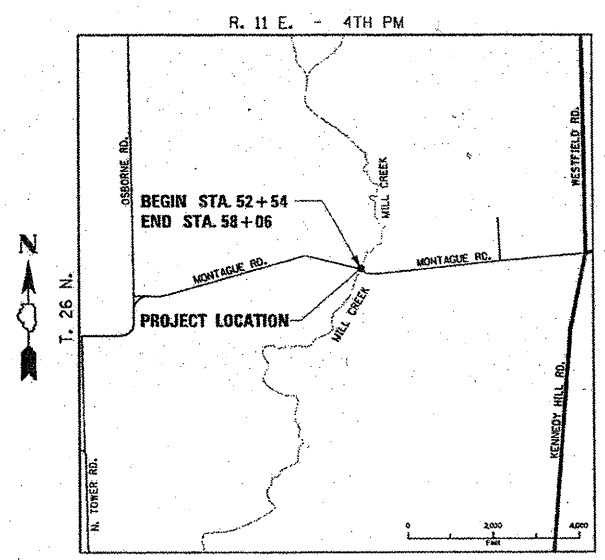

LOCATION MAP  
SCALE IN FEET  
NET LENGTH = 552 FEET (0.10 MILES)

STUART M. KEMP  
062  
04427  
REGISTERED  
PROFESSIONAL  
ENGINEER  
OF  
ILLINOIS

*Stuart M. Kemp*  
SIGNATURE  
12/16/11  
DATE  
LIC. EXP. DATE: 11/30/13

J.U.L.I.E.  
JOINT UTILITY LOCATION  
INFORMATION FOR EXCAVATION  
1-800-892-0123 OR 811

811  
Know what's below.  
Call before you dig.

UTILITY NOTE

THE LOCATIONS OF THOSE BURIED AND ABOVEGROUND UTILITIES SHOWN ARE APPROXIMATE, ARE SHOWN FOR CONTRACTOR INFORMATIONAL USE ONLY, AND ARE NOT TO BE REFERENCED FOR CONSTRUCTION PURPOSES. THE IMPLIED PRESENCE OR ABSENCE OF UTILITIES IS NOT TO BE CONSTRUED BY THE OWNER, ENGINEER, CONTRACTOR, OR SUBCONTRACTORS TO BE AN ACCURATE AND COMPLETE REPRESENTATION OF UTILITIES THAT MAY OR MAY NOT EXIST ON THE CONSTRUCTION SITE. BURIED AND ABOVEGROUND UTILITY LOCATION, IDENTIFICATION, AND MARKING ARE THE SOLE RESPONSIBILITY OF THE CONTRACTOR. REROUTING, DISCONNECTION, PROTECTION, ETC. OF ANY UTILITIES MUST BE COORDINATED AMONG THE CONTRACTOR, UTILITY COMPANY, AND OWNER. SITE SAFETY, INCLUDING THE AVOIDANCE OF HAZARDS, ASSOCIATED WITH BURIED AND ABOVEGROUND UTILITIES REMAIN THE SOLE RESPONSIBILITY OF THE CONTRACTOR.

12/21/2011  
11:03:00 AM  
C:\Users\stuart.kemp\Documents\03-00324-00-BR\03-00324-00-BR.dwg

|          |     |          |
|----------|-----|----------|
| DATE     | BY  | REVIEWED |
| 05/02/11 | SKM |          |
| 05/02/11 | SKM |          |
| 05/02/11 | SKM |          |

|          |  |              |                |           |   |
|----------|--|--------------|----------------|-----------|---|
| 03R1808  | © Copyright Hanson Professional Services Inc. 2011 | F.A.S. ROUTE | SECTION        | COUNTY    | TOTAL SHEET NO.                                   |
| 12/16/11 | HANSON   | 0052         | 03-00324-00-BR | WINNEBAGO | 24 1  |
|          |  |              |                |           | CONTRACT NO. 85552                                |
|          |  |              |                |           | FED. ROAD DIST. NO. 2 (ILLINOIS) FED. AID PROJECT |

Corporate License Number 184-001-084