

85552

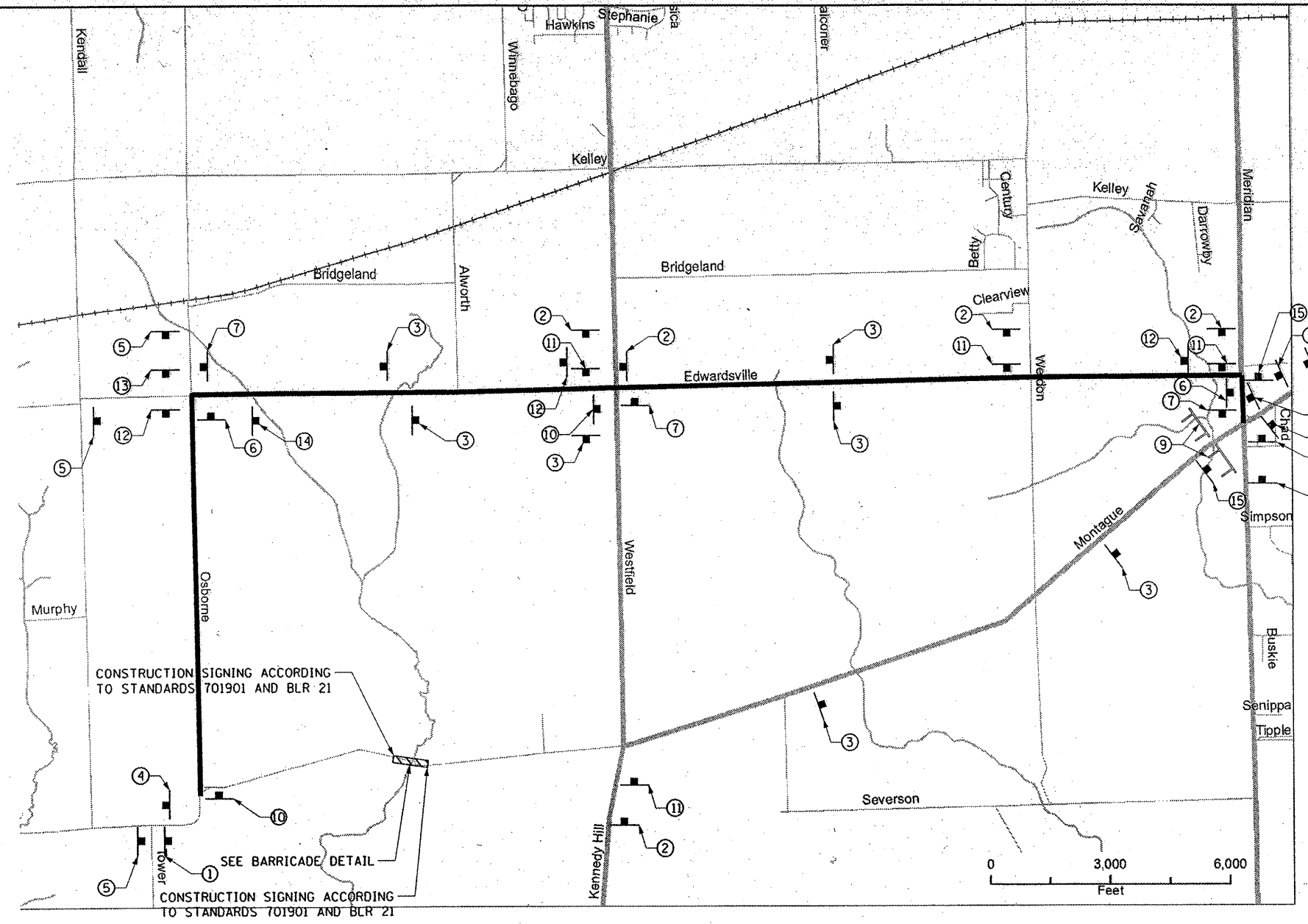

CONSTRUCTION SIGNING ACCORDING TO STANDARDS 701901 AND BLR 21

CONSTRUCTION SIGNING ACCORDING TO STANDARDS 701901 AND BLR 21

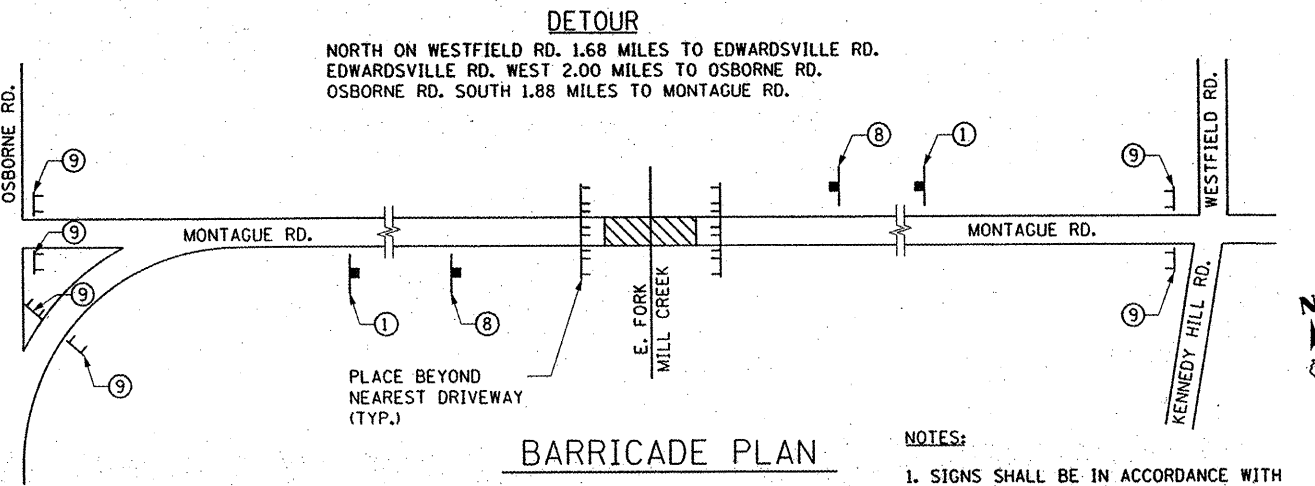

BARRICADE PLAN

- NOTES:
1. SIGNS SHALL BE IN ACCORDANCE WITH THE MUTCD AND APPLICABLE STANDARD.
  2. FOR SIGN DETAILS SEE SHT. 8 OF 24

**LEGEND**

- DETOUR ROUTE
- PROJECT LOCATION
- SIGN LOCATION
- SIGN BARRICADE TYPE III LOCATION



Hanson Professional Services Inc.  
© Copyright Hanson Professional Services Inc. 2008

FILE NAME =  
USER NAME = almy01238  
DESIGNED - DPA  
DRAWN - JDM  
CHECKED - DPA  
PLOT DATE = 12/21/2011

FILE NAME =	USER NAME = almy01238	DESIGNED - DPA	REVISED -
DRAWN - JDM	CHECKED - DPA	DATE - 12/16/11	REVISED -
REVIEWED -	PLOT SCALE = AS SHOWN	DATE - 12/21/2011	REVISED -

STATE OF ILLINOIS  
DEPARTMENT OF TRANSPORTATION

DETOUR ROUTE		F.A.S. RTE. 0052	SECTION 03-00324-00-BR	COUNTY WINNEBAGO	TOTAL SHEETS 24	SHEET NO. 7
MONTAGUE ROAD BRIDGE REPLACEMENT		CONTRACT NO. 85552		ILLINOIS FED. AID PROJECT		
SHEET NO.	OF SHEETS	STA.	TO STA.			