

BENCHMARKS			
BM 42	SET RR SPIKE IN PP @ NW CORNER OF 1ST STREET/W 5TH AVENUE STA. 18+69.05, 13.79' LT ELEV=625.15	BM 4291	"0" IN OPEN ON FH @ NW COR 1ST STREET/W 6TH AVENUE STA. 14+09.34, 59.58' LT ELEV=657.79
BM 3981	☐ TELEPHONE MH ON W. SIDE OF 1ST STREET @ HOUSE #405 STA. 20+01.68, 10.96' RT ELEV=614.82	BM 4558	SET RR SPIKE IN PP W/LIGHT @ NE CORNER OF NEW HOPE BAPTIST CHURCH STA. 8+90.15, 6.24' LT ELEV=669.13

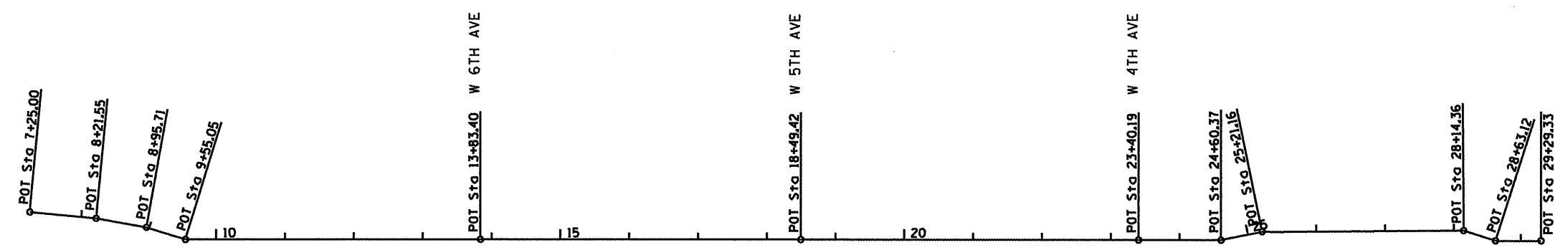
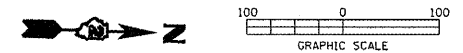

Beginning chain WALK description

Point 100 N 1,740,089.72 E 2,215,829.86 Sta 7+25.00
 Course from 100 to 101 N 6° 54' 38.50" E Dist 96.55
 Point 101 N 1,740,185.56 E 2,215,841.47 Sta 8+21.55
 Course from 101 to 102 N 11° 46' 48.80" E Dist 74.16
 Point 102 N 1,740,268.16 E 2,215,856.61 Sta 8+95.71
 Course from 102 to 103 N 18° 45' 12.01" E Dist 59.34
 Point 103 N 1,740,314.35 E 2,215,875.69 Sta 9+55.05
 Course from 103 to 104 N 1° 29' 53.85" E Dist 428.35
 Point 104 N 1,740,742.56 E 2,215,886.89 Sta 13+83.40
 Course from 104 to 105 N 1° 31' 52.65" E Dist 466.02
 Point 105 N 1,741,208.41 E 2,215,899.34 Sta 18+49.42
 Course from 105 to 106 N 1° 32' 39.07" E Dist 490.77
 Point 106 N 1,741,699.00 E 2,215,912.57 Sta 23+40.19
 Course from 106 to 107 N 1° 31' 08.39" E Dist 120.18
 Point 107 N 1,741,819.14 E 2,215,915.75 Sta 24+60.37
 Course from 107 to 108 N 10° 11' 13.06" W Dist 60.79
 Point 108 N 1,741,878.97 E 2,215,905.00 Sta 25+21.16
 Course from 108 to 109 N 1° 00' 44.14" E Dist 293.20
 Point 109 N 1,742,172.12 E 2,215,910.18 Sta 28+14.36
 Course from 109 to 110 N 19° 55.74" E Dist 48.76
 Point 110 N 1,742,218.13 E 2,215,926.33 Sta 28+63.12
 Course from 110 to 111 N 1° 31' 04.25" E Dist 66.21
 Point 111 N 1,742,284.32 E 2,215,928.08 Sta 29+29.33

Beginning profile SEG1 description:

	STATION	ELEV	GRADE	TOTAL L	BACK L	AHEAD L
VPI 1	7+63.20	674.73				
VPI 2	8+21.55	673.01	-2.95			
VPC	8+75.00	670.34	-5.00	K= 19.6		
VPI	9+00.00	669.09		50.00	25.00	25.00
VPT	9+25.00	668.48	-2.45			
VPC	12+70.00	660.02	-2.45	K= 10.2	SSD = 349.1	
VPI	12+80.00	659.78		20.00	10.00	10.00
VPT	12+90.00	659.34	-4.41			
VPI 5	13+38.88	657.18	-4.41			

Ending profile SEG1 description

Beginning profile SEG2 description:

	STATION	ELEV	GRADE	TOTAL L	BACK L	AHEAD L
VPI 1	14+28.05	653.34				
VPI 2	15+65.00	645.81	-5.50			
VPC	16+75.00	638.66	-6.50	K= 11.1	SSD = 260.6	
VPI	16+90.00	637.68		30.00	15.00	15.00
VPT	17+05.00	636.30	-9.21			
VPI 4	18+03.00	627.28	-9.21			
VPI 5	18+08.00	627.28	0.00			

Ending profile SEG2 description

Beginning profile SEG3 description:

	STATION	ELEV	GRADE	TOTAL L	BACK L	AHEAD L
VPI 1	18+97.94	621.71				
VPI 2	19+02.94	621.61	-2.00			
VPI 3	19+90.00	614.99	-7.60			
VPI 4	20+70.00	609.71	-6.60			
VPI 5	20+80.00	609.71	0.00			
VPC	21+75.00	604.25	-5.75	K= 10.0		
VPI	21+85.00	603.68		20.00	10.00	10.00
VPT	21+95.00	603.30	-3.75			
VPI 7	22+72.89	600.38	-3.75			
VPI 8	22+82.89	599.97	-4.10			

Ending profile SEG3 description