

SECTION 11-00325-00-SP  
(F.A.S. RTE. 258 (C.H. 2))  
IMPROVEMENT ENDS  
STA. 63+55.65

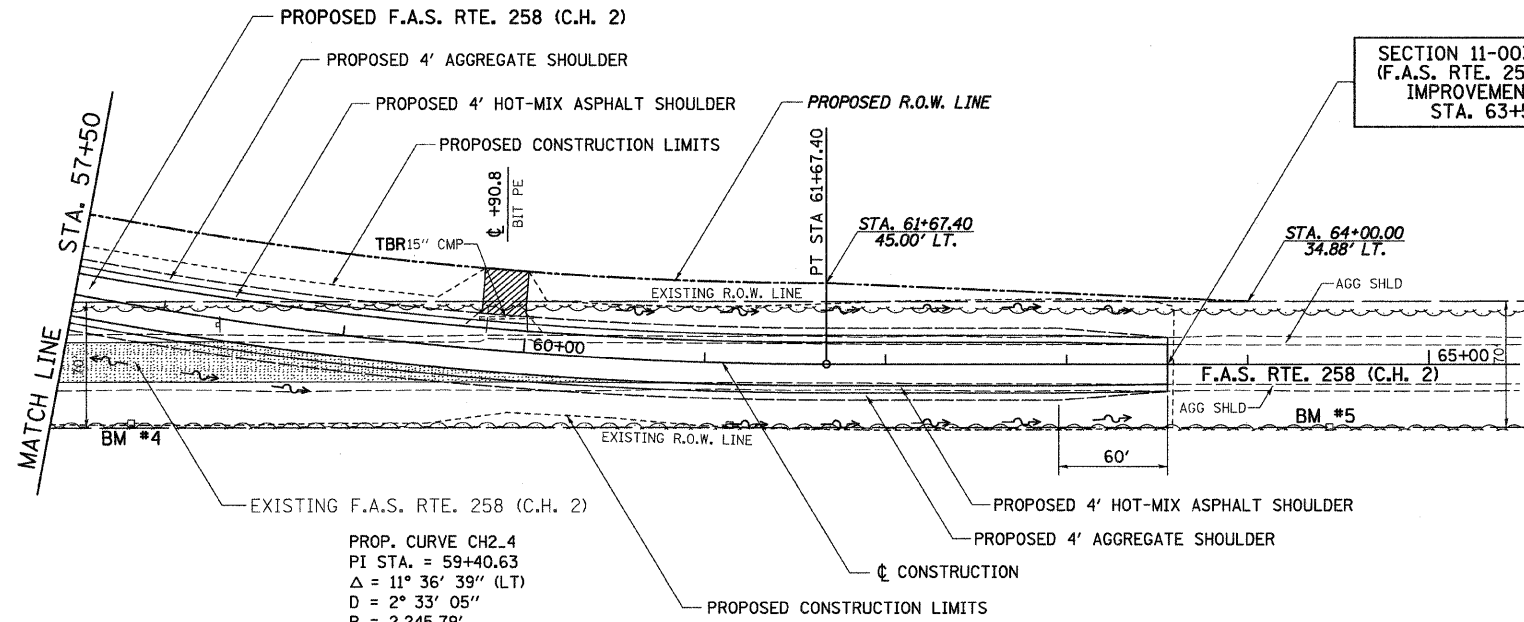

PROP. CURVE CH2.4  
 PI STA. = 59+40.63  
 $\Delta = 11^\circ 36' 39''$  (LT)  
 $D = 2^\circ 33' 05''$   
 $R = 2,245.79'$   
 $T = 228.33'$   
 $L = 455.10'$   
 $E = 11.58'$   
 $e = 5.5\%$   
 $T.R. = 37.00'$   
 $S.E. RUN = 134.00'$   
 $P.C. STA. = 57+12.30$   
 $P.T. STA. = 61+67.40$



DATE	
BY	
SURVEYED	
PLOTTED	
NOTED	
NO.	

DATE	
BY	
SURVEYED	
PLOTTED	
NOTED	
NO.	

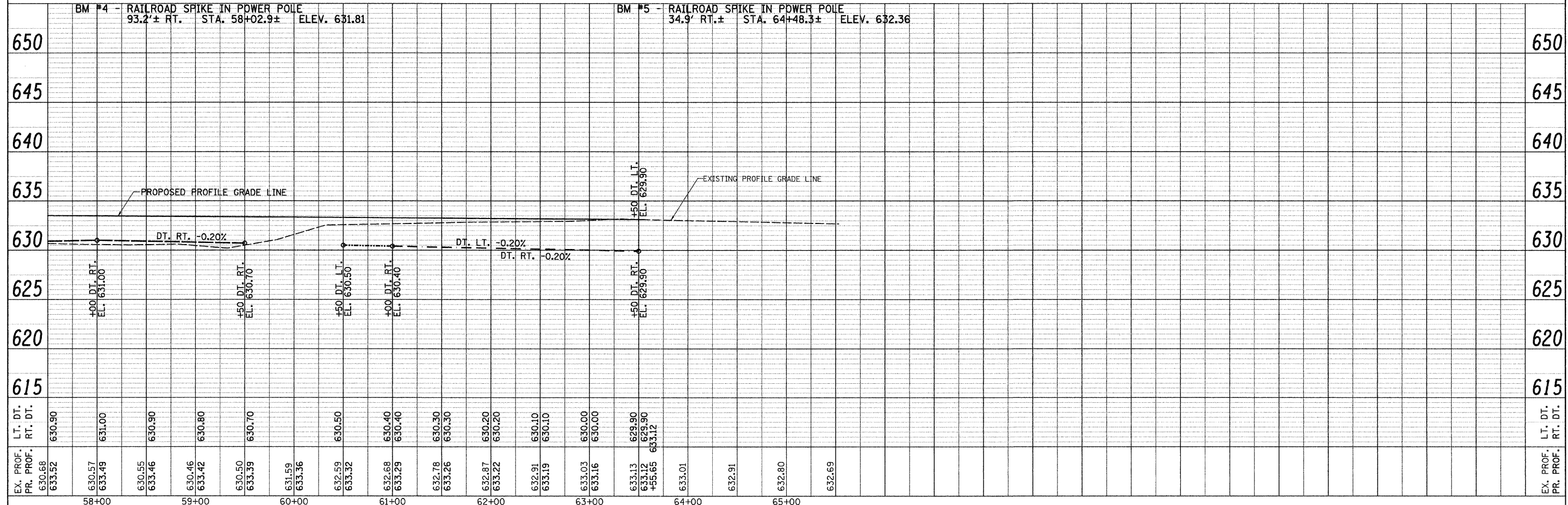

FILE NAME = v:\2844\2844p003.dgn	USER NAME = bdscreane	DESIGNED -	REVISED -	<b>STATE OF ILLINOIS DEPARTMENT OF TRANSPORTATION</b>	<b>F.A.S. RTE. 258 (C.H. 2) PLAN &amp; PROFILE</b>	F.A.S. RTE. 258	SECTION 11-00325-00-SP	COUNTY LA SALLE	TOTAL SHEETS 84	SHEET NO. 36
	PLOT SCALE = 50.0000' / IN.	CHECKED -	REVISED -			CONTRACT NO. 87479				
	PLOT DATE = 12/22/2011	DATE -	REVISED -			ILLINOIS FED. AID PROJECT				
						SCALE: H=50 V=5	SHEET NO. 3 OF 3 SHEETS	STA. 57+50 TO STA. 65+53.12		