

WORK TO BE COMPLETED DURING STAGE 1 CONSTRUCTION

ALL FLASHING BEACONS ARE TO REMAIN IN CONTINUOUS OPERATION DURING THE ENTIRE PERIOD OF CONSTRUCTION OPERATIONS. THE EXISTING 120V FLASHING BEACONS ARE NOT TO BE DISCONNECTED BEFORE THE TEMPORARY SOLAR POWERED FLASHING BEACONS ARE PLACED INTO OPERATION.

MOUNT A TEMPORARY SOLAR POWERED RED FLASHER AND A STOP SIGN (R1-1-36) ON A 4"x6" WOOD POST ATTACHED TO A TYPE III BARRICADE. POSITION EACH RED TEMPORARY FLASHER AT THE STOP BARS FOR NORTHBOUND AND SOUTHBOUND C.H. 2 FOR CONSTRUCTION STAGES 2, 3 AND 4, OR UNTIL THE PERMANENT FLASHING BEACON SYSTEM IS PLACED INTO OPERATION. ANCHOR THE TYPE III BARRICADES TO THEIR SURROUNDING SURFACE, IN A MANNER APPROVED BY THE ENGINEER.

MOUNT A TEMPORARY SOLAR POWERED YELLOW FLASHER AND CROSSROAD SIGN (W2-1-36) ON A 4"x6" WOOD POST ATTACHED TO A TYPE III BARRICADE AND LOCATE IT AT STA. 106+37 FOR WESTBOUND TRAFFIC. ANCHOR THE TYPE III BARRICADE TO IT'S SURROUNDING SURFACE, IN A MANNER APPROVED BY THE ENGINEER. DISCONNECT THE YELLOW FLASHER FROM FLASH POWER AFTER THE TEMPORARY YELLOW SOLAR FLASHER IS PLACED INTO OPERATION. RECONNECT BACK TO FLASH POWER WHEN THE ELECTRIC CABLE IS RESTORED TO THE FLASHER CONTROLLER.

THE EXISTING YELLOW FLASHING BEACON AND CROSSROAD SIGN FOR EASTBOUND TRAFFIC WILL REMAIN IN PLACE AND SHALL REMAIN IN CONTINUOUS OPERATION DURING ALL STAGES OF CONSTRUCTION OPERATIONS.

LEGEND

- ⊠ EXISTING SERVICE INSTALLATION
- ⊗ EXISTING WOOD POLE
- EXISTING CONDUIT
- Y→ EXISTING 12" FLASHING BEACON ON A 4"x6" WOOD POST (Y = YELLOW, R = RED)
- ⊠ EXISTING FLASHER CONTROLLER
- ⊠ EXISTING HANDHOLE
- A EXISTING AERIAL SERVICE CABLE

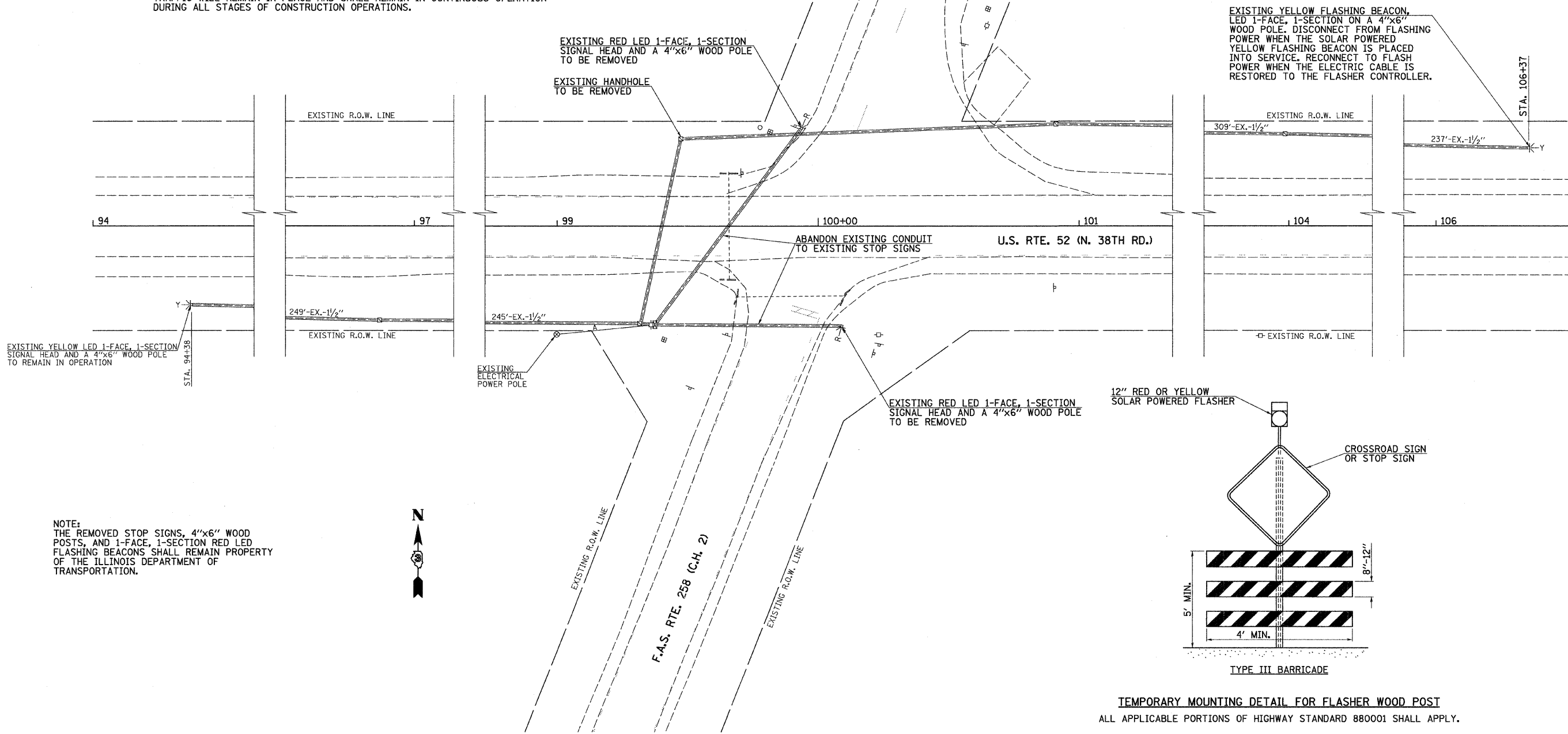

EXISTING YELLOW LED 1-FACE, 1-SECTION SIGNAL HEAD AND A 4"x6" WOOD POLE TO REMAIN IN OPERATION

NOTE:
THE REMOVED STOP SIGNS, 4"x6" WOOD POSTS, AND 1-FACE, 1-SECTION RED LED FLASHING BEACONS SHALL REMAIN PROPERTY OF THE ILLINOIS DEPARTMENT OF TRANSPORTATION.

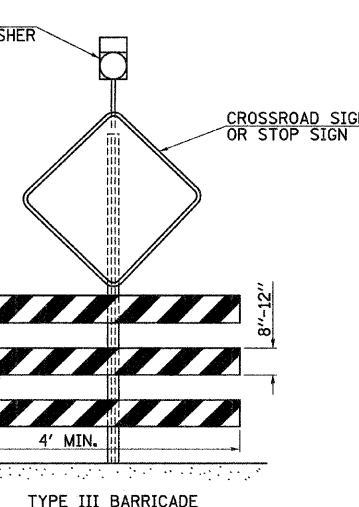

TEMPORARY MOUNTING DETAIL FOR FLASHER WOOD POST
ALL APPLICABLE PORTIONS OF HIGHWAY STANDARD 880001 SHALL APPLY.

FILE NAME = v1\2844\28441001.dgn	USER NAME = bdecrsone	DESIGNED -	REVISED -	STATE OF ILLINOIS DEPARTMENT OF TRANSPORTATION	U.S. RTE. 52 (N. 38TH RD.) & F.A.S. RTE. 258 (C.H. 2) EXISTING FLASHER BEACONS, TEMPORARY FLASHER BEACONS	F.A.S. RTE. 258	SECTION 11-00325-00-SP	COUNTY LA SALLE	TOTAL SHEETS 84	SHEET NO. 45		
PLOT SCALE = 20.0000' / IN.	CHECKED -	REVISED -	SCALE: 1"=20'			SHEET NO. 1 OF 2 SHEETS	STA. 94+38	TO STA. 106+37	ILLINOIS FED. AID PROJECT			
PLOT DATE = 12/22/2011	DATE -	REVISED -										