

Notes:
 See sheet 11 of 23 for Sections C-C & D-D and View E-E.
 $a_4(E)$, $a_5(E)$, $a_6(E)$ and $a_7(E)$ bar spacings measured along C App. Pvmt.
 See Sheet 2 of 23 for offset sketch.

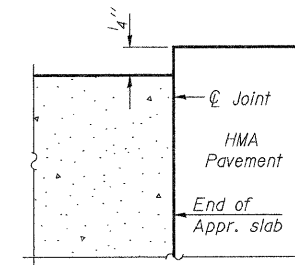
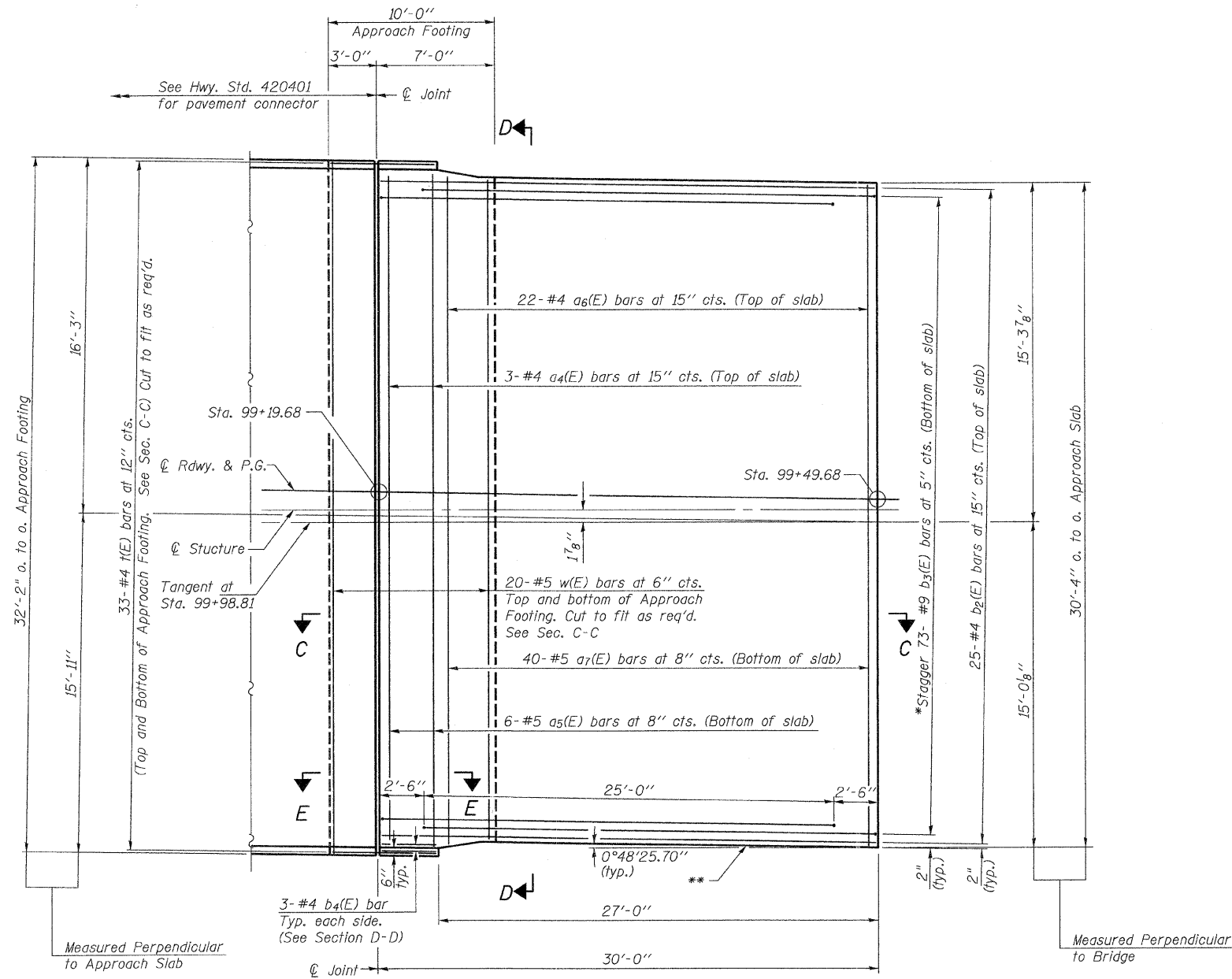

FLEXIBLE PAVEMENT
 DETAIL A

PLAN

* Tilt #9 $b_3(E)$ bars as required to maintain clearance.

** Preformed Flexible Foam Expansion Joint Filler according to Article 1051.09 of the Std. Specifications; full depth of slab, full length of parapet. Typ. each parapet.

DESIGNED	NPH
CHECKED	BAN
DRAWN	RMD
CHECKED	BAN

WEST BRIDGE APPROACH SLAB DETAILS
RIVER RD. (F.A.U. 3799) OVER
BLACKBERRY CREEK
SECTION 08-00036-00-BR
KENDALL COUNTY
STATION 99+98.81

SHEET NO. 10 23 SHEETS	ROUTE NO.	SECTION	COUNTY	TOTAL SHEETS	SHEET NO.
	FAU 3799	08-00036-00-BR	KENDALL	54	31
	SN 047-6500		CONTRACT NO. 87509		
FED. ROAD DIST. NO. 7 ILLINOIS			FED. AID PROJECT BRM-9003(883)		