

DATE _____ BY _____
 SURVEYED _____
 FINAL SURVEY _____
 NOTE BOOK _____
 AREAS CHECKED _____

DATE _____ BY _____
 SURVEYED _____
 ORIGINAL SURVEY _____
 NOTE BOOK _____
 AREAS CHECKED _____

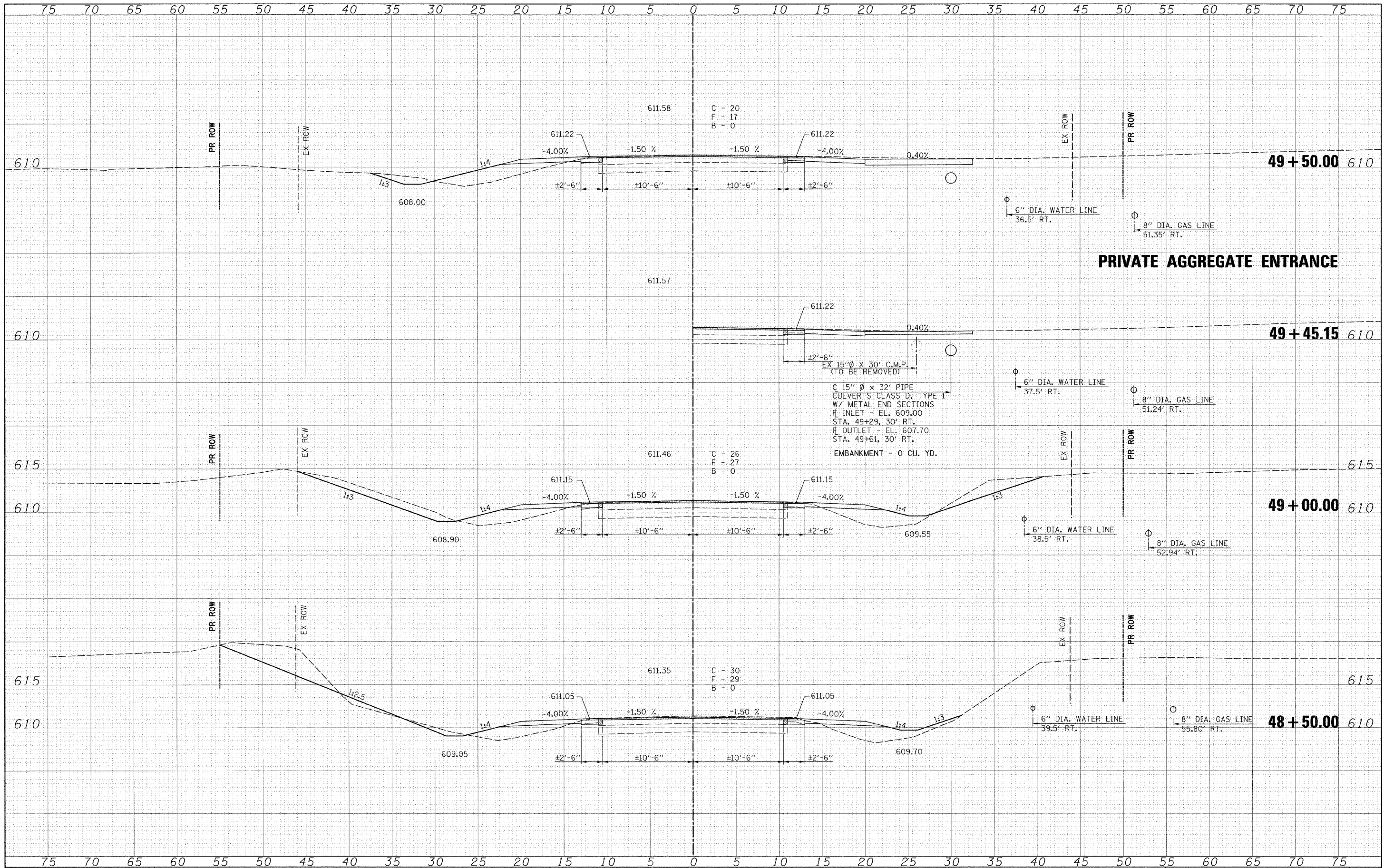

PRIVATE AGGREGATE ENTRANCE

EX 15" Ø X 30' C.M.P.
 (TO BE REMOVED)
 15" Ø X 32' PIPE
 CULVERTS CLASS D, TYPE 1
 W/ METAL END SECTIONS
 INLET - EL. 609.00
 STA. 49+29, 30' RT.
 OUTLET - EL. 607.70
 STA. 49+61, 30' RT.
 EMBANKMENT - 0 CU. YD.

FILE NAME =	USER NAME = #USER#	DESIGNED -	REVISED -	<p>Allen Henderson & Associates, Inc. Civil and Structural Engineers Springfield, IL 62703 Phone: (217)544-8033 IL Design Firm No. 184-001907</p>	CROSS SECTIONS		F.A.S. RTE. 574	SECTION 08-00056-03-PV	COUNTY MENARD	TOTAL SHEETS 52	SHEET NO. 47
#FILE#	PLOT SCALE = #SCALE#	DRAWN -	REVISED -		SCALE: 1" = 5'	SHEET NO. ___ OF ___ SHEETS	STA. 48+50.00 TO STA. 49+50.00	CONTRACT NO. 93558		ILLINOIS FED. AID PROJECT	
	PLOT DATE = #DATE#	CHECKED -	REVISED -								
		DATE -	REVISED -								