

BY	DATE
FINAL SURVEY	
SUPPLEMENTED	
PLOTTED	
NOTE BOOK	
NO.	
AREAS CHECKED	

BY	DATE
OPTIONAL SURVEY	
SUPPLEMENTED	
PLOTTED	
NOTE BOOK	
NO.	
AREAS CHECKED	

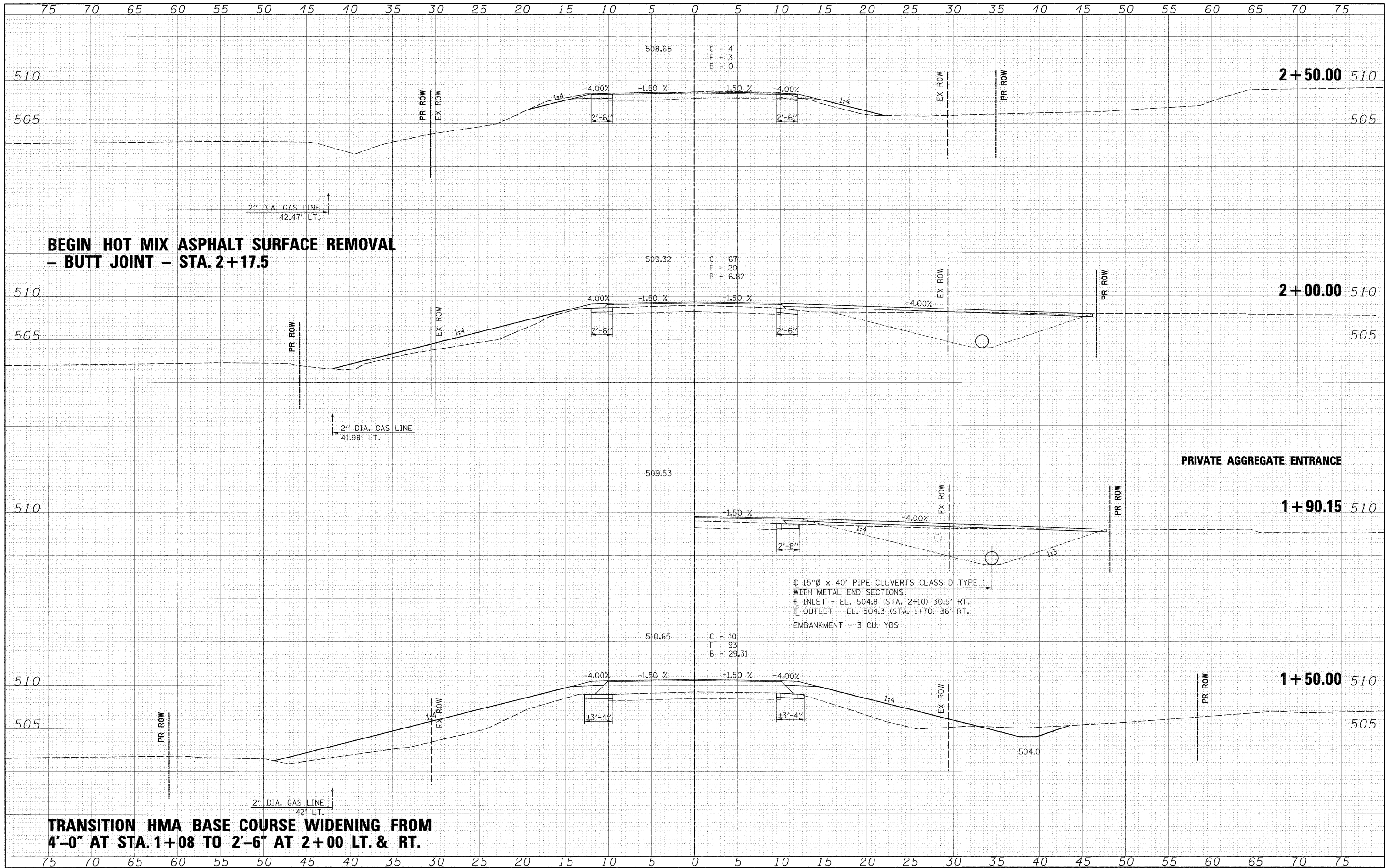

15"Ø x 40' PIPE CULVERTS CLASS D TYPE 1  
 WITH METAL END SECTIONS  
 H INLET - EL. 504.8 (STA. 2+10) 30.5' RT.  
 H OUTLET - EL. 504.3 (STA. 1+70) 36' RT.  
 EMBANKMENT - 3 CU. YDS

**TRANSITION HMA BASE COURSE WIDENING FROM  
 4'-0" AT STA. 1+08 TO 2'-6" AT 2+00 LT. & RT.**

FILE NAME =  
 #FILE#

USER NAME = #USER#  
 PLOT SCALE = #SCALE#  
 PLOT DATE = #DATE#

DESIGNED -  
 DRAWN -  
 CHECKED -  
 DATE -

REVISED -  
 REVISED -  
 REVISED -  
 REVISED -



**Allen Henderson & Associates, Inc.**  
 Civil and Structural Engineers Springfield, IL  
 62703 Phone: (217)544-8033 IL Design Firm  
 No. 184-001907

**CROSS SECTIONS - CHAUTAUQUA ROAD**  
 SCALE: 1" = 5'  
 SHEET NO. OF SHEETS STA. 1+50.00 TO STA. 2+50.00

F.A.S. RTE.	SECTION	COUNTY	TOTAL SHEETS	SHEET NO.
574	08-00056-03-PV	MENARD	52	52
CONTRACT NO. 93558				
FED. ROAD DIST. NO. ILLINOIS FED. AID PROJECT				