

DATE	
BY	
FINAL SURVEY	
PLOTTED	
NOTE BOOK	
AREAS CHECKED	
NO.	

DATE	
BY	
ORIGINAL SURVEY	
PLOTTED	
NOTE BOOK	
AREAS CHECKED	
NO.	

FILE NAME: I:\jobs\christian\count\tr 216 over buckhart creek\cadd\cadd sheets\0607166-sht-xsht.dgn

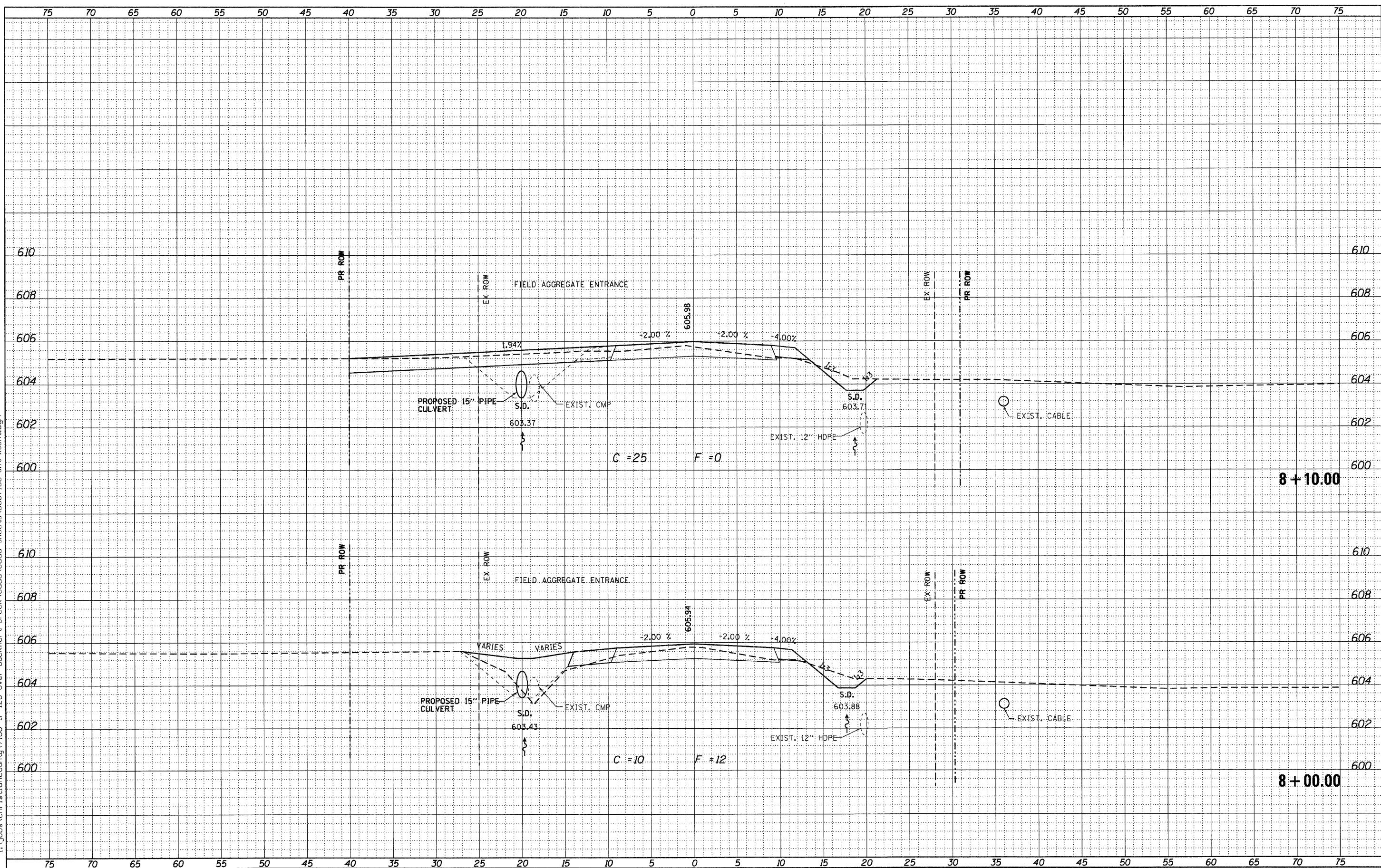

USER NAME = dheber1.rtg	DESIGNED - TJZ	REVISED
PLLOT SCALE = 5.0000" / IN.	CHECKED - SDS	REVISED
PLLOT DATE = 11/14/2011	DATE - 2/22/11	REVISED

**WHKS & CO.**  
ENGINEERING

7018 KINGSMILL CT.,  
SPRINGFIELD, IL  
(217) 483-9457  
DESIGN FIRM #184001036

**STATE OF ILLINOIS**  
**DEPARTMENT OF TRANSPORTATION**

CROSS SECTIONS		TR. RTE.	SECTION	COUNTY	TOTAL SHEETS	SHEET NO.
TR 216 OVER BUCKHART CREEK		216	08-16112-00-BR	CHRISTIAN	26	15
SCALE:	SHEET NO.	OF	SHEETS	STA. 8+00.00	TO STA. 8+10.00	

CONTRACT NO. 93559		ILLINOIS FED. AID PROJECT	
--------------------	--	---------------------------	--