

DATE	
BY	
FINAL SURVEY	
SURVEYED	
PLOTTED	
NOTE BOOK	
AREAS CHECKED	
AREAS CHECKED	
NO.	

DATE	
BY	
ORIGINAL SURVEY	
SURVEYED	
PLOTTED	
NOTE BOOK	
AREAS CHECKED	
AREAS CHECKED	
NO.	

FILENAME: I:\jobs\christiancounty\7166-tr-126-over-buckhart-creek\cadd\cadd sheets\0507166-ent-xasht.dgn

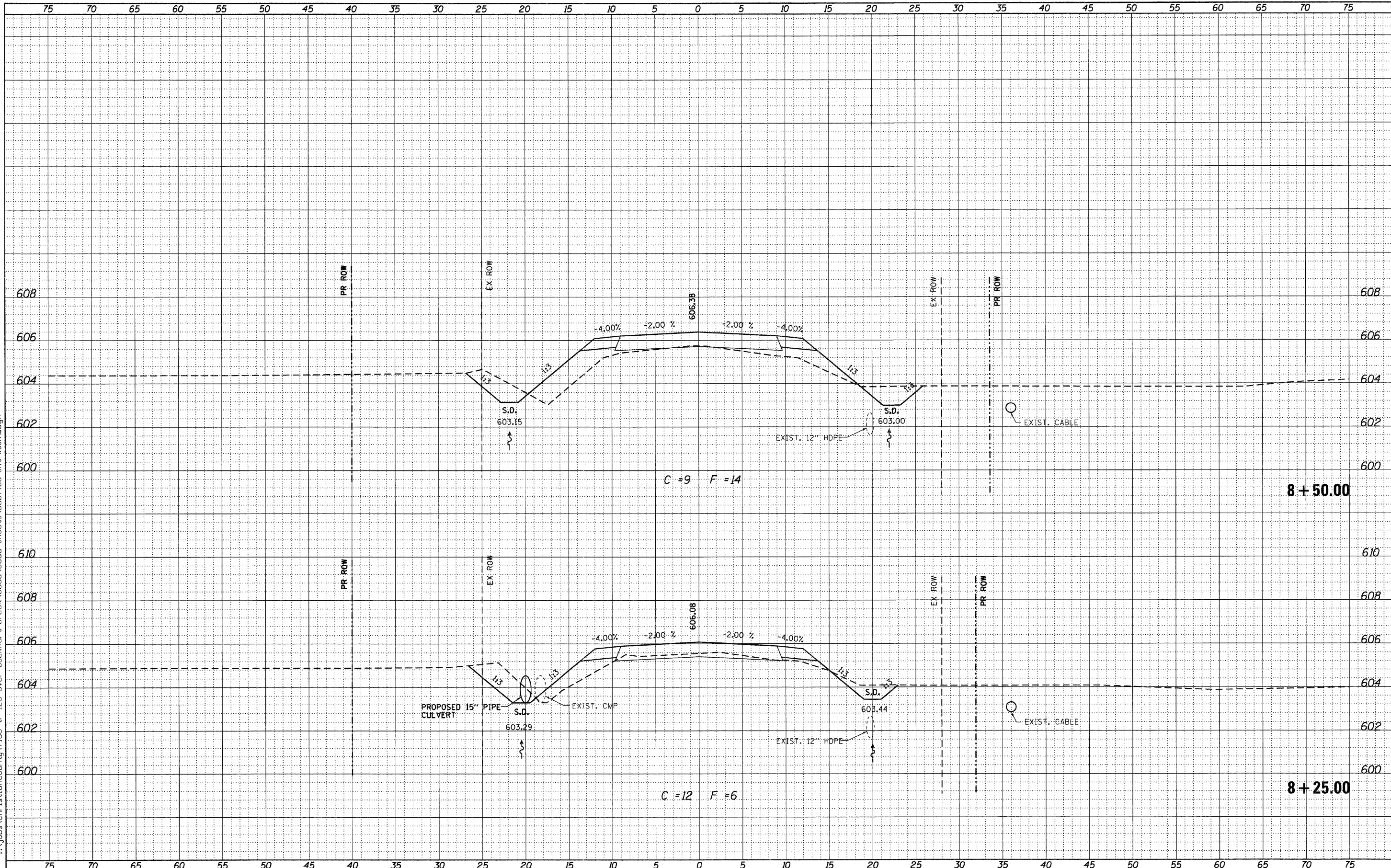

USER NAME = dheberling	DESIGNED - T.J.Z	REVISED
PLOT SCALE = 5.0000 "/td> <td>DRAWN - DLH</td> <td>REVISED</td>	DRAWN - DLH	REVISED
PLOT DATE = 11/14/2011	CHECKED - SDS	REVISED
	DATE - 2/22/11	REVISED

**WHKS & CO.**  
ENGINEERING

7018 KINGSMILL CT.  
SPRINGFIELD, IL  
(217) 483-9457  
DESIGN FIRM #184001036

**STATE OF ILLINOIS**  
**DEPARTMENT OF TRANSPORTATION**

CROSS SECTIONS	
TR 216 OVER BUCKHART CREEK	
SCALE:	SHEET NO. OF SHEETS STA. 8+25.00 TO STA. 8+50.00

TR. RTE.	SECTION	COUNTY	TOTAL SHEETS	SHEET NO.
216	08-16112-00-BR	CHRISTIAN	26	16
CONTRACT NO. 0359				
ILLINOIS FED. AID PROJECT				