

DATE	
BY	
FINAL SURVEY	
PLOTTED	
DATE	
NO. OF SHEETS	
AREAS CHECKED	

DATE	
BY	
ORIGINAL SURVEY	
PLOTTED	
DATE	
NO. OF SHEETS	
AREAS CHECKED	

FILENAME: I:\jobs\chr\is\un\count\7166 tr 26 over buckhart creek\cadd\cadd sheets\0607166-sht-xsh.dgn

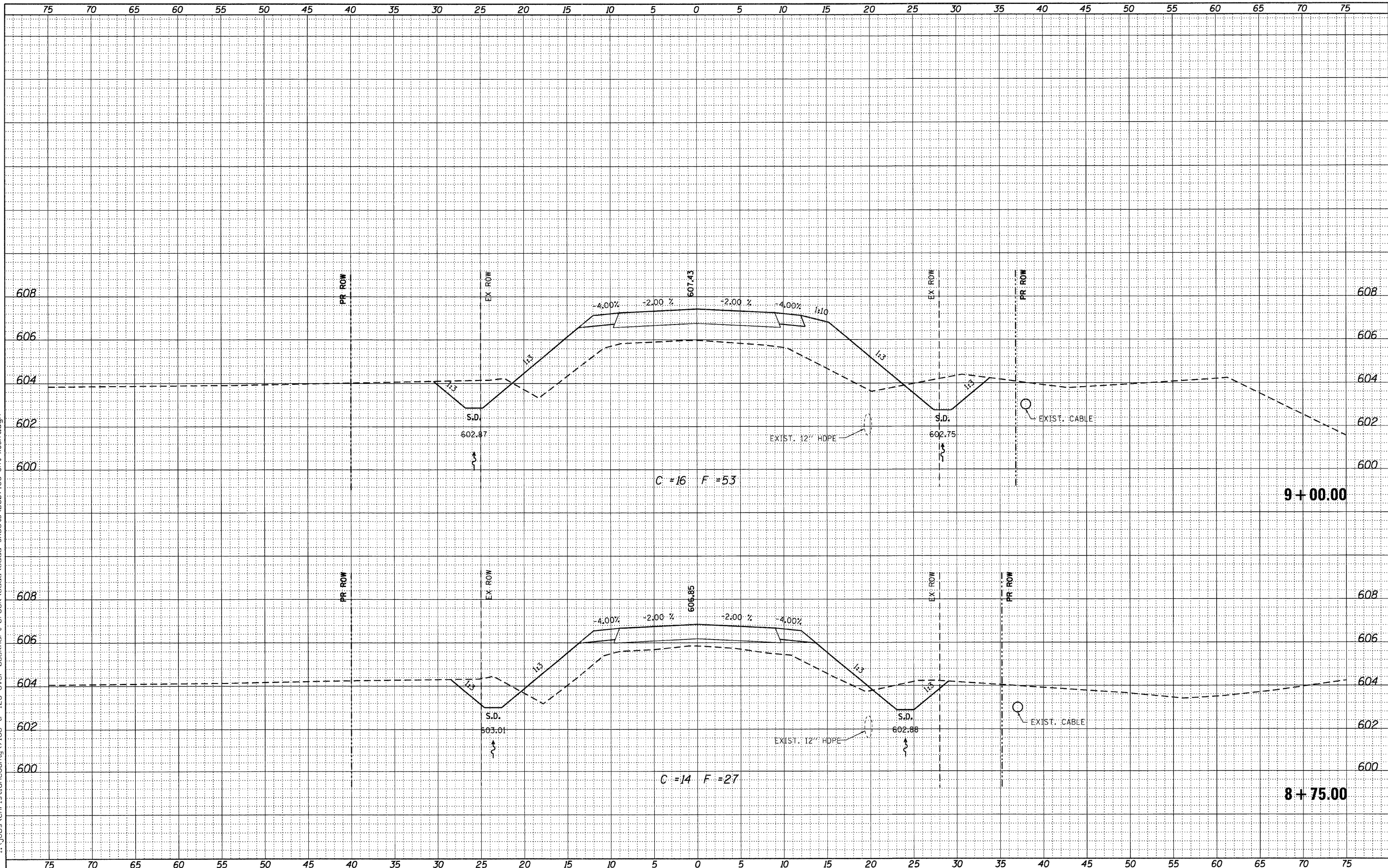

USER NAME = dheber.lmg	DESIGNED - TJZ	REVISED
PLOT SCALE = 5.0000' / IN.	DRAWN - DLH	REVISED
PLOT DATE = 11/14/2011	CHECKED - SDS	REVISED
	DATE - 2/22/11	REVISED

**WHKS & CO.**  
ENGINEERING

7018 KINGSMILL CT.,  
SPRINGFIELD, IL  
(217) 483-9457  
DESIGN FIRM #184001036

**STATE OF ILLINOIS**  
**DEPARTMENT OF TRANSPORTATION**

<b>CROSS SECTIONS</b>	
<b>TR 216 OVER BUCKHART CREEK</b>	
SCALE:	SHEET NO. OF SHEETS STA. 8+75.00 TO STA. 9+00.00

TR. RTE.	SECTION	COUNTY	TOTAL SHEETS	SHEET NO.
216	08-16112-00-BR	CHRISTIAN	26	17
CONTRACT NO. 9359			ILLINOIS FED. AID PROJECT	