

DATE	
BY	
SURVEYED	
PLOTTED	
NOTE BOOK	
AREAS CHECKED	
AREAS CHECKED	

DATE	
BY	
SURVEYED	
PLOTTED	
NOTE BOOK	
AREAS CHECKED	
AREAS CHECKED	

FILENAME: I:\jobs\christiancountyt\7166\tr 216 over buckhart creek\cadd\cadd sheets\0607166-sht-xsh-t.dgn

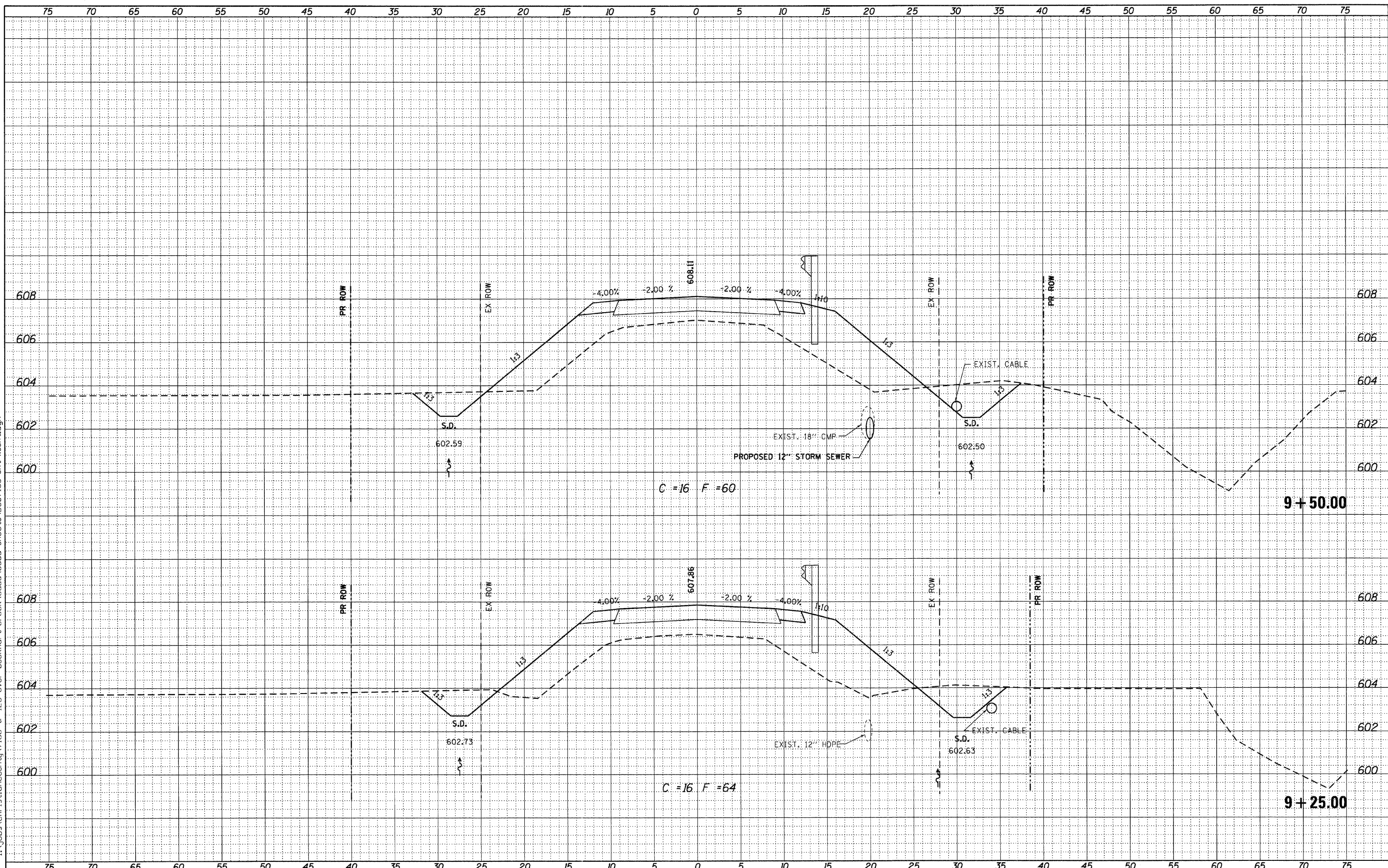

USER NAME = dhaber.ling	DESIGNED - TJZ	REVISED
PLLOT SCALE = 5.0000' / IN.	DRAWN - DLH	REVISED
PLLOT DATE = 11/14/2011	CHECKED - SDS	REVISED
	DATE - 2/22/11	REVISED

WHKS & CO.
ENGINEERING

7018 KINGSMILL CT.,
SPRINGFIELD, IL
(217) 483-9457
DESIGN FIRM #184001036

STATE OF ILLINOIS
DEPARTMENT OF TRANSPORTATION

CROSS SECTIONS
TR 216 OVER BUCKHART CREEK

SCALE: SHEET NO. OF SHEETS STA. 9+25.00 TO STA. 9+50.00

TR. RTE.	SECTION	COUNTY	TOTAL SHEETS	SHEET NO.
216	08-16112-00-BR	CHRISTIAN	26	18
			CONTRACT NO. 93559	
ILLINOIS FED. AID PROJECT				