

DATE	
BY	
FINAL SURVEY	
PLOTTED	
NOTE BOOK	
AREAS CHECKED	
NO.	

DATE	
BY	
ORIGINAL SURVEY	
PLOTTED	
NOTE BOOK	
AREAS CHECKED	
NO.	

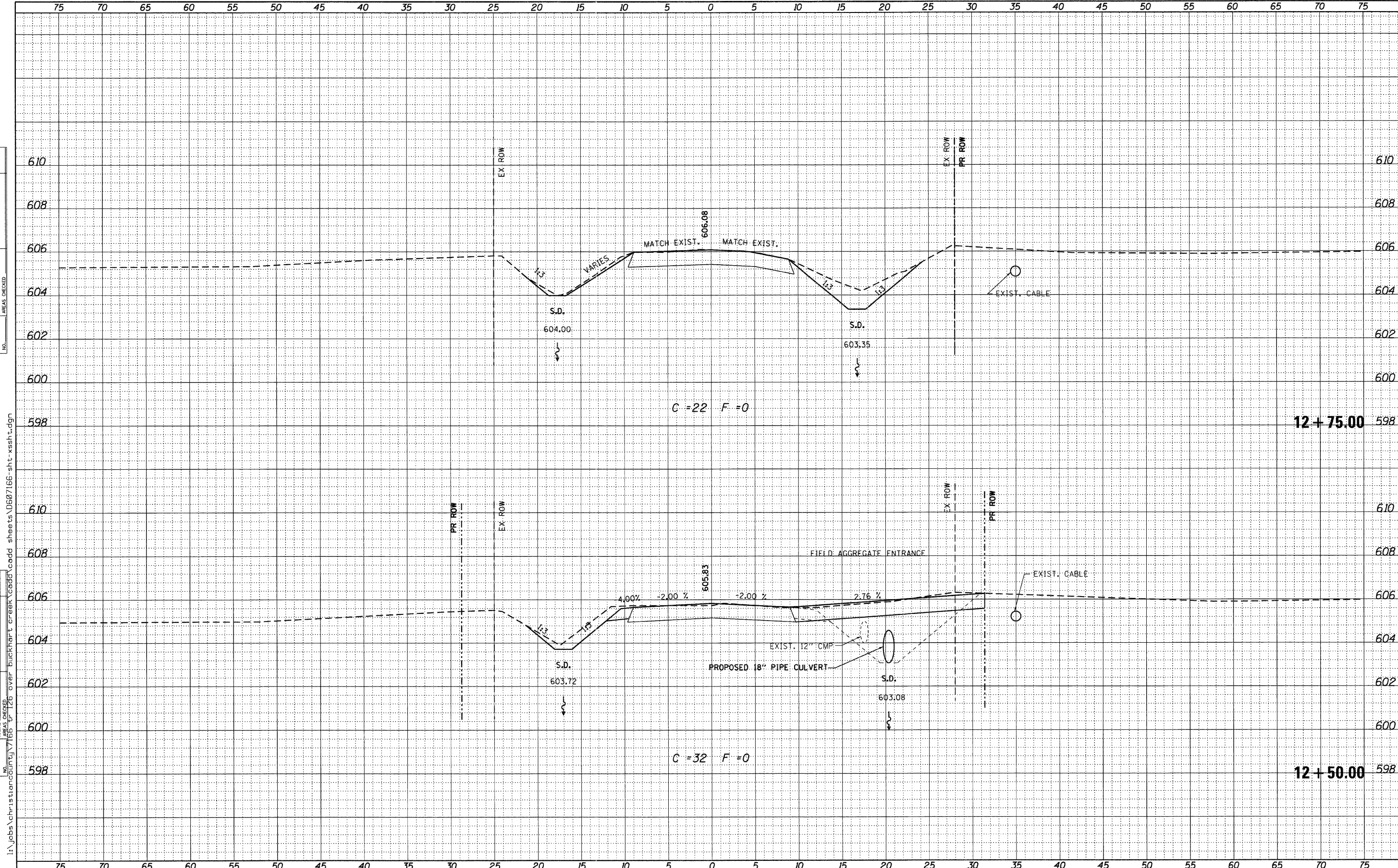

USER NAME = dhaberling	DESIGNED - TJZ	REVISED
	DRAWN - DLH	REVISED
	CHECKED - SDS	REVISED
	DATE - 2/22/11	REVISED

WHKS & CO.
ENGINEERING

7018 KINGSMILL CT.
SPRINGFIELD, IL
(217) 483-9457
DESIGN FIRM #184001036

STATE OF ILLINOIS
DEPARTMENT OF TRANSPORTATION

CROSS SECTIONS	
TR 216 OVER BUCKHART CREEK	
SCALE:	SHEET NO. OF SHEETS STA. 12+50.00 TO STA. 12+75.00

TR. RTE.	SECTION	COUNTY	TOTAL SHEETS	SHEET NO.
216	08-16112-00-BR	CHRISTIAN	26	25
				CONTRACT NO. 93559
ILLINOIS FED. AID PROJECT				

FILE NAME: I:\jobs\christian\creek\tr 216 over buckhart creek\cadd\cadd sheets\DS07166-sht-xasht.dgn