

FINAL SURVEY	SURVEYED	BY	DATE
NOTE BOOK	PLOTTED		
NO.	TEMPLATE		
	AREAS CHECKED		

ORIGINAL SURVEY	SURVEYED	BY	DATE
NOTE BOOK	PLOTTED		
NO.	TEMPLATE		
	AREAS CHECKED		

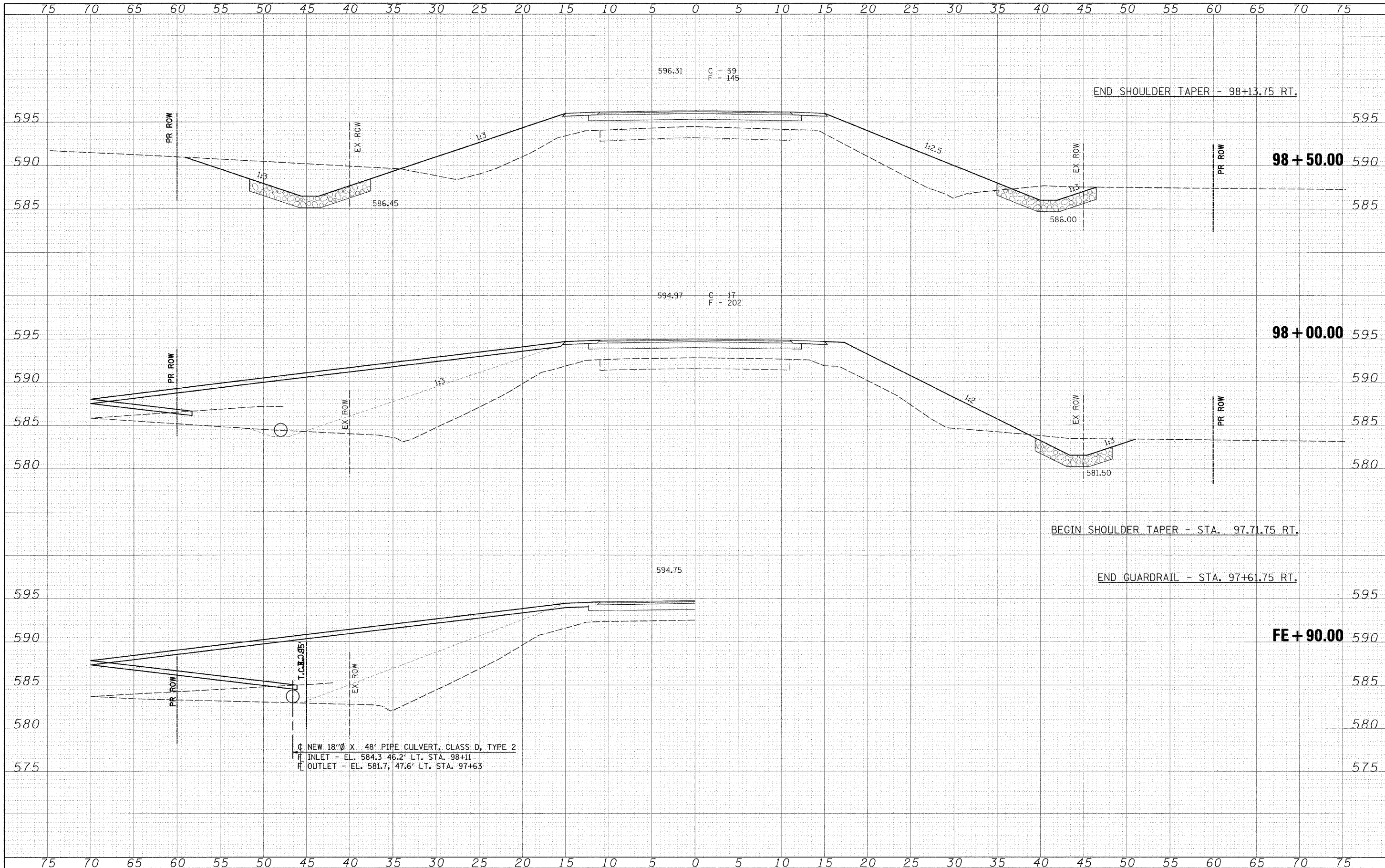

C NEW 18"Ø X 48' PIPE CULVERT, CLASS D, TYPE 2  
 R INLET - EL. 584.3 46.2' LT. STA. 98+11  
 R OUTLET - EL. 581.7, 47.6' LT. STA. 97+63

FILE NAME =  
 #FILE#

USER NAME = #USER#  
 PLOT SCALE = #SCALE#  
 PLOT DATE = #DATE#

DESIGNED -  
 DRAWN -  
 CHECKED -  
 DATE -

REVISED -  
 REVISED -  
 REVISED -  
 REVISED -



**Allen Henderson & Associates, Inc.**  
 Civil and Structural Engineers Springfield, IL.  
 62703 Phone: (217)544-8033 IL Design Firm  
 No. 184-001907

**CROSS SECTIONS**

SCALE: 1" = 5'      SHEET NO. 6 OF 7 SHEETS      STA. 97+90 TO STA. 98+50

F.A.S. RTE.	SECTION	COUNTY	TOTAL SHEETS	SHEET NO.
733	06-00088-00-BR	MACOUPIN	35	34
CONTRACT NO. 93562				
FED. ROAD DIST. NO. ILLINOIS FED. AID PROJECT				