

FINAL SURVEYED BY DATE
 SURVEY NO. PROJECT NO.
 NOTE BOOK NO. TEMPLATE NO.
 AREAS AREAS CHECKED

ORIGINAL SURVEYED BY DATE
 SURVEY NO. PROJECT NO.
 NOTE BOOK NO. TEMPLATE NO.
 AREAS AREAS CHECKED

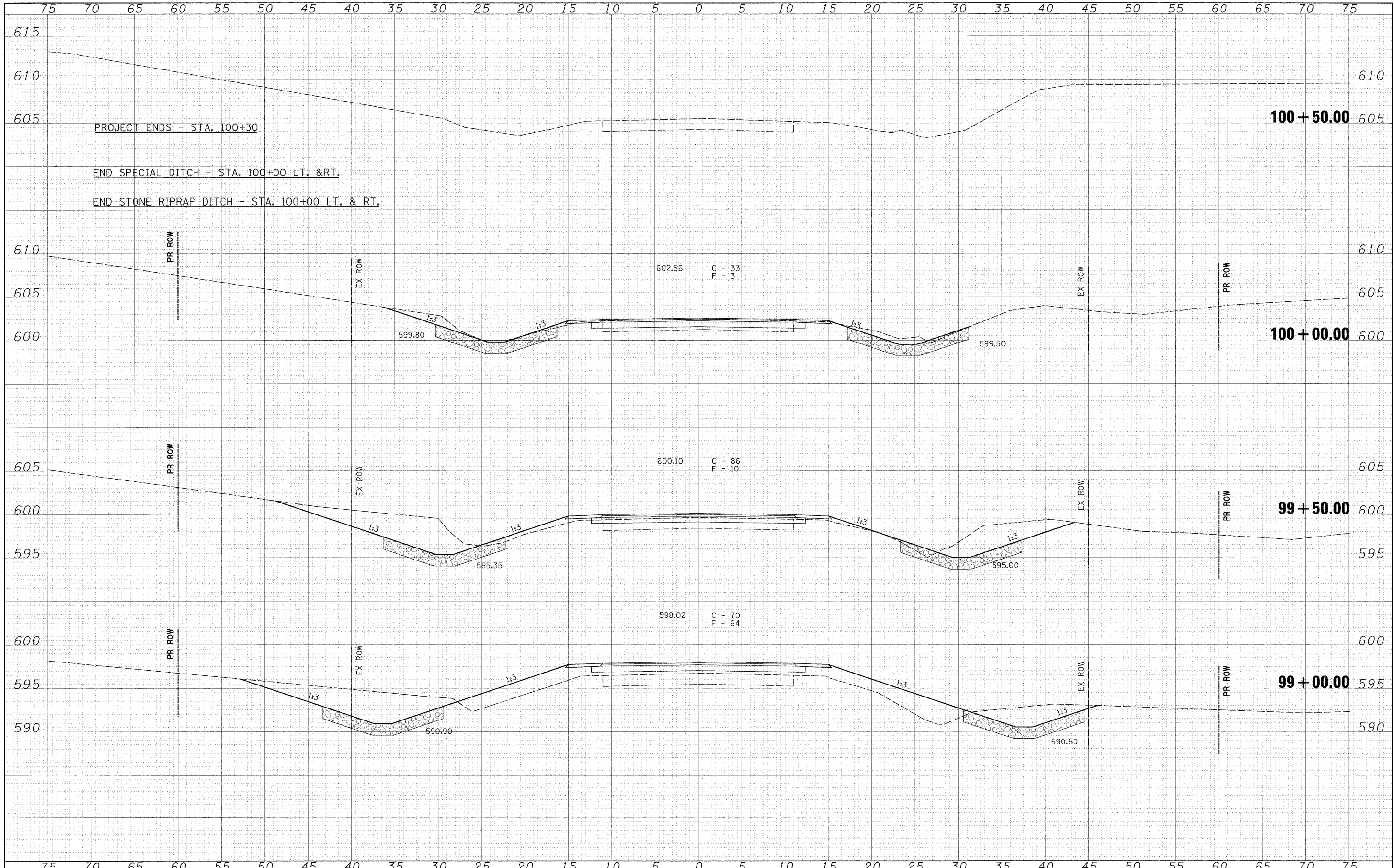

FILE NAME =
 #FILE#

USER NAME = #USER#
 PLOT SCALE = #SCALE#
 PLOT DATE = #DATE#

DESIGNED -
 DRAWN -
 CHECKED -
 DATE -

REVISED -
 REVISED -
 REVISED -
 REVISED -



Allen Henderson & Associates, Inc.
 Civil and Structural Engineers Springfield, IL.
 62703 Phone: (217)544-8033 IL. Design Firm
 No. 184-001907

CROSS SECTIONS
 SCALE: 1" = 5'
 SHEET NO. 7 OF 7 SHEETS
 STA. 99+00 TO STA. 100+50

F.A.S. RTE. 733	SECTION 06-00088-00-BR	COUNTY MACOUPIN	TOTAL SHEETS 35	SHEET NO. 35
FED. ROAD DIST. NO. ILLINOIS FED. AID PROJECT			CONTRACT NO. 98562	