

STATE ST (CH 13)

57+00

MONROE ST (FAU 8244)

56+00

KIRKHAM STREET (FAU 8253)

FIRST NATIONAL BANK OF LITCHFIELD
324 N. STATE ST.

LITCHFIELD NATIONAL BANK
316 N. STATE ST.

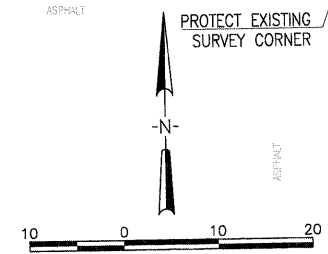

DEMOLITION LEGEND

1 REMOVAL OF POLE FOUNDATION	9 FIRE HYDRANT TO BE MOVED*	16 DOMESTIC METER VAULT TO BE ADJUSTED	[Hatched Pattern] COMB CURB & GUTTER REMOVAL (FOOT)
2 REMOVAL OF LIGHTING UNIT (BY OTHERS)	10 ADJUST MONITORING WELL	17 REMOVE EXISTING PLANTER (INCIDENTAL TO SIDEWALK REMOVAL)	[Hatched Pattern] CURB REMOVAL (FOOT)
3 REMOVE SIGN ASSEMBLY	11 TELEPHONE SPLICE BOX TO BE ADJUSTED (BY OTHERS)	18 POWER POLE TO BE REMOVED (BY OTHERS)	[Cross-hatched Pattern] SIDEWALK REMOVAL (SQ FT)
4 REMOVE INLET	12 FILLING EXISTING WINDOW WELL	19 REMOVE SIGN COMPLETE	[Diagonal Hatched Pattern] PAVEMENT REMOVAL (SQ YD)
5 REMOVING INLET TO MAINTAIN FLOW	13 EXISTING BASEMENT VAULT TO BE FILLED	20 INSTALL INLET FILTER	[Dotted Pattern] DRIVEWAY PAVEMENT REMOVAL (SQ YD)
6 VALVE BOX TO BE ADJUSTED	14 REMOVE AND RELOCATE FLAGPOLE*		[Pattern with + signs] EARTH EXCAVATION (CU YD)
7 HANDHOLE TO BE ADJUSTED	15 REMOVE ORNAMENTAL LIGHTING (INCIDENTAL TO DEMOLITION)		
8 FRAME AND LID TO BE ADJUSTED			

*SEE PROPOSED PLAN SHEETS FOR NEW LOCATION

NOV 26, 2011 2:31 PM DFORGY I:\JOBS\0711101 LITCHFIELD STREETSCAPE\CAO\DEM_SHEETS.DWG