

NORTH MADISON STREET DEMOLITION DETAIL—SOUTH SECTION
SCALE: 1"=20'-0"

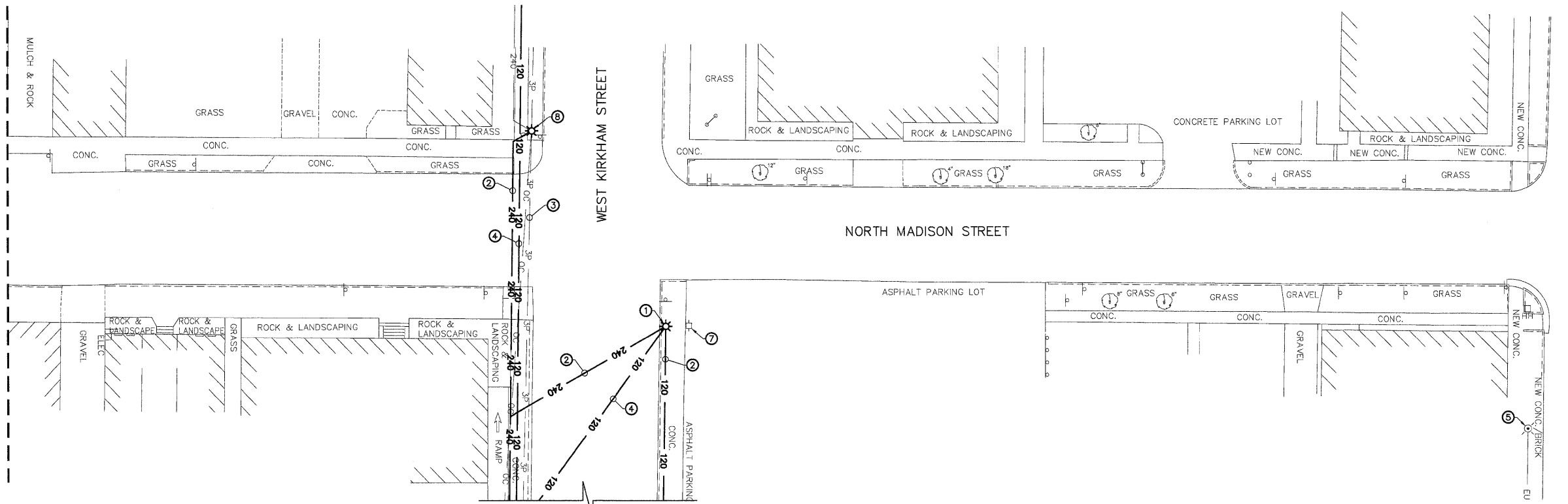

NORTH MADISON STREET DEMOLITION DETAIL—NORTH SECTION
SCALE: 1"=20'-0"

- GENERAL NOTES:**
1. ALL WORK TO BE COMPLETED BY ELECTRICAL CONTRACTOR UNLESS NOTED OTHERWISE.
 2. REFER TO CIVIL DRAWINGS FOR LIMITS OF EXISTING CONCRETE SIDEWALK REMOVAL (BY GENERAL CONTRACTOR).
 3. EXISTING STREET LIGHTING SHALL REMAIN FUNCTIONAL DURING INSTALLATION OF NEW LIGHT POLES. COORDINATE REMOVAL OF EXISTING STREET LIGHTS, POLES AND FOUNDATIONS WITH AMEREN UPON COMPLETION OF WORK. EXISTING STREET LIGHTS AND POLES ARE OWNED AND TO BE REMOVED BY AMEREN.
 4. EXISTING UNDERGROUND UTILITIES ARE PLOTTED FROM AVAILABLE INFORMATION AND ARE ONLY APPROXIMATE. ADDITIONAL UTILITIES MAY BE ENCOUNTERED DURING EXCAVATION. EXACT LOCATIONS SHALL BE DETERMINED BY THE CONTRACTOR BEFORE CONSTRUCTION IS STARTED. CONTACT J.U.L.I.E. (1-800-892-0123) 48 HOURS PRIOR TO DIGGING.

- DEMOLITION KEYED NOTES:**
- ① EXISTING LIGHT FIXTURE AND POLE TO BE REMOVED BY AMEREN. FOUNDATION TO BE REMOVED BY GENERAL CONTRACTOR.
 - ② EXISTING 240V STREET LIGHT CONDUCTORS TO BE REMOVED BY AMEREN.
 - ③ EXISTING OVERHEAD PRIMARY CONDUCTORS TO REMAIN.
 - ④ EXISTING 120V RECEPTACLE CONDUCTORS TO BE REMOVED.
 - ⑤ EXISTING LANDSCAPE LIGHT POLE TO BE REMOVED AND TURNED OVER TO THE PROPERTY OWNER. EXISTING POWER CIRCUITRY SHALL BE TERMINATED IN THE BUILDING AND ABANDONED IN PLACE.
 - ⑥ EXISTING SERVICE CONDUCTORS TO BE REMOVED BY AMEREN.
 - ⑦ EXISTING UTILITY POLE TO BE REMOVED BY AMEREN.
 - ⑧ EXISTING LIGHT FIXTURE TO BE REMOVED BY AMEREN. EXISTING UTILITY POLE TO REMAIN.
 - ⑨ EXISTING WEATHERHEAD AND CONDUIT TO BE REMOVED. EXISTING METER CABINET TO REMAIN. PROVIDE CLOSURE FITTING ON TOP OF METER CABINET.

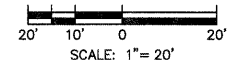

NOV 28, 2011 3:39 PM MCDONOUGH ZA111-059A.DRAWINGS\E1.4.DWG

McDonough-Whitlow, P.C.
Consulting Engineers & Land Surveyors
138 East Wood Street
Hillboro, IL 62049
Phone: 217.532.9233
Fax: 217.532.4330

DRAWING DATE	10/14/11	REVISION		BY	DATE
DESIGNED BY	MJF				
DRAWN BY	GDG				
CHECKED BY	GWW				

STATE OF ILLINOIS
DEPARTMENT OF TRANSPORTATION

**ENLARGED ELECTRICAL DEMOLITION
DETAILS**

PROJECT NO.	11-095	F.A.U. RTE.	SECTION	COUNTY	TOTAL SHEETS	SHEET NO.
FILENAME	E1.4.dwg		10-00035-00-LS	Montgomery	92	77
DRAWING SCALE	1"=20'				CONTRACT NO.	93563
		FED. ROAD DIST. NO.	ILLINOIS	FED. AID PROJECT		