

PLAN	SURVEYED	DATE
	ALIGNED	BY
	PLOTTED	DATE
	CHECKED	BY
	BY	DATE
	NO.	
	NO.	
	NO.	

PROFILE	SURVEYED	DATE
	PLOTTED	BY
	CHECKED	DATE
	BY	
	NO.	
	NO.	
	NO.	

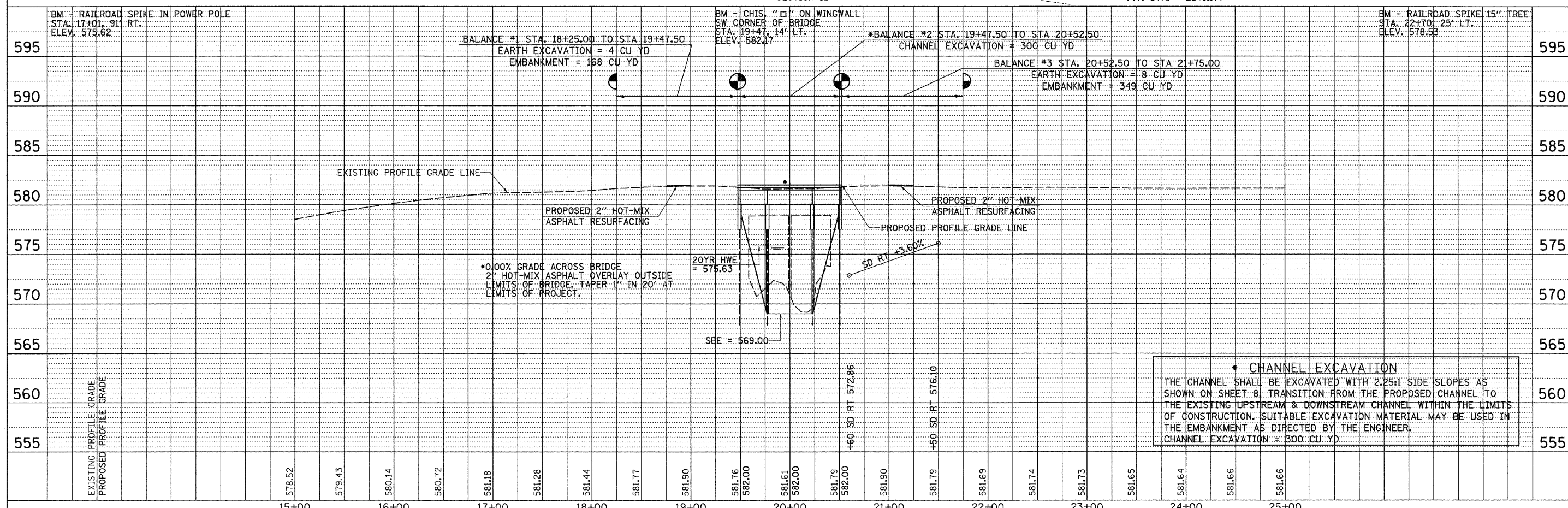

FILE NAME = V:\Bridge\3863-Pike\3863P001.dgn	USER NAME = jhurthson	DESIGNED -	REVISED -	PIKE COUNTY COUNTY HIGHWAY 4 OVER NORTH FORK HADLEY CREEK	PLAN AND PROFILE				F.A.S. RTE. 596	SECTION 11-00089-00-BR	COUNTY PIKE	TOTAL SHEETS 28	SHEET NO. 7
	PLOT SCALE = 50.0000' / IN.	CHECKED -	REVISED -		SCALE: 1"=50'	SHEET NO. 1 OF 1 SHEETS	STA. 18+25.00 TO STA. 21+75.00	FED. ROAD DIST. NO. 7	ILLINOIS	FED. AID PROJECT BRS-0596(105)	CONTRACT NO. 99564		
	PLOT DATE = 12/27/2011	DATE -	REVISED -										