

STATE OF ILLINOIS
DEPARTMENT OF PUBLIC WORKS & BUILDINGS
DIVISION OF HIGHWAYS

| | | | | |
|-----------|---------|-----------|--------------|-----------|
| ROUTE NO. | SECTION | COUNTY | TOTAL SHEETS | SHEET NO. |
| 596 | 21 B | PIKE | 14 | 9 |
| FILE NO. | | 3-100 (3) | | |

B.M. Top R.O.W. Marker 25' E of Sta. 157117 (Case No. 99)
Existing Structure Concrete Thru Girder Span @ 39.6' Concrete Abutments
Contractor shall remove existing structure before building new bridge. No Salvage.

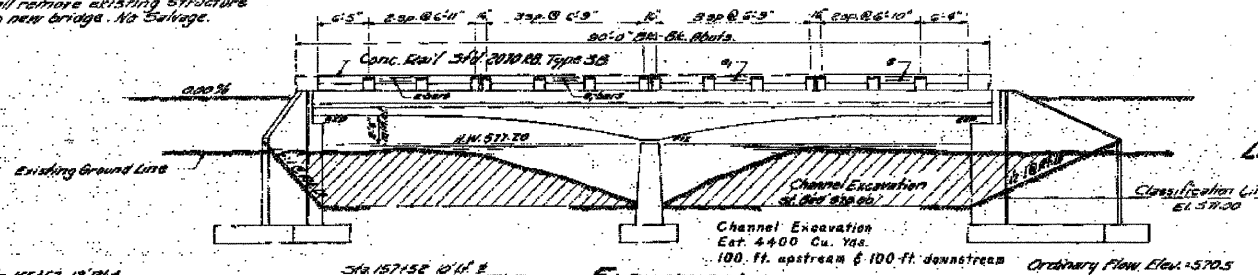

Station 157117
BUILT 185
I.A.S. RT. 596 SEC. 21 B
I.A.S. PROJ. 5-100 (3)
LANSING 115-312

LETTERING FOR NAME PLATE
See Sta. 213

GENERAL NOTES
Class I Concrete shall be used throughout except in handrails and pier.
Class II Concrete shall be used in piers.
Handrail concrete shall be used in handrails.
The concrete floor slab shall be finished in accordance with Article 51.11(6) of the Standard Specifications.
The handrail concrete in Rail Posts & Chairs shall be poured in separate operations.
Seaming plates, lead plates and anchor bolts shall be fastened and set in accordance with Article 51.11 of the Standard Specifications and are included for payment as structural steel.
Except as otherwise provided, all structural steel shall receive one shop coat of red lead paint and two field coats of aluminum paint See Article 52.1 of the Standard Specifications.
All cement shall be furnished and applied by the Contractor.
The following surfaces of the bridge shall be waterproofed: back of abutment from top of footing to top of abutment & back of wingwalls from top of footing to one foot below top of wingwalls. Waterproofing shall be done in accordance with Article 51.6 of the Standard Specifications.

Sta. 157117 12' E of
El. of Ground 575.5
Loose brown sand & gravel
Gravel in fill, limestone shale
outwash, medium and fine
sand
570.0
Flow Line
570.0
555.5
553.0
553.0
Medium brown sand & gravel
limestone gravel fill

Sta. 157156 10' E of
El. of Ground 576.5
Loose brown sand & gravel
Gravel in fill, limestone shale
outwash with several large pieces
571.0
559.0
555.5
555.5
Medium White Stone Sand
Limestone

ELEVATION
WATERWAY INFORMATION
Drainage Area..... 6.32 Sq. Mi.
Character..... hilly
Rapid Opening (sur. load)..... 500 Sq. Ft.
Frequent Opening..... 200 Sq. Ft.
Proposed Opening..... 300 Sq. Ft.

DESIGN STRESSES
f_c = 1000 p.s.i. (Comp.)
f_s = 8000 p.s.i. (Steel)
f_s = 20000 p.s.i. (Rein.)
f_s = 18,000 p.s.i. (Struct.)
n = 10

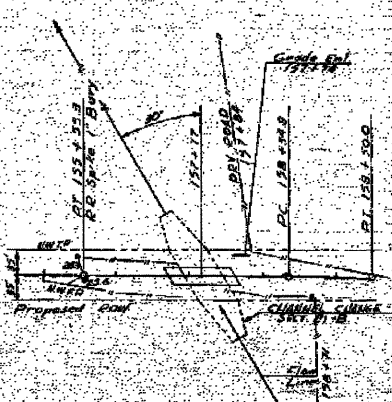
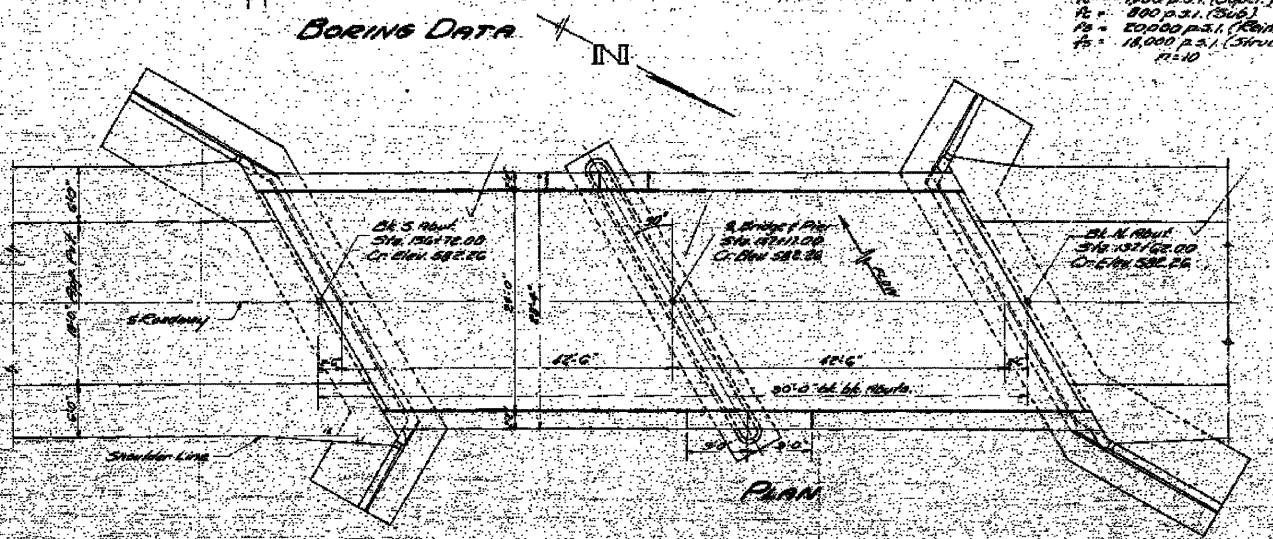
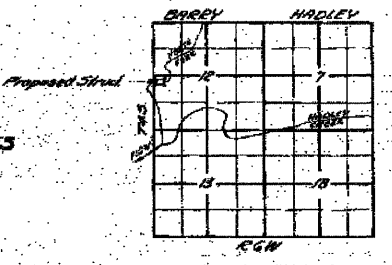

TOTAL BILL OF MATERIAL

| Item | Unit | Quantity | Subtotal | Total |
|--------------------------------|--------|----------|----------|--------|
| Class I Concrete | Cu Yds | 106.2 | 154.01 | 154.01 |
| Class II Concrete | Cu Yds | 58.7 | 58.7 | 58.7 |
| Handrail Concrete | Cu Yds | 4.5 | 4.5 | 4.5 |
| Reinforcement Bars | Lbs | 30860 | 14452 | 14910 |
| Structural Steel | Lbs | 3180 | 3480 | 3480 |
| Welding Rods | Each | 1 | 1 | 1 |
| Class II Cement for Structures | Cu Yds | 210 | 210 | 210 |
| Class II Cement for Structures | Cu Yds | 382 | 382 | 382 |
| Channel Excavation | Cu Yds | 4400 | 4400 | 4400 |
| Rock Excavation for Structure | Cu Yds | 50 | 50 | 50 |
| Removal of Exist. Structures | Each | 1 | 1 | 1 |

DESIGNED: [Signature]
CHECKED: [Signature]
DRAWN: [Signature]
APPROVED: [Signature]

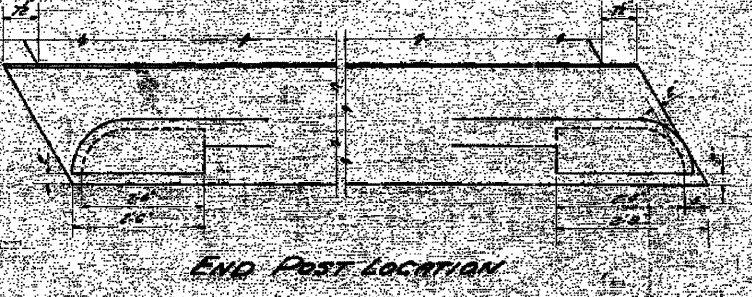

I.A.S. PROJ. 5-100 (3)
I.A.S. RT. 596 SEC. 21 B
BRIDGE OVER
NORTH FORK OF HADLEY CREEK
PIKE COUNTY
STA. 157117

EXISTING STRUCTURE PLANS
PIKE COUNTY
SECTION 11-00089-00-BR
C.H. 4 OVER NORTH FORK HADLEY CREEK

| | | | | | |
|--------------------------------|-------------------|---------------------------|--------------------------------|--------------------|-----------------|
| SHEET NO. 12 17 SHEETS | ROUTE NO. CH 4 | SECTION 11-00089-00-BR | COUNTY PIKE | TOTAL SHEETS 28 | SHEET NO. 19 |
| | S.N. 075-3324 | | CONTRACT NO. 93564 | | |
| FED. ROAD DIST. NO. 7 ILLINOIS | | | FED. AID PROJECT BRS-0596(105) | | |