

INT.	DATE	REASON

PROP. CURVE REL2
PI STA. 2244+20.15
 $\Delta = 5^\circ 59' 53''$ (LT)
 $D = 1^\circ 30' 00''$
 $R = 3,819.72'$
 $T = 200.12'$
 $L = 399.87'$
 $E = 5.24'$
TRANSITION LENGTH = 186'
BEGIN SE. TRANSITION AT STA. 2240+83
BEGIN FULL SE. AT. STA. 2242+69
END FULL SE. AT STA. 2245+71
END SE TRANSITION AT STA. 2247+63
SE. = 0.028'/FT.
PC STA. 2242+20.03
PT STA. 2246+19.90

F.A.P. RTE.	SECTION	COUNTY	TOTAL SHEETS	SHEET NO.
95	.	JASPER	546	74
STA. 2240+00.00 TO STA. 2245+00.00		ILLINOIS		FED. AID PROJECT
*15,61Y,RS-2,6BR-7		CONTRACT NO. 94437		

LEGEND

- PATCHING
- TRENCH BACKFILL
- CONSTRUCTION LIMITS
- TREE TO BE REMOVED
- HORIZONTAL CONTROL STATION

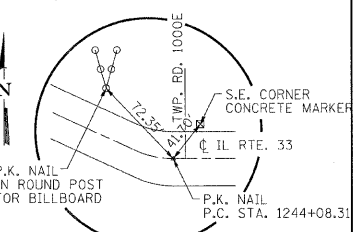
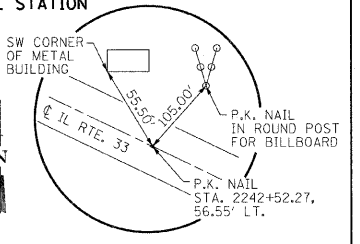

SCALE IN FEET

PLAN	SURVEYED	DATE

PLOTS & CHECKS	DATE	REASON

PROFILE	SURVEYED	DATE

CHECKS	DATE	REASON

REVISION	DATE	BY

COMPUTER FILE NO. PLAN18-3.DGN
PROJECT: 01256
2/26/10-FAV



GREENE & BRADFORD, INC.
OF SPRINGFIELD, ILLINOIS
CONSULTING ENGINEERS
REGISTERED PROFESSIONAL ENGINEERS
ILLINOIS LICENSE NO. 042-12585-01
2017 783 8444, 1851 7315 3227 F.L.E. No. 0128991
www.greenebradford.com

B.M. #25 : STA. 2240+66, 71' RT.
NAIL "30 D" IN PP
ELEV. 554.21

B.M. #26 : STA. 2244+08, 82'-RT.
SURVEY MONUMENT
ELEV. 552.99

