

DESIGN		
INT.	DATE	REASON

PLOTS & CHECKS			
INT.	DATE	NO.	REASON

CHECKS		
INT.	DATE	REASON

REVISIONS		
NAME	DATE	

F.A.P. RTE.	SECTION	COUNTY	TOTAL SHEETS	SHEET NO.
95		JASPER	546	102
STA. 925+00.00		TO STA. 955+00.00		
FED. ROAD DIST. NO.		ILLINOIS	FED. AID PROJECT	
*(5,6)Y,RS-2,6BR-7		CONTRACT NO. 94437		

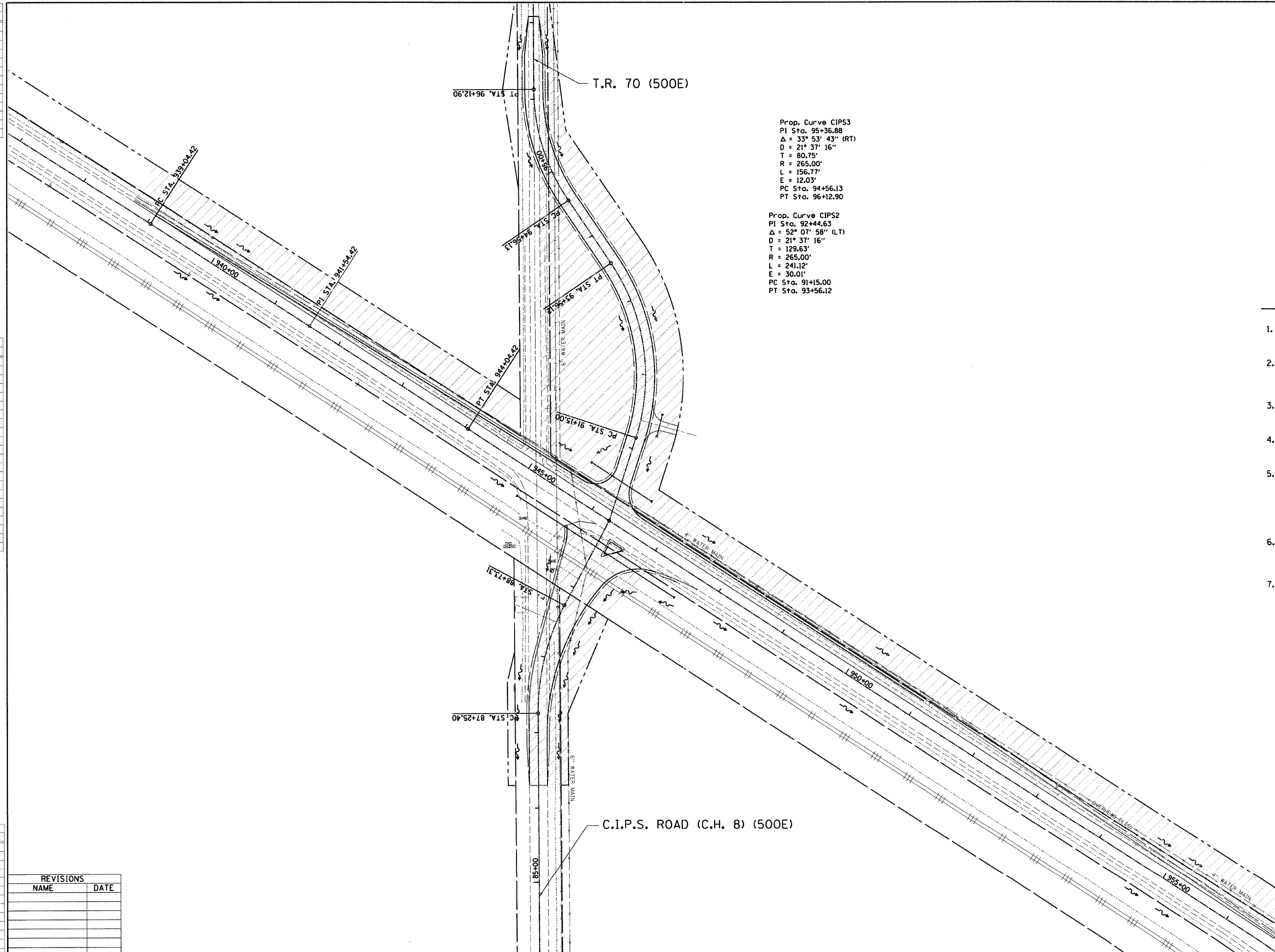
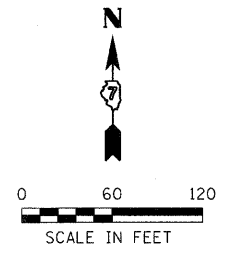

Prop. Curve CIPS3
 PI Sta. 95+36.88
 $\Delta = 33^\circ 53' 43''$ (RT)
 $D = 21^\circ 37' 16''$
 $T = 80.75'$
 $R = 265.00'$
 $L = 156.77'$
 $E = 12.03'$
 PC Sta. 94+56.13
 PT Sta. 96+12.90

Prop. Curve CIPS2
 PI Sta. 92+44.63
 $\Delta = 52^\circ 07' 58''$ (LT)
 $D = 21^\circ 37' 16''$
 $T = 129.63'$
 $R = 265.00'$
 $L = 241.12'$
 $E = 30.01'$
 PC Sta. 91+15.00
 PT Sta. 93+56.12

STAGE 1

1. TRAFFIC WILL REMAIN ON THE EXISTING PAVEMENT ON ILLINOIS ROUTE 33 AND C.I.P.S. ROAD.
2. CONTRACTOR SHALL PLACE ALL ADVANCED WARNING SIGNAGE PRIOR TO BEGINNING ANY CONSTRUCTION. (SEE STANDARD 701326 AND 701201).
3. THE CONTRACTOR SHALL MILL EXISTING PAVEMENT UNDER TRAFFIC WITH THE USE OF FLAGGERS.
4. CONTRACTOR SHALL PROVIDE AND MAINTAIN TEMPORARY ENTRANCES WHERE REQUIRED DURING CONSTRUCTION.
5. CONSTRUCT THE PAVEMENT WIDENING, HOT-MIX ASPHALT SHOULDERS AND DITCHES ALONG THE NORTH SIDE OF ILLINOIS ROUTE 33. THE INTERSECTION WITH ILLINOIS ROUTE 33 AND C.I.P.S. ROAD WILL NOT BE DISTURBED DURING THIS STAGE.
6. CONSTRUCT THE NEW PAVEMENT, PAVEMENT WIDENING, DITCHES AND DRAINAGE STRUCTURES AS SHOWN IN THE PLANS OF C.I.P.S. ROAD.
7. CONSTRUCT SEEDING, MULCH AND TEMPORARY EROSION CONTROL.

LEGEND

- WORK ZONE
- DIRECTION OF TRAFFIC
- TYPE III BARRICADE AS PER STD. 701901

ILLINOIS DEPARTMENT OF TRANSPORTATION
STAGE 1 CONSTRUCTION PLAN OVERVIEW
C.I.P.S. ROAD CONSTRUCTION

FAP ROUTE 95 (IL RTE. 33)
 SECTION (5,6)Y,RS-2,6BR-7
 JASPER COUNTY

SCALE: VERT. _____
 HORIZ. _____
 DATE: 04/15/03

DRAWN BY: BISHOP
 DESIGNED BY: COLBROOK
 CHECKED BY: COLBROOK

GREENE & BRADFORD, INC.
OF SPRINGFIELD

COMPUTER FILE NO.
 STAGE-02 - 60
 PROJECT 01256
 2/26/10-FAV